



9 The Avenue, NW6

TO LET - £3,100

AVAILABLE TO LET is this spacious First Floor, two bedroom flat, set in a modern and secure gated building on a sought-after road in Queens Park.

Offering 777 sq ft of bright accommodation, the property comprises an open plan reception/modern kitchen with hard wood floors and access to the two private balconies. The main bedroom follows the curve of the architecture of the building and includes a dressing area and an en-suite bathroom. The property offers a further double bedroom which is serviced by a family shower room.

The Avenue is one of Brondesbury's most sought-after roads, within close proximity of the independent cafés and bistros on Salusbury Road, Lonsdale Road and Chamberlayne Road. Moments away are the wide open spaces of Queen's Park and Tiverton Green.

- Spacious 2 bedroom First Floor Flat - 777 sq ft
- Secure gated development, 2 balconies
- Transport: Brondesbury Park (Overground-Zone 2)
- COUNCIL: Brent (E). Deposit: £3,576

020 8450 9377

rentals@cameronsstiff.co.uk

cameronsstiff.co.uk



The Avenue, NW6

Approx Gross Internal Area = 72.18 sq m / 777 sq ft

For identification only - Not to scale

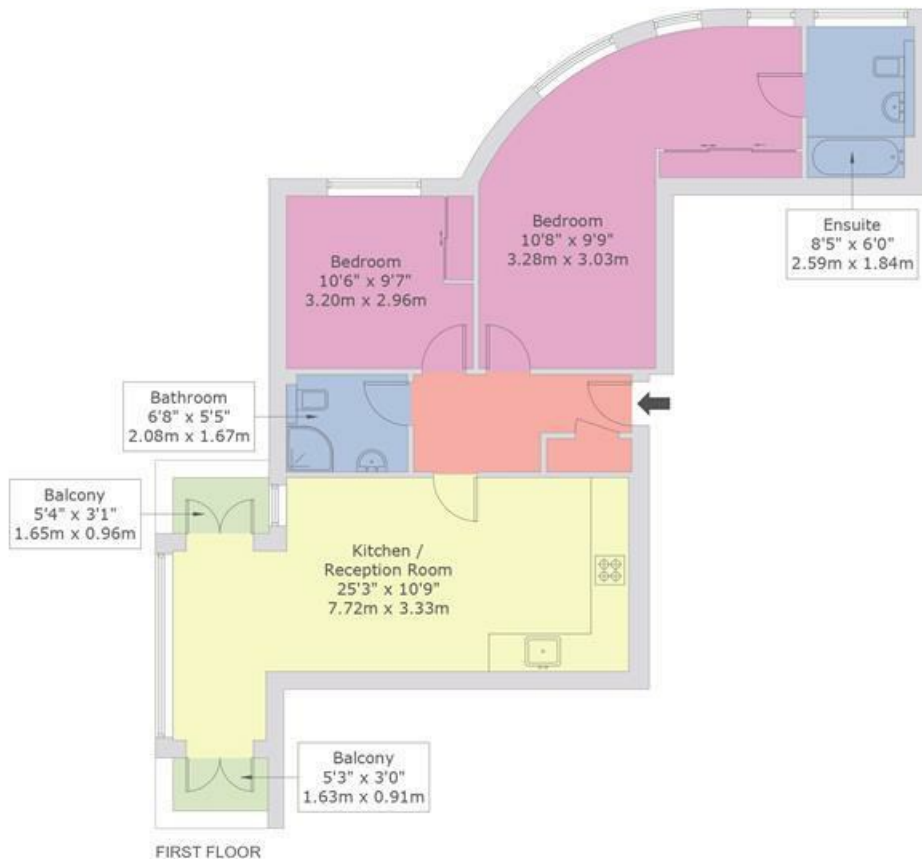

This floor plan is produced in accordance with RICS Property Measurement Standards incorporating International Property Measurement Standards (IPMS2 Residential).
Produced for Cameron Stiff & Co.
Copyright © BLEUPLAN

EPC: B

Ref: 19159920

