



## Dartmouth Road, NW2

### TO LET - £2,200 Per Month

AVAILABLE TO LET is this two bedroom Second Floor Flat, offering 1090 sq ft, set within a period building on the highly sought after Mapesbury Conservation Area.

With plenty of light and hard wooden flooring throughout, the property comprises a spacious reception room, a separate fitted kitchen and two double bedrooms with fitted wardrobes which are serviced by a modern family bathroom.

Situated in the popular Willesden Green with its wide roads, the property is moments away from Willesden Green (Jubilee - Zone 2) station, excellent array of local delis, restaurants and the green open spaces of the award winning 86-acre Gladstone Park just moments away. Queen's Park is very easily accessible.

- Bright and airy 2 bedroom Second Floor Flat
- Offering 1090 sq ft of accommodation
- Two large double bedrooms with fitted wardrobes
- A modern bathroom and kitchen
- Transport: Willesden Green (Jubilee-Zone 2)
- COUNCIL: Brent (E)

020 8450 9377

[rentals@cameronsstiff.co.uk](mailto:rentals@cameronsstiff.co.uk)

[cameronsstiff.co.uk](http://cameronsstiff.co.uk)

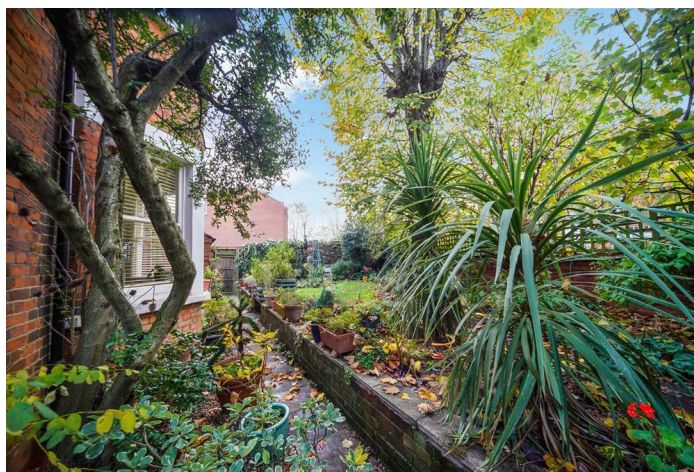

## Dartmouth Road, NW2

Approx Gross Internal Area = 101.3 sq m / 1090 sq ft  
For identification only - Not to scale

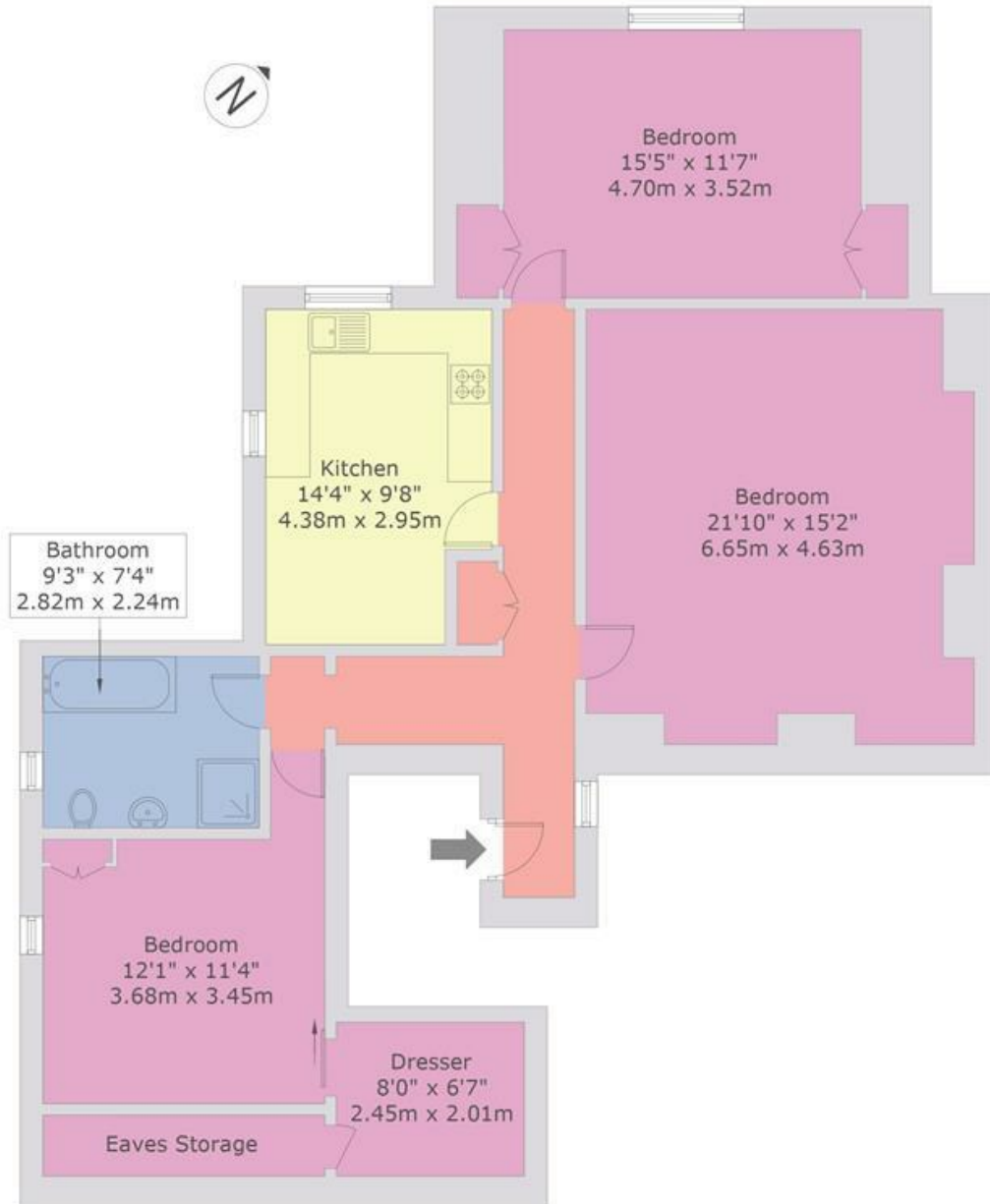

### SECOND FLOOR



This floor plan is produced in accordance with RICS Property Measurement Standards incorporating International Property Measurement Standards (IPMS2 Residential).  
Produced for Cameron Stiff & Co.  
Copyright © BLEUPLAN

EPC: D  
Ref: 15944860

