



## Bravington Road, W9

### TO LET - £2,300 Per Month

AVAILABLE TO LET is this tastefully presented two bedroom Top Floor Flat, situated on Bravington Road.

Offering 608 sq ft of well laid out accommodation, the property comprises a bright open plan modern fitted kitchen/reception room with hard wooden floors and a feature fireplace and two spacious double bedrooms which are serviced by a three piece bathroom.

Bravington Road is an attractive tree lined street which gives access to the vast array of amenities of Maida Vale, Queens Park and Notting Hill. Local transport links include Queen's Park station (Bakerloo- Zone 2) and Westbourne Park station (Hammersmith & City and Circle- Zone 2).

- Bright 2 bedroom Top Floor Flat
- Offering 608 sq ft of accommodation
- Open plan modern fitted kitchen/reception
- Transport: Queens Park (Bakerloo-Zone 2)
- Deposit: £2,884
- COUNCIL: Brent (D)

020 8450 9377

[rentals@cameronsstiff.co.uk](mailto:rentals@cameronsstiff.co.uk)

[cameronsstiff.co.uk](http://cameronsstiff.co.uk)



## Bravington Road, W9

Approx Gross Internal Area = 56.55 sq m / 608 sq ft

For identification only - Not to scale

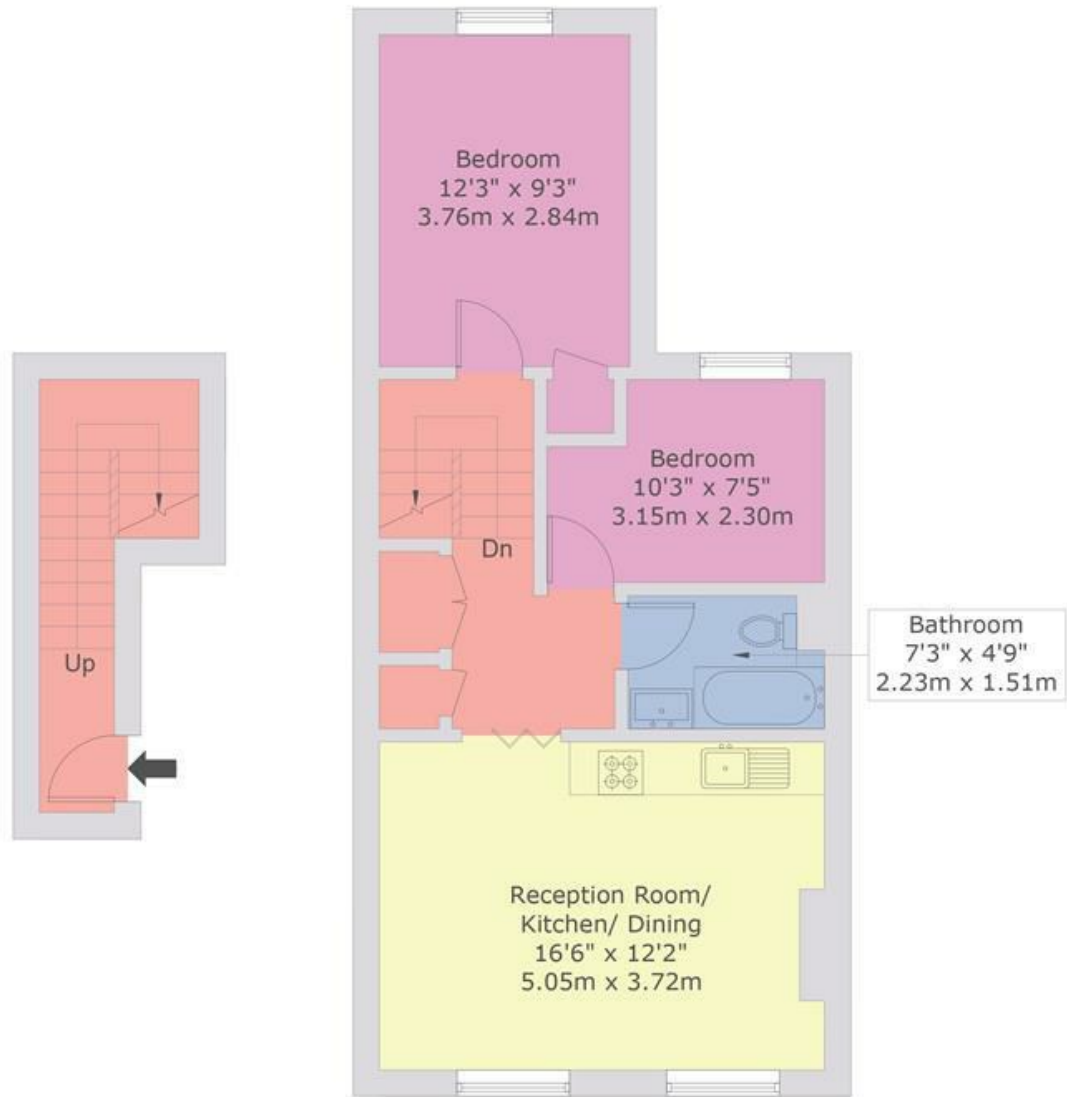

FIRST FLOOR

SECOND FLOOR



This floor plan is produced in accordance with RICS Property Measurement Standards incorporating International Property Measurement Standards (IPMS2 Residential). Maximum lengths and widths are represented on the floor plan. If there is any aspect of particular importance, you should carry out or commission your own inspection of the property. Produced for Cameron Stiff & Co. Copyright © BLEUPLAN

EPC: C  
Ref: 19076535

