



## Ebbsfleet Road, NW2

### TO LET - £2,900 Per Month

AVAILABLE TO LET is this recently refurbished three bedroom flat set on the First and Second Floors of this semi-detached property.

Offering 1086 sq ft of stylish accommodation, the First Floor comprises a bright bay fronted reception room with hard wood floors, guest WC, a separate modern fitted kitchen with quartz worktops and two double bedrooms. The Second Floor offers a further double bedroom with skylight and plenty of storage space, all bedrooms are serviced by a tiled family bathroom.

Located just moments from Kilburn Station (Jubilee - Zone 2) and all local amenities can be found on the adjacent Shoot-Up Hill including restaurants, cafes, supermarkets and more.

- Recently refurbished 3 bedroom Flat
- Offering 1086 sq ft of accommodation
- Modern fitted kitchen
- Bright bay fronted reception room
- Transport: Kilburn (Jubilee-Zone 2)
- COUNCIL: Camden (D). Deposit: £3,346

020 8450 9377

[rentals@cameronsstiff.co.uk](mailto:rentals@cameronsstiff.co.uk)

[cameronsstiff.co.uk](http://cameronsstiff.co.uk)



## Ebbsfleet Road, NW2

Approx Gross Internal Area = 100.9 sq m / 1086 sq ft

Restricted head height = 14.9 sq m / 160 sq ft

Total = 115.8 sq m / 1246 sq ft

For identification only - Not to scale

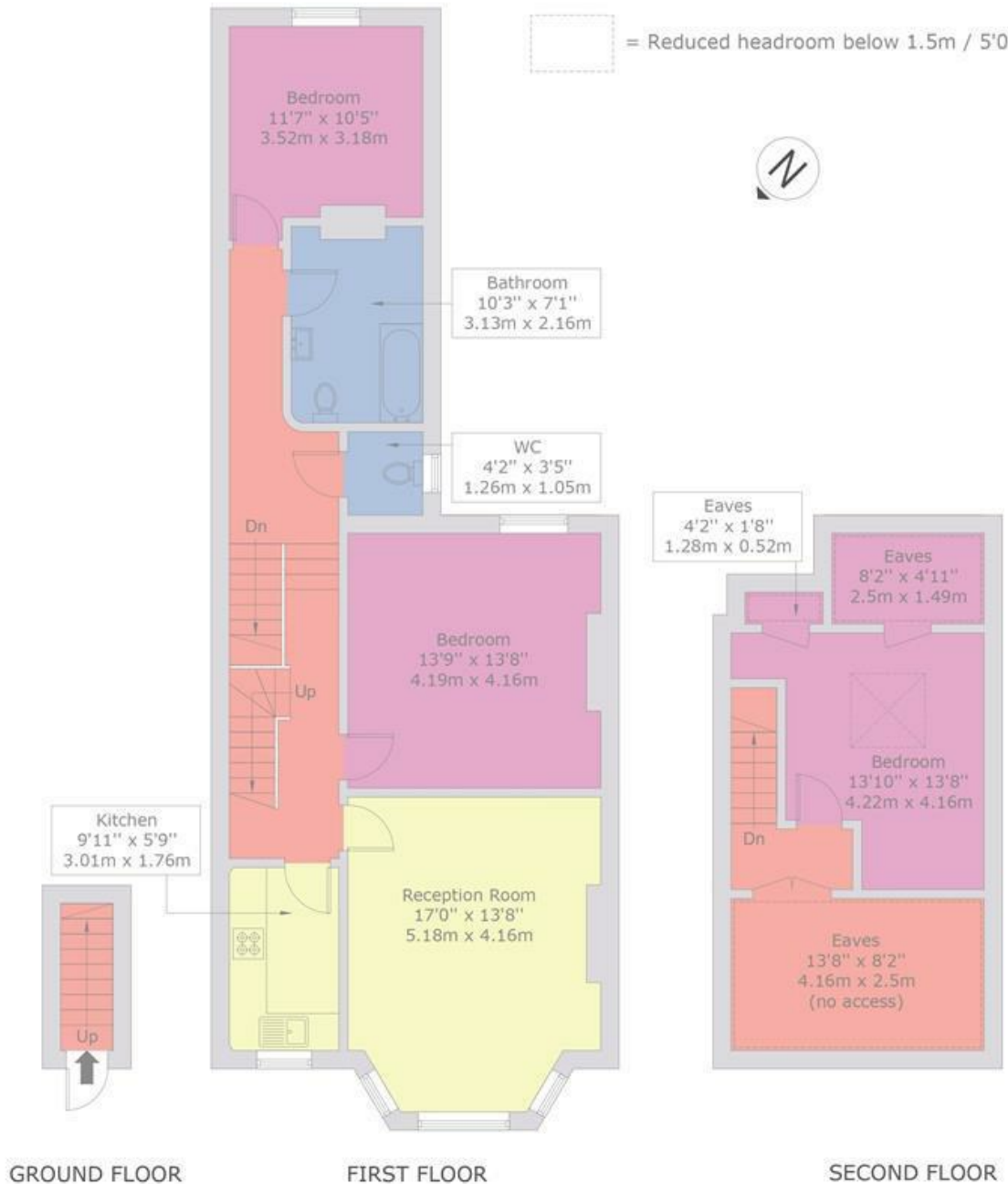

This floor plan is produced in accordance with RICS Property Measurement Standards incorporating International Property Measurement Standards (IPMS2 Residential). Maximum lengths and widths are represented on the floor plan. Produced for Cameron Stiff & Co. Copyright © BLEUPLAN

**EPC: D**  
Ref: 18881734

