



## Helena Road, NW10

### TO LET - £2,995 Per Month

AVAILABLE TO LET is this spacious and newly refurbished Semi-detached house, providing 1343 sq ft of accommodation on this popular residential road in Dollis Hill.

Accommodation comprises of three bedrooms, a double reception room, a fully fitted kitchen, Villeroy & Boch bathroom, and a separate downstairs WC. Externally, there is a 43 ft south-facing rear garden and off-street parking. The converted garage serves as an ideal home office with underfloor heating.

Helena Road is a quiet, tree-lined residential street within the coveted Dollis Hill Estate. The house is moments from the beautiful 86-acre Gladstone Park with its tennis courts and outdoor gym. It is also ideally positioned to access the amenities of Willesden Green. Local transport links include Dollis Hill (Jubilee - Zone 3) Station.

- Stylish 3 bedroom semi-detached house
- Offering 1343 sq ft of accommodation
- Home office with underfloor heating
- 43 ft south facing rear garden
- Transport: Dollis Hill (Jubilee-Zone 3)
- Deposit: £3173 Council: Brent (E)

020 8450 9377

[rentals@cameronsstiff.co.uk](mailto:rentals@cameronsstiff.co.uk)

[cameronsstiff.co.uk](http://cameronsstiff.co.uk)



## Helena Road, NW10 1HY

Approx Gross Internal Area = 124.8 sq m / 1343 sq ft

Garden = 116 sq m / 1249 sq ft

Total = 240.8 sq m / 2592 sq ft

For identification only - Not to scale

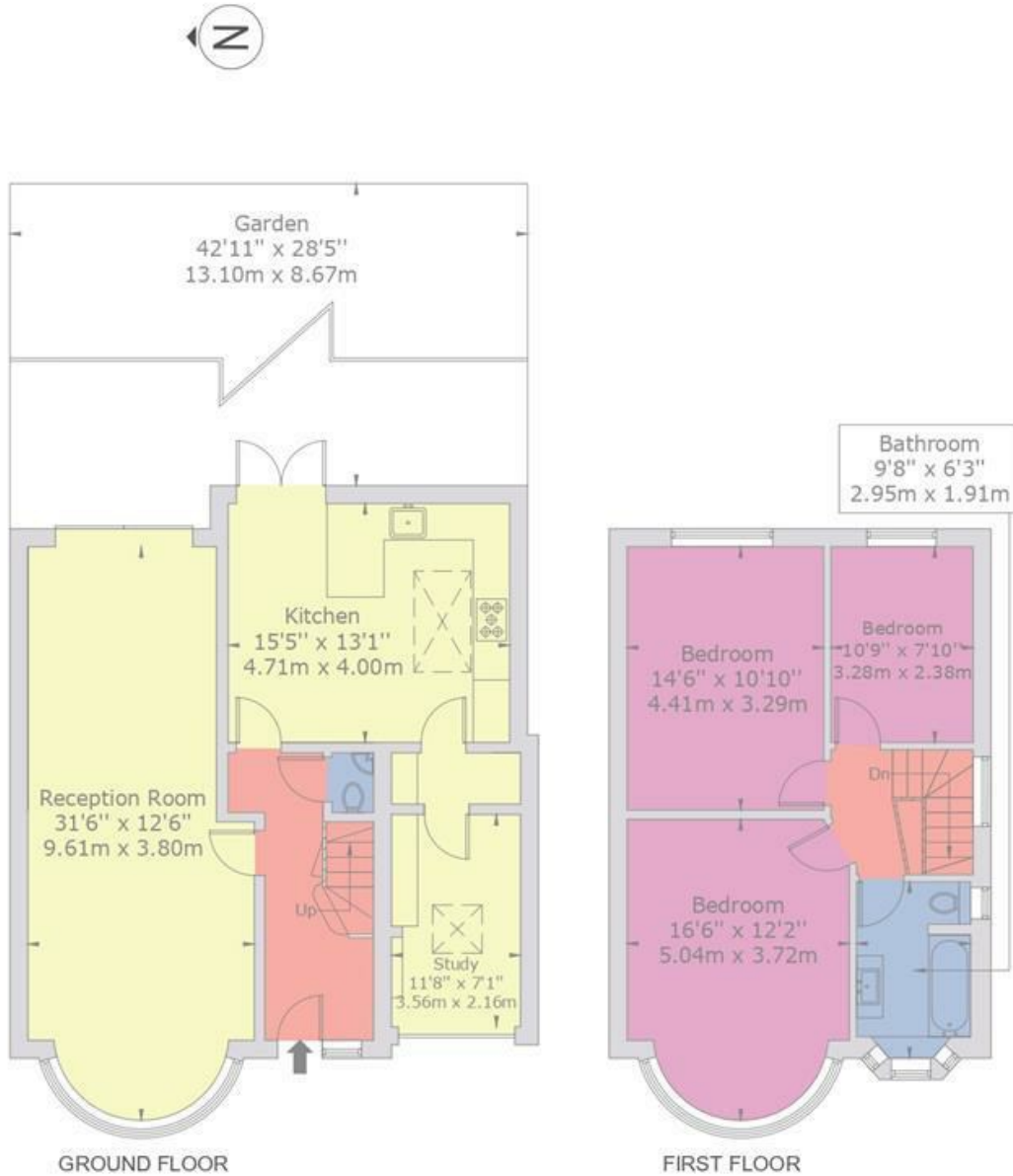

This floor plan is produced in accordance with RICS Property Measurement Standards incorporating International Property Measurement Standards (IPMS2 Residential).  
Produced for Cameron Stiff & Co.  
Copyright © BLEUPLAN

EPC: D  
Ref: 15603520

