



Larch Road, NW2

TO LET - £2,350 Per Month

TO LET is this beautifully presented two bedroom Ground Floor Flat, situated within a Victorian terraced house, moments away from Gladstone Park.

Offering 742 sq ft of well laid out accommodation, the property comprises a bright and spacious open plan modern kitchen/reception room with bi-folding doors leading to the 32 ft private garden, guest WC and two double bedrooms with fitted wardrobes which are serviced by a family bathroom with underfloor heating.

Larch Road is located just North of Willesden Green and moments from Gladstone Park. The amenities of Willesden Green and Kilburn are within walking distance. Local transport links include Willesden Green (Jubilee - Zone 2) Cricklewood and (Thameslink - Zone 3).

- Spacious 2 bedroom Ground Floor Flat
- Offering 742 sq ft of accommodation
- Bright open plan kitchen/reception
- 32 ft private garden
- Excellent transport links into London
- COUNCIL: Brent (D). Deposit: £2,942

020 8450 9377

rentals@cameronsstiff.co.uk

cameronsstiff.co.uk



Larch Road, GFF, London, NW2

Approximate Area = 742 sq ft / 69 sq m

For identification only - Not to scale

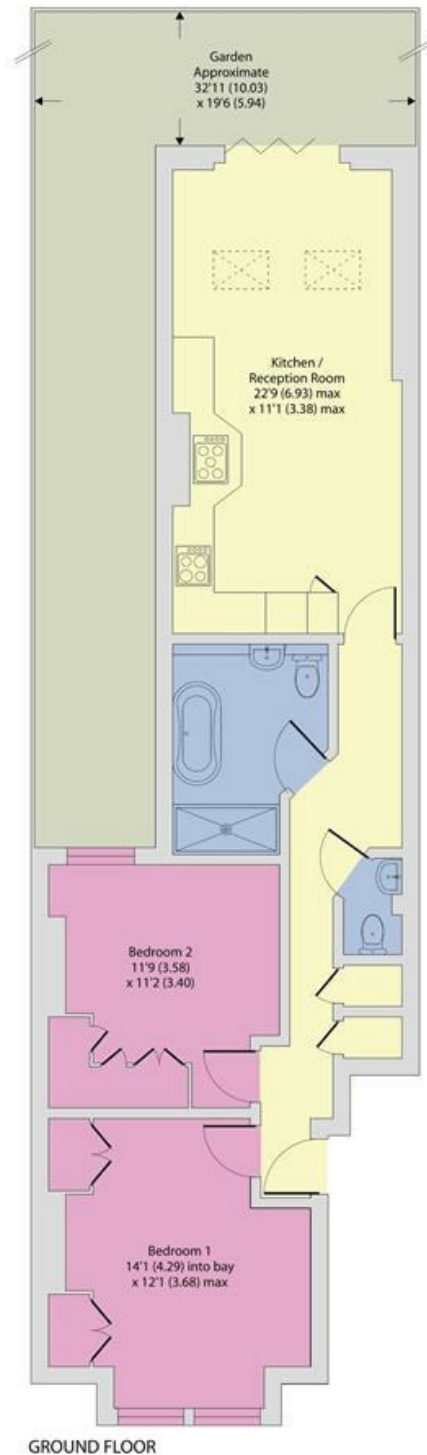

Floor plan produced in accordance with RICS Property Measurement Standards incorporating International Property Measurement Standards (IPMS2 Residential). © n/checom 2024. Produced for Camerons Stiff & Co. REF: 922963

EPC: C

Ref: 18295789

