



Neasden Lane, NW10

TO LET - £2,400 Per Month

AVAILABLE TO LET- is this exceptionally spacious two bedroom flat situated on the Fourth Floor of this new homes development close to Neasden.

Offering 698 sq ft of well laid out accommodation, this bright and airy apartment comprises a contemporary style open plan kitchen/reception with access to the a private balcony and two double bedrooms which is serviced by a modern family bathroom. The property also benefits from hard wooden flooring throughout, a rooftop communal garden and private parking (available with additional negotiations)

The property is located within a few hundred yards of local amenities and bus services at Willesden High Road. Transport includes Dollis Hill Station (Jubilee- Zone 3) and Neasden Station (Jubilee-Zone 3).

- Spacious 2 bedroom apartment
- Offering 698 sq ft of well laid out accommodation
- Contemporary open plan kitchen/reception
- Private balcony & communal roof terrace
- Private parking
- COUNCIL: Brent (C). Deposit: £2,769

020 8450 9377

rentals@cameronsstiff.co.uk

cameronsstiff.co.uk



Neasden Lane, London, NW10

Approximate Area = 698 sq ft / 65 sq m

For identification only - Not to scale

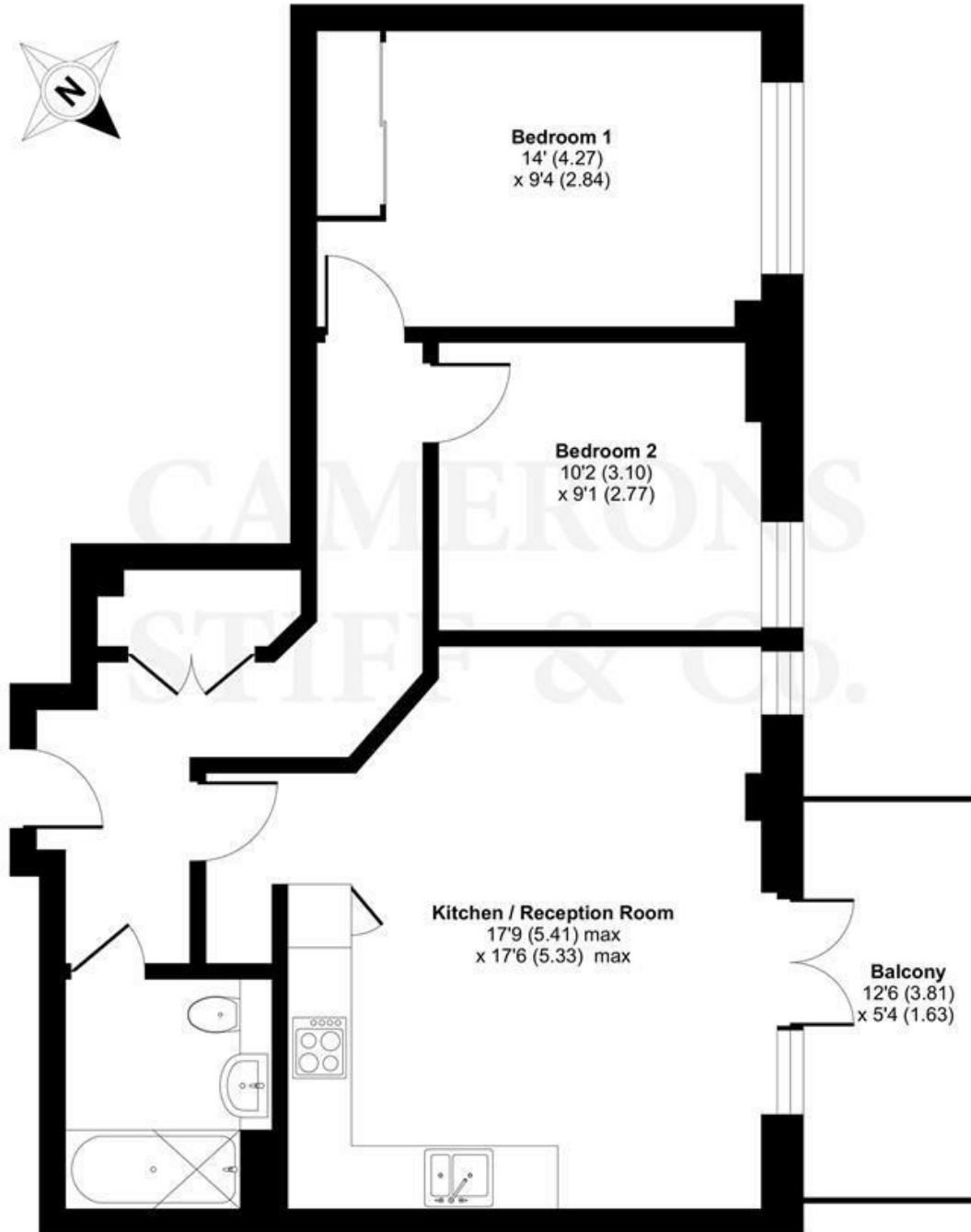

FOURTH FLOOR



Floor plan produced in accordance with RICS Property Measurement Standards incorporating International Property Measurement Standards (IPMS2 Residential). © nichecom 2022. Produced for Camerons Stiff & Co. REF: 882527

EPC: B

Ref: 18192428

