



Pine Road (NOT ONLINE), NW2

TO LET - £3,500 Per Month

AVAILABLE NOW TO RENT - is this exceptionally well-presented refurbished three bedroom Period mid-terraced house set in the heart of Cricklewood.

With 1,458 sq ft of internal living accommodation, the Ground Floor is comprised of a bright bay fronted reception room, dining room, modern kitchen with access to a 17 ft private rear lawned garden and a downstairs shower room. The First Floor features three double bedrooms serviced by a three piece family bathroom.

Pine Road is a quiet residential street close to the open spaces of the 86-acre Gladstone Park with plenty of outdoor activities including 5K Park Run, outdoor gym and tennis courts. This property is a short distance away from Cricklewood Station (Thameslink - Zone 3), providing easy access into Central London.

- Refurbished 3 bedroom mid-terraced Period house
- Offering 1,458 sq ft of accommodation over 2 floors
- 17ft private east-facing garden
- Transport links: Cricklewood Thameslink (Zone 3)
- COUNCIL: Brent (D)
- DEPOSIT: £4,038

020 8450 9377

rentals@cameronsstiff.co.uk

cameronsstiff.co.uk



Pine Road, London, NW2

Approximate Area = 1458 sq ft / 135.4 sq m

For identification only - Not to scale

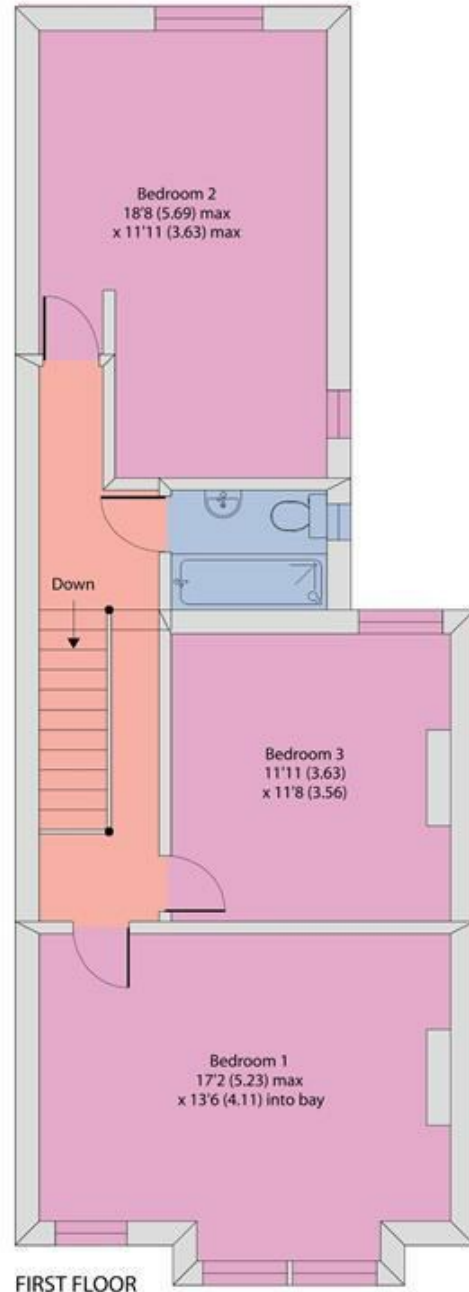

EPC:
Ref: 18984330



Floor plan produced in accordance with RICS Property Measurement Standards incorporating International Property Measurement Standards (IPMS2 Residential). © nchecon 2024. Produced for Camerons Stiff & Co. REF: 1155382

