



Keyes Road, NW2

TO LET - £2,000 Per Month

AVAILABLE TO LET NOW- is this well presented First Floor two bedroom flat situated close to Cricklewood Lane.

Offering 568 sq ft of internal living accommodation, the property boasts a bright open plan reception/kitchen with modern fitted appliances, the main bedroom with an ensuite shower room and a further double bedroom which is serviced by a modern fitted three piece bathroom.

Keyes Road is a quiet residential road within the Mapesbury Conservation Area, situated on the borders of the Mapesbury Dell. The amenities of Willesden Green are within walking distance along with Willesden Green Station (Jubilee) - Zone 2).

- A bright 2 bedroom First Floor Flat
- Offering 568 sq ft of accommodation
- Open plan reception/fully fitted kitchen
- Transport: Willesden Green (Jubilee-Zone 2)
- Deposit: £2,307
- COUNCIL: Brent (D)

020 8450 9377

rentals@cameronsstiff.co.uk

cameronsstiff.co.uk



Keyes Road, NW2

Approx Gross Internal Area = 52.8 sq m / 568 sq ft
For identification only - Not to scale

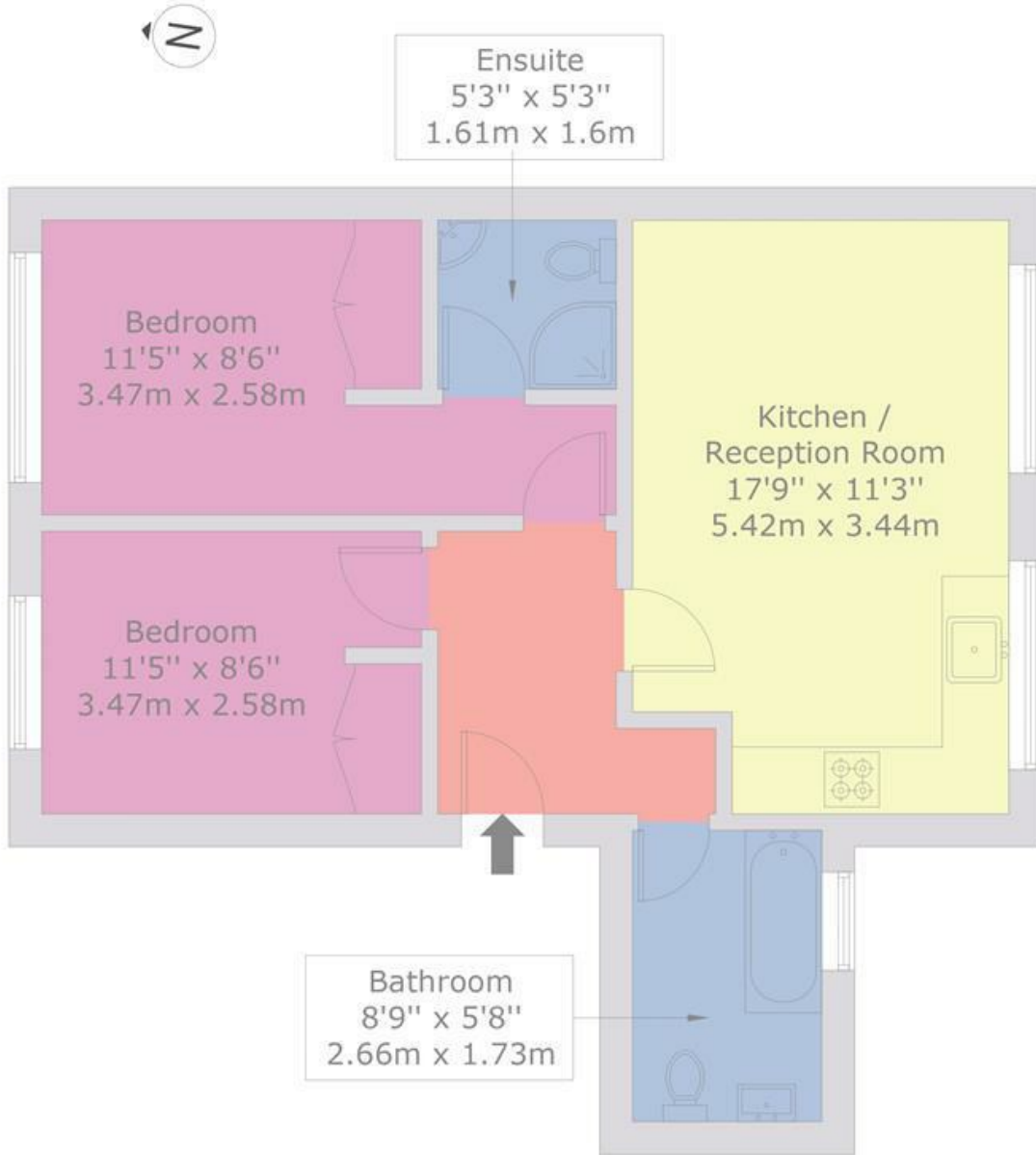

FIRST FLOOR



This floor plan is produced in accordance with RICS Property Measurement Standards incorporating International Property Measurement Standards (IPMS2 Residential). Maximum lengths and widths are represented on the floor plan. Produced for Cameron Stiff & Co. Copyright © BLEUPLAN

EPC:
Ref: 18970028

