



Newman Close, NW10

TO LET - £1,800 Per Month

Available to let- is this beautifully maintained one bedroom Second Floor apartment situated within this modern, new home development, known as The Library in the heart of Willesden.

Offering 586 sq ft of well laid out accommodation, the bright and airy property comprises an open plan fully fitted kitchen/reception room with a private balcony and a spacious bedroom with fitted wardrobes, which is serviced by a contemporary bathroom. Externally, there is plenty of open space including a communal roof terrace & parking space.

Transport includes Willesden Green (Jubilee - Zone 2) station being about five minutes walk away along with good bus Routes. Local amenities include numerous cafes, restaurant, grocery shops and poplar 86 acres Gladstone Park offering playgrounds, tennis court and outdoor gym.

- Generous sized 1 bedroom apartment
- Modern open plan kitchen/reception
- Situated on corner plot with balcony
- Communal garden & off-street parking
- Transport: Willesden Green (Jubilee-Zone 2)
- COUNCIL: Brent (C). Deposit: £2,076

020 8450 9377

rentals@cameronsstiff.co.uk

cameronsstiff.co.uk



Newman Close, London, NW10

APPROX. GROSS INTERNAL FLOOR AREA 586 SQ FT 54.4 SQ METRES

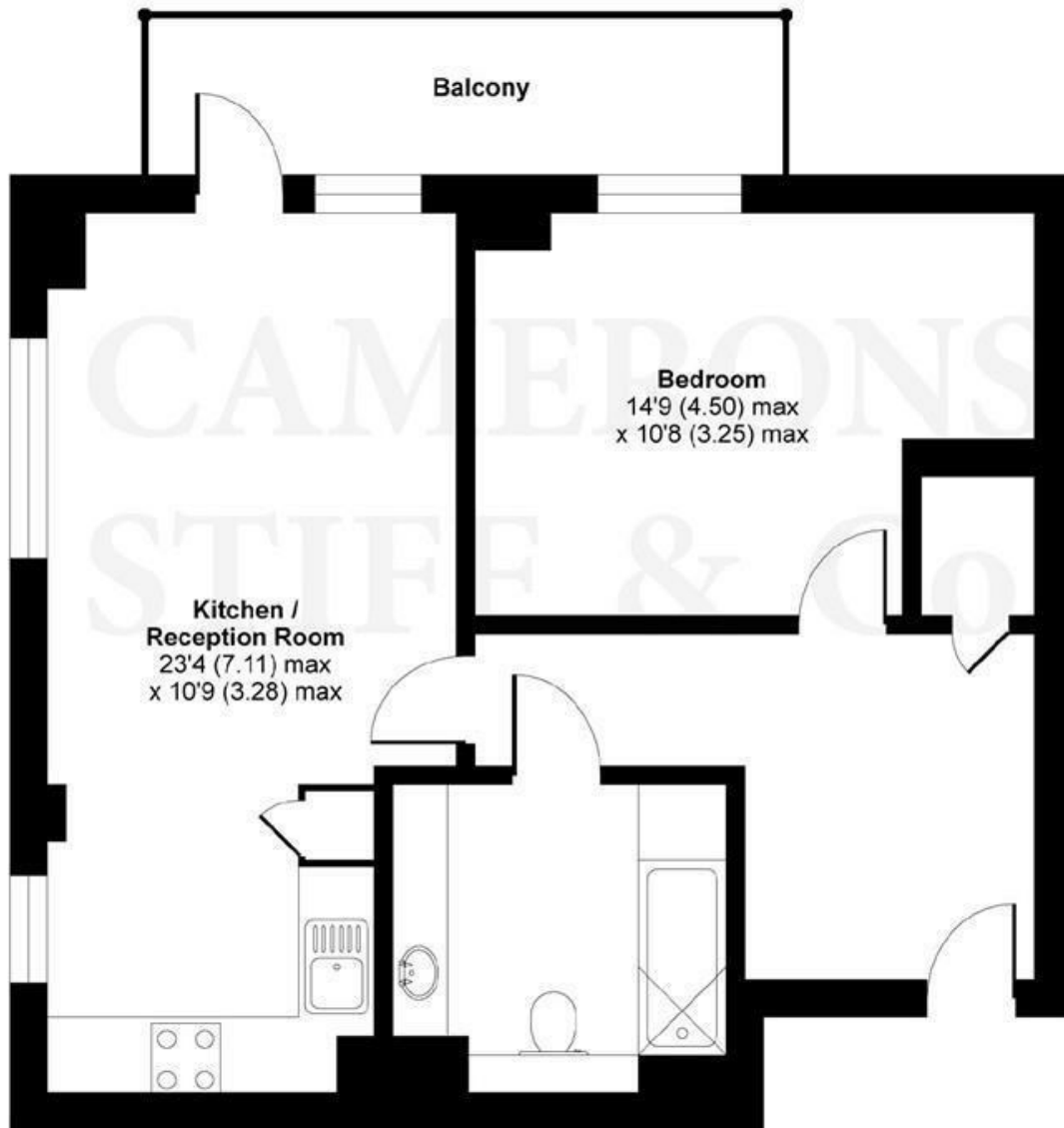

SECOND FLOOR

Whilst every attempt has been made to ensure the accuracy of the floor plan contained here, measurements of doors, windows and rooms are approximate and no responsibility is taken for any error, omission or misstatement. These plans are for representation purposes only as defined by RICS Code of Measuring Practice and should be used as such by any prospective purchaser. Specifically no guarantee is given on the total square footage of the property if quoted on this plan. Any figure given is for initial guidance only and should not be relied on as a basis of valuation.

Copyright nichecom.co.uk 2019 Produced for Camerons Stiff & Co REF : 487512

EPC: B
Ref: 18869454

