



## Dartmouth Road, NW2

### TO LET - £1,700 Per Month

AVAILABLE TO LET from 17th July 2024- is this charming one bedroom First Floor apartment set within a Period building on the sought-after Mapesbury Conservation Area.

Offering 439 sq ft of well laid out accommodation, the property comprises a bright and airy reception room with bay windows and a feature fireplace, a fully fitted kitchen and a generous sized bedroom with fitted wardrobes which is serviced by a three piece bathroom.

Dartmouth Road is within walking distance to local transport links from Willesden Green (Jubilee- Zone 2) and to all the local shops, restaurants and trendy bars. There are various fitness facilities such as South Hampstead Tennis Club, Nuffield Health & Wellbeing Gym, and Willesden Sports Centre, which are not too far from the property.

- TO LET from 17/06/2024 - FURNISHED
- Spacious 1 bedroom apartment
- Transport links: Willesden Green (Jubilee- Zone 2)
- Deposit: £1961
- COUNCIL: Brent (D)

020 8450 9377

[rentals@cameronsstiff.co.uk](mailto:rentals@cameronsstiff.co.uk)

[cameronsstiff.co.uk](http://cameronsstiff.co.uk)



## Dartmouth Road, Willesden Green, London, NW2

APPROX. GROSS INTERNAL FLOOR AREA 439 SQ FT 40.7 SQ METRES

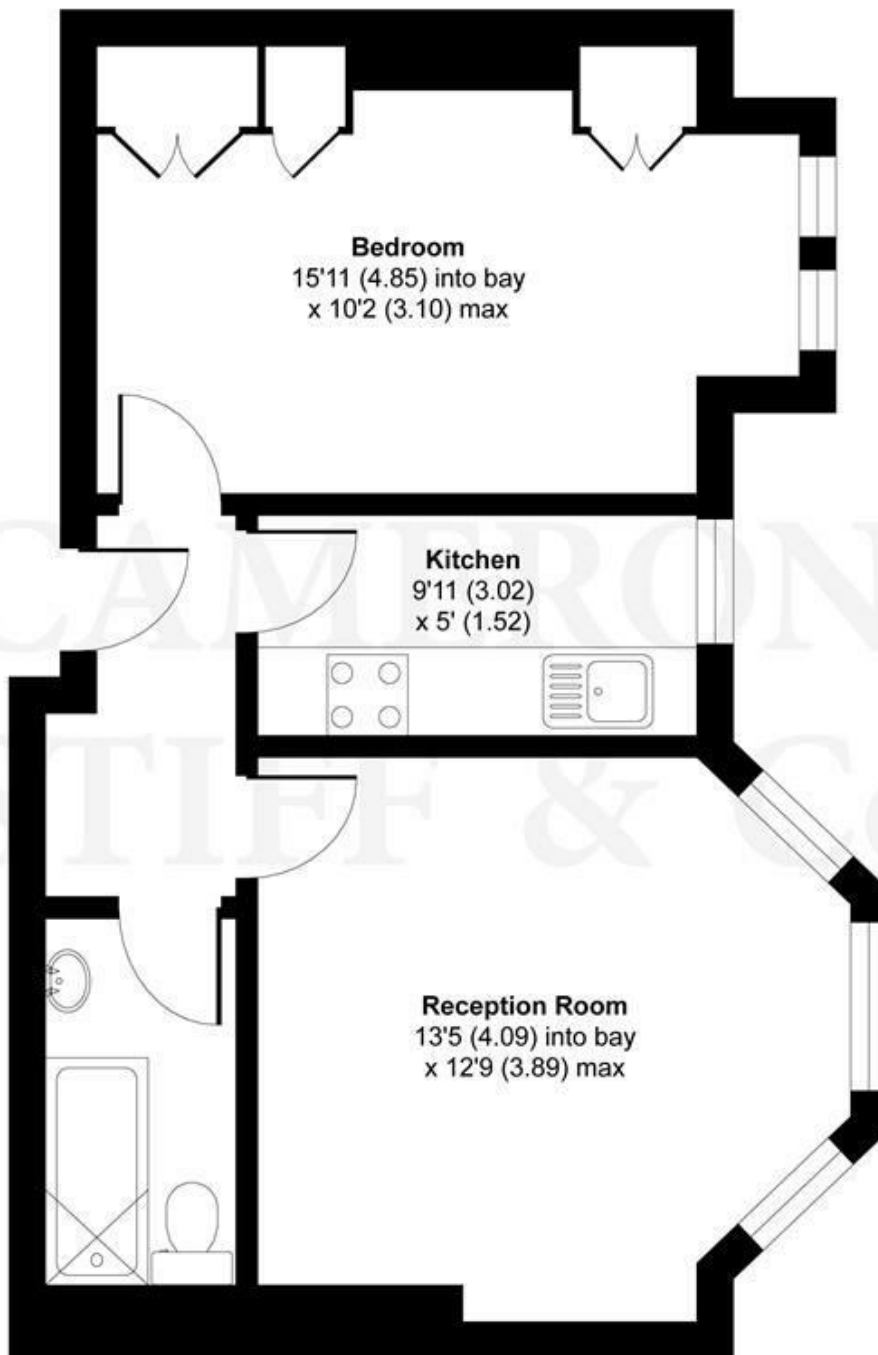

### FIRST FLOOR

EPC: D

Ref: 15083490

Whilst every attempt has been made to ensure the accuracy of the floor plan contained here, measurements of doors, windows and rooms are approximate and no responsibility is taken for any error, omission or misstatement. These plans are for representation purposes only as defined by RICS Code of Measuring Practice and should be used as such by any prospective purchaser. Specifically no guarantee is given on the total square footage of the property if quoted on this plan. Any figure given is for initial guidance only and should not be relied on as a basis of valuation.

Copyright nichecom.co.uk 2017 Produced for Camerons Stiff & Co REF :

