



Park Avenue North, NW10, NW10

To Let - £1,950 Per Month

AVAILABLE TO LET NOW is this two-bedroom, one-bathroom property located on Park Avenue North.

Offering 734sq ft of internal living accommodation, this property boasts a bright, open-plan kitchen and lounge with modern fitted appliances which is situated towards the rear of the property, where you will also find the three-piece modern fitted bathroom with grey tiling, a large main bay window fronted double bedroom and an additional sizable second double bedroom.

Park Avenue North is within easy walking distance of local amenities and transport links via Cricklewood (Thameslink - Zone 3) Willesden Green (Jubilee - Zone 2) and Brondesbury (Overground - Zone 2) stations with local buses also giving you easy access into Central London.

- Ground floor, two-bedroom apartment
- Open plan kitchen and reception
- Modern bathroom
- Great transport links including Cricklewood and Willesden Green
- Deposit: £2250 - Council Tax: Brent (G)

020 8450 9377

rentals@cameronsstiff.co.uk

cameronsstiff.co.uk







Park Avenue North, Flat B, London, NW10

Approximate Area = 734 sq ft / 68 sq m

For identification only - Not to scale

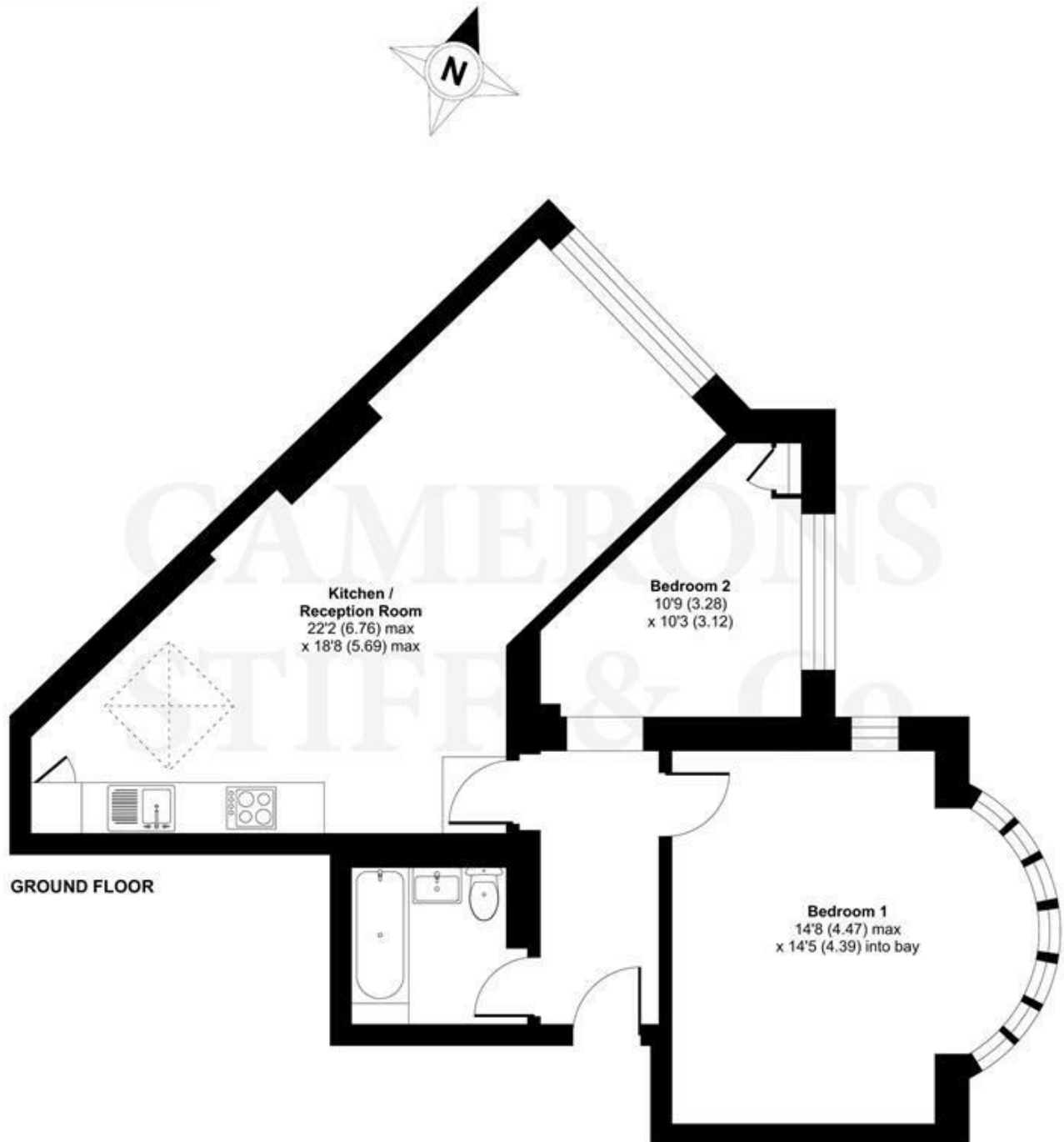

EPC: C

Ref: 18298206



Floor plan produced in accordance with RICS Property Measurement Standards incorporating International Property Measurement Standards (IPMS2 Residential). © n'checon 2022. Produced for Camerons Stiff & Co. REF: 923685

