



Connaught Road, NW10

To Let - £1,500 Per Month

AVAILABLE TO LET FROM 10TH MAY 2024 is this second-floor, one-double-bedroom flat situated within a large Victorian building in the heart of Harlesden.

This property offers 613 sq ft of internal living space with a cosy reception room with elevated views, a bright eat-in kitchen, a double bedroom and a three-piece bathroom suite.

The flat is close to the area's local amenities, including the bars, restaurants, delis and shops on Harlesden High Road. Great transport links are also available from both Harlesden (Overground and Bakerloo - Zone 2) & Willesden Junction Bakerloo and Overground - Zone 2) stations, alongside easy access to several bus routes. The open space of Roundwood Park is also within easy reach to enjoy. Viewing is recommended.

- AVAILABLE FOR RENT FROM 10TH MAY 2024
- One large double bedroom & reception
- Eat-in kitchen with ample storage
- Three-piece bathroom
- Council - Brent (C) Deposit - £1,730

020 8450 9377

rentals@cameronsstiff.co.uk

cameronsstiff.co.uk







Connaught Road, London, NW10

APPROX. GROSS INTERNAL FLOOR AREA 613 SQ FT 59.9 SQ METRES

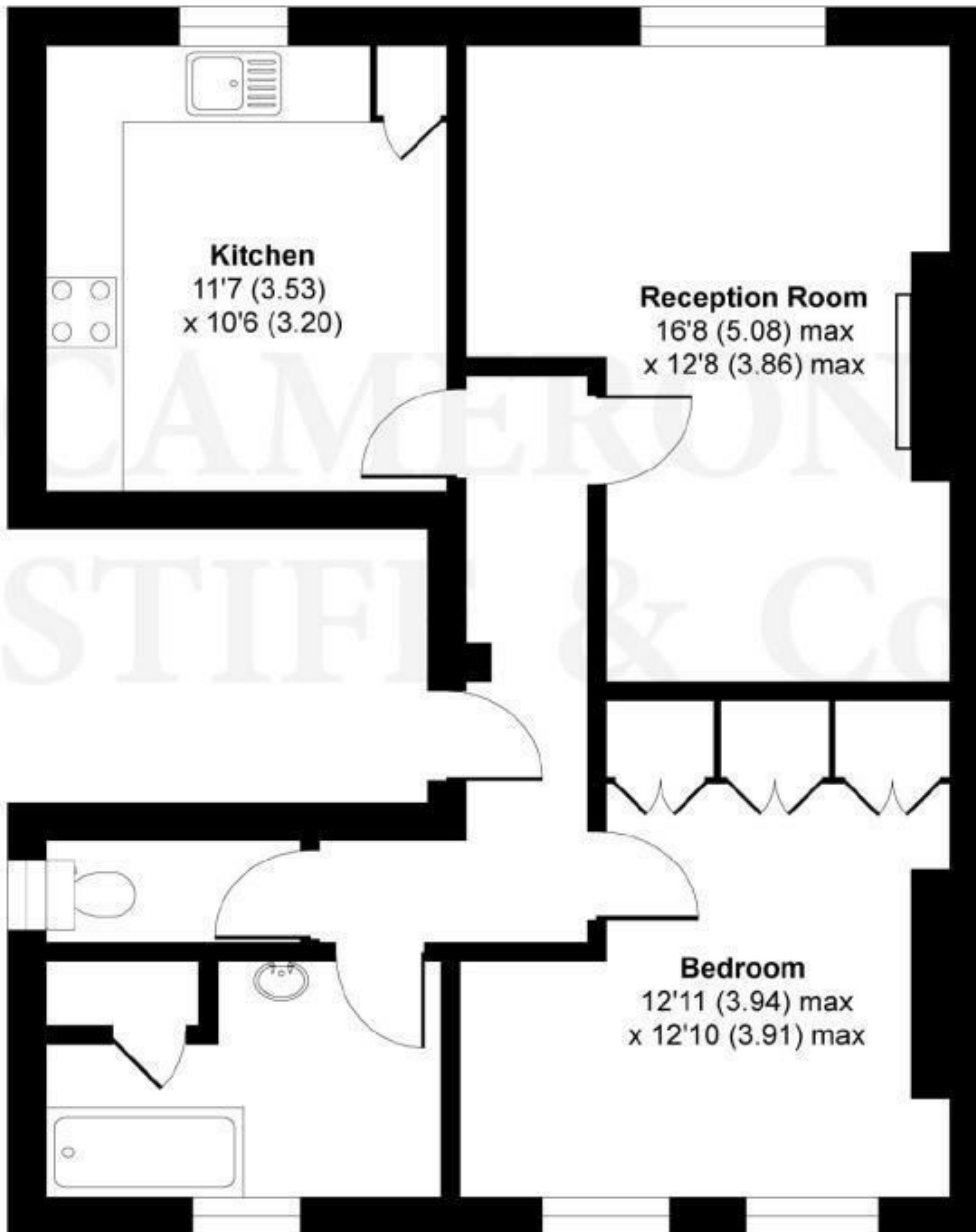

FIRST FLOOR

EPC: D
Ref: 15636289

Whilst every attempt has been made to ensure the accuracy of the floor plan contained here, measurements of doors, windows and rooms are approximate and no responsibility is taken for any error, omission or misstatement. These plans are for representation purposes only as defined by RICS Code of Measuring Practice and should be used as such by any prospective purchaser. Specifically no guarantee is given on the total square footage of the property if quoted on this plan. Any figure given is for initial guidance only and should not be relied on as a basis of valuation.

Copyright nichecom.co.uk 2019 Produced for Camerons Stiff & Co REF : 509133

