



Kilburn High Road, NW6 TO LET - £1,250 Per Month

AVAILABLE TO LET is this well-presented, First Floor, self-contained Studio apartment that has been conveniently located in a quiet cobbled mews just off Kilburn High Road.

The studio offers a bright modern, white open plan Reception/Kitchen with integrated appliances. There is a open plan sleeping area and a contemporary style shower room with heated towel rail and WC, laminated wood flooring, downlighters and plenty of light.

Great location close to both Willesden Green and within walking distance of Queen's Park along with many bars, restaurants, shops, gyms and transport links. Brondesbury (Overground) & Kilburn (Jubilee - Zone 2) stations are within walking distance.

- AVAILABLE TO LET FROM 26th MARCH 2024
- Modern contemporary studio apartment - 156 sq ft
- Integrated modern kitchen and shower room
- COUNCIL: Brent (A) DEPOSIT: £1442
- Convenient transport links into London

020 8450 9377

rentals@cameronsstiff.co.uk

cameronsstiff.co.uk



Kilburn High Road, London, NW6

APPROX. GROSS INTERNAL FLOOR AREA 156 SQ FT 14.5 SQ METRES

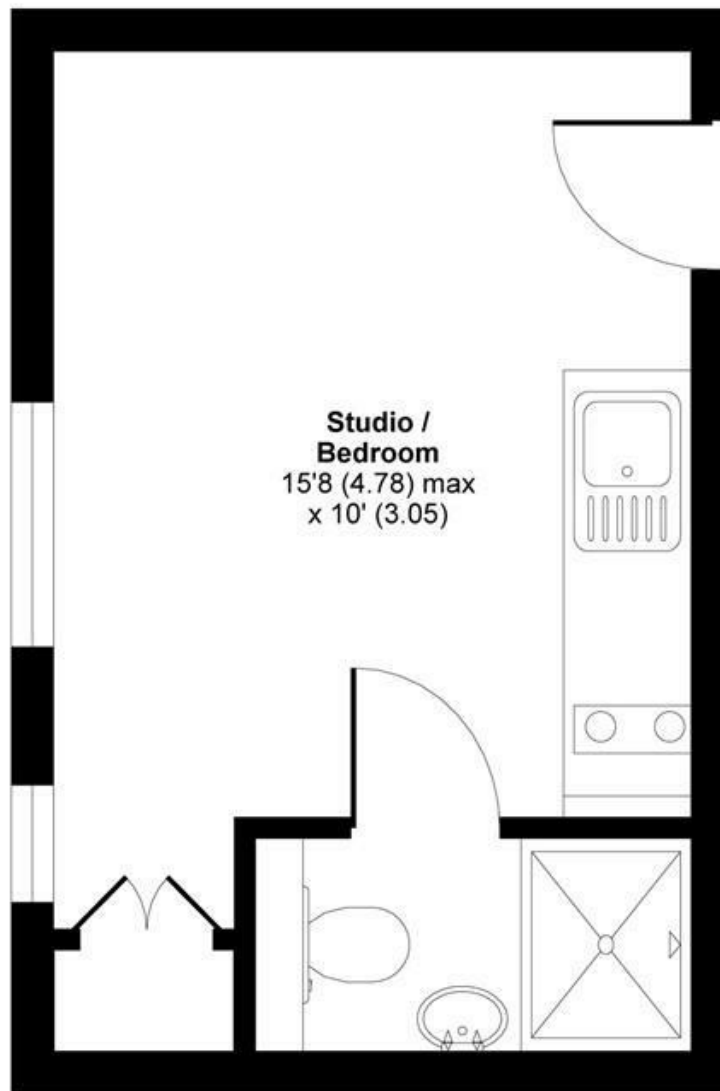

SECOND FLOOR

EPC: D
Ref: 15061739

Whilst every attempt has been made to ensure the accuracy of the floor plan contained here, measurements of doors, windows and rooms are approximate and no responsibility is taken for any error, omission or misstatement. These plans are for representation purposes only as defined by RICS Code of Measuring Practice and should be used as such by any prospective purchaser. Specifically no guarantee is given on the total square footage of the property if quoted on this plan. Any figure given is for initial guidance only and should not be relied on as a basis of valuation.

Copyright nichecom.co.uk 2019 Produced for Camerons Stiff & Co REF : 547013

