



## Willesden Lane, NW6

### To Let - £1,850 Per Month

AVAILABLE TO RENT is this well presented and furnished First Floor one-bedroom apartment situated near Kilburn High Road.

The generously sized 683 sq ft apartment features a bright and open-plan reception area, complete with a modern kitchen equipped with fully-fitted white goods. Additionally, it boasts a partially-tiled bathroom, a good-sized double bedroom with built-in wardrobe space, a private balcony with views overlooking Willesden Lane, and access to a communal roof terrace.

Being within proximity to Kilburn High Road, the property offers great transportation links to Central London via Kilburn Jubilee Line and Brondesbury Overground Stations (Zone 2). Additionally, it is within walking distance to the area's popular gastro pubs, cafes, shops and more.

- First Floor apartment
- Open Plan Kitchen/Reception Room
- Double Bedroom with Modern Bathroom
- Communal Roof Terrace, Private Balcony
- Bicycle Storage available
- DEPOSIT - £2,301 COUNCIL - Brent (D)

020 8450 9377

[rentals@cameronsstiff.co.uk](mailto:rentals@cameronsstiff.co.uk)

[cameronsstiff.co.uk](http://cameronsstiff.co.uk)







## Willesden Lane, NW6

Approx Gross Internal Area = 60.6 sq m / 652 sq ft

Balcony = 2.9 sq m / 31 sq ft

Total = 63.5 sq m / 683 sq ft

For identification only - Not to scale

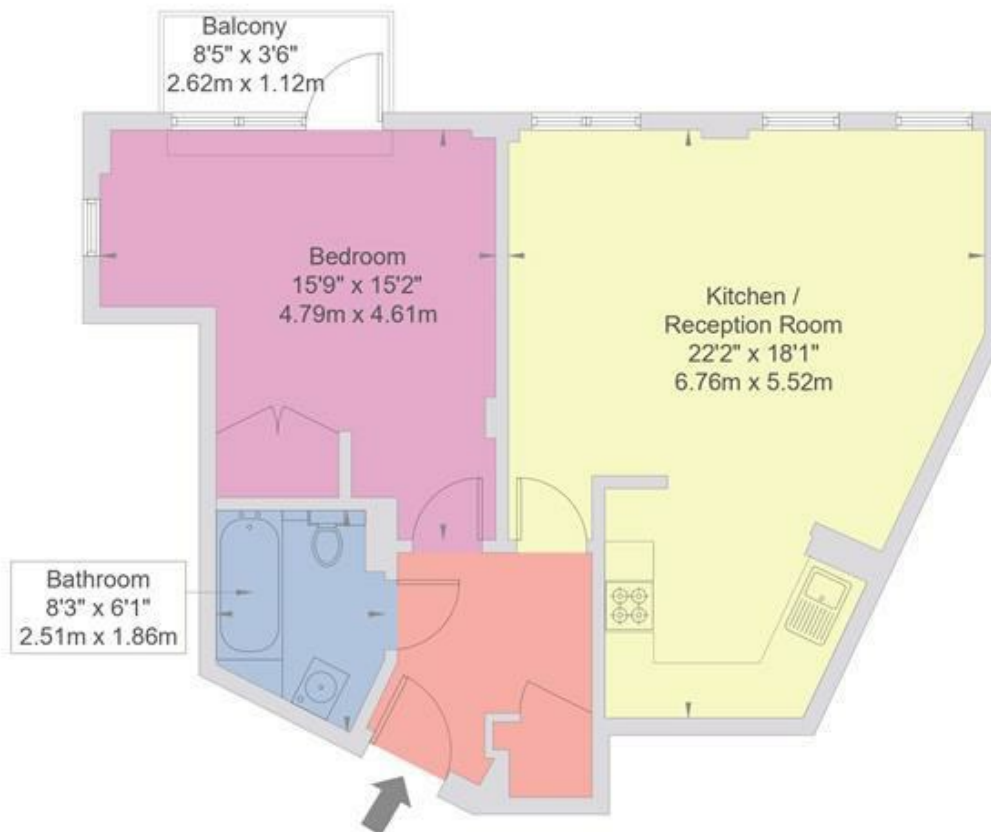

FIRST FLOOR

EPC: C

Ref: 15065043



This floor plan is produced in accordance with RICS Property Measurement Standards incorporating International Property Measurement Standards (IPMS2 Residential).  
Produced for Cameron Stiff & Co.  
Copyright © BLEUPLAN

