



**501 Kings Road, SW10**

**Asking Price £500,000**

**EPC: D**

# Gross Approx. Internal Area

605.00 sq ft

Kings Road, London, SW10

Approximate Gross Internal Floor Area = 56.2 sq m / 605 sq ft

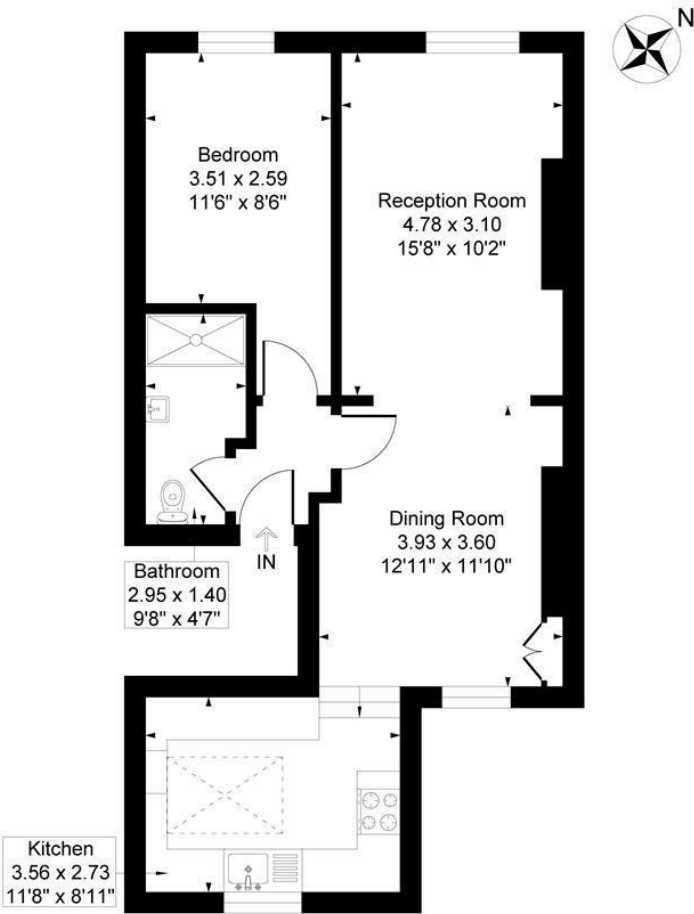

Third Floor

Illustration for identification purposes only, measurements are approximate, not to scale.



£500,000  
Leasehold

- Tenure - Leasehold
- Lease Length - Approx. 90 Years Remaining
- Council Tax (RBKC) - Band D
- 25/26 - £1,569.46
- EPC Rating - D
- Service Charge Approx. £2500pa
- Ground Rent £100pa escalating
- Probate Sale



**STANLEY**  
PROPERTY.LONDON