



CHASE APARTMENTS  
LONDON



Millennium House, 10 Plaza Gardens, Putney SW15 2DN

£2,300 Per Week

- 24 HOUR CONCIERGE SERVICE
- CLOSE TRANSPORT LINKS AND AMENITIES
- LARGE BALCONY
- 4th FLOOR
- ON-SITE LEISURE FACILITIES

Grosvenor Waterside, 32 Gatliff Road, Belgravia, London, SW1W 8QN  
02077225022

<http://www.chaseapartments.com/>

MILLENNIUM HOUSE, SW15  
Approx. gross internal area  
574 Sq Ft. / 53.3 Sq M.

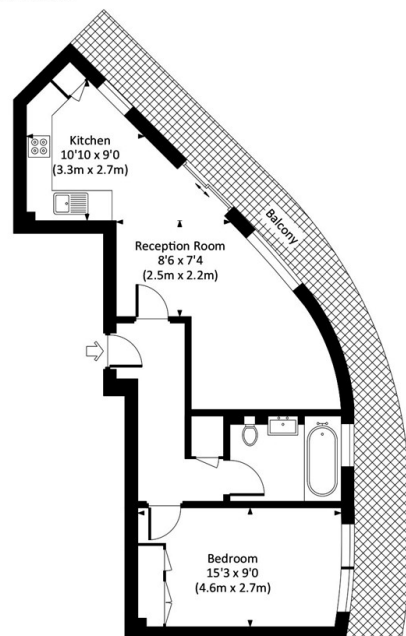

FOURTH FLOOR

All measurements have been made in accordance with RICS code of Measuring Practice which are approximate only and only for illustrative purposes. For the avoidance of doubt, Dowling Jones Design shall not be liable for any reliance on these measurements. © 2019 www.dowlingjones.com 020 7610 9933

## Viewings

Viewings by arrangement only.  
Call 02077225022 to make an appointment.

## Council Tax Band

D

## EPC Rating:

C

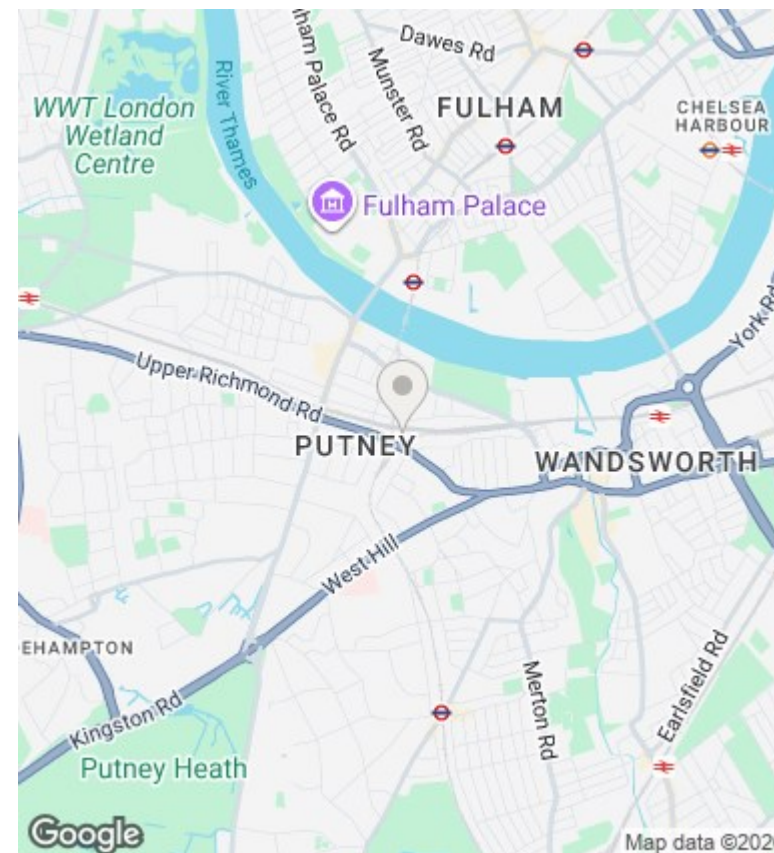

Energy Efficiency Rating		
	Current	Potential
Very energy efficient - lower running costs		
(92 plus) <b>A</b>		
(81-91) <b>B</b>		
(69-80) <b>C</b>	77	77
(55-68) <b>D</b>		
(39-54) <b>E</b>		
(21-38) <b>F</b>		
(1-20) <b>G</b>		
Not energy efficient - higher running costs		
<b>England &amp; Wales</b>	EU Directive 2002/91/EC	