



CHASE APARTMENTS
LONDON



Maine Tower, 9 Harbour Way, Canary Wharf E14 9DX

£3,250 Per Month

- 24H CONCIERGE
- PRIVATE BALCONY
- CINEMA
- FULLY FURNISHED
- VIDEO VIEWING AVAILABLE
- RESIDENCE LOUNGE
- GYM
- 2 BEDROOMS 2 BATHROOMS
- MEETING ROOMS
- WALKING DISTANCE TO CANARY WHARF

Grosvenor Waterside, 32 Gatliff Road, Belgravia, London, SW1W 8QN
02077225022

<http://www.chaseapartments.com/>



Maine Tower, E14

Approximate Gross Internal Area = 78.9 sq m / 849 sq ft

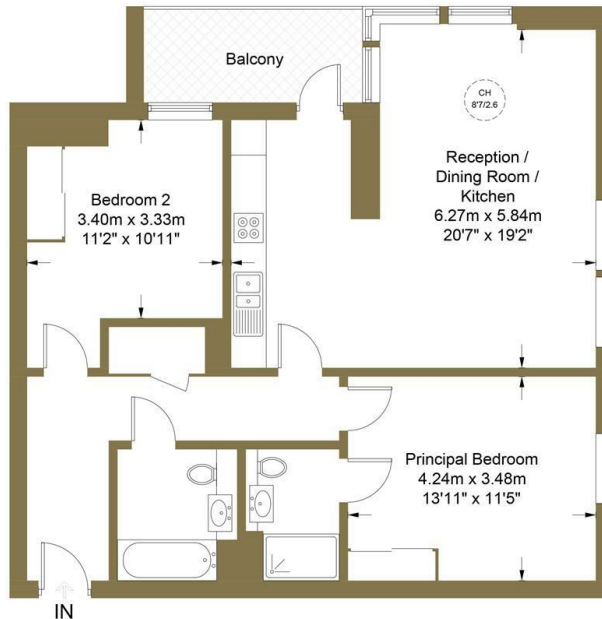

Fourth Floor



This plan is for layout guidance only. Not drawn to scale unless stated. Windows and door openings are approximate. Whilst every care is taken in the preparation of this plan, please check all dimensions, shapes and compass bearings before making any decisions reliant upon them. (ID983315)



Viewings

Viewings by arrangement only.
Call 02077225022 to make an appointment.

Council Tax Band

C

EPC Rating:

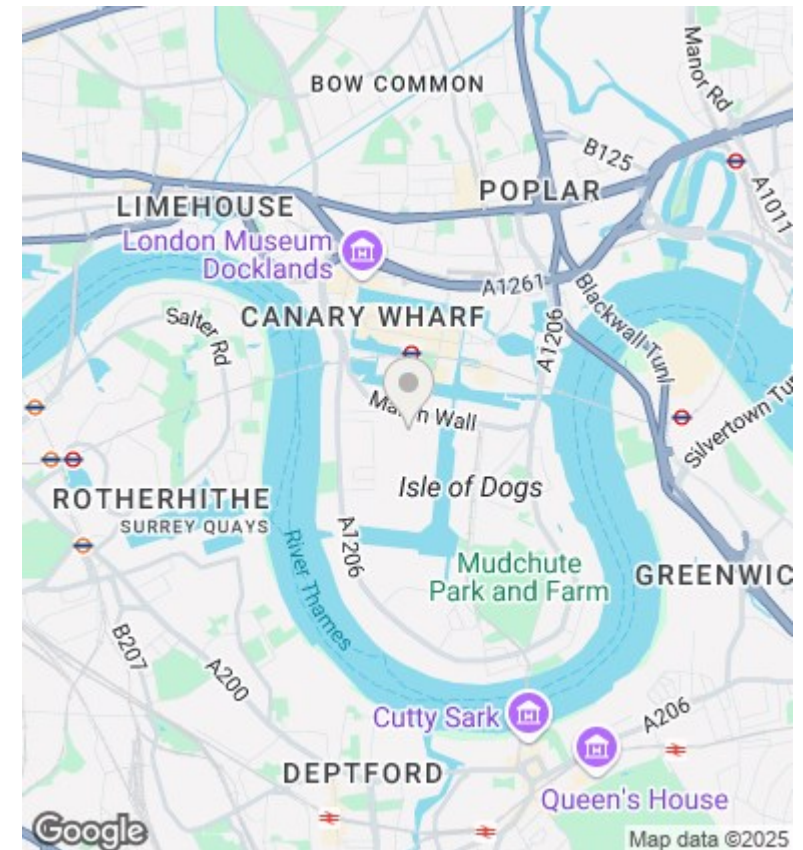

Energy Efficiency Rating		
	Current	Potential
Very energy efficient - lower running costs		
(92 plus) A		
(81-91) B		
(69-80) C		
(55-68) D		
(39-54) E		
(21-38) F		
(1-20) G		
Not energy efficient - higher running costs		
England & Wales	EU Directive 2002/91/EC	