

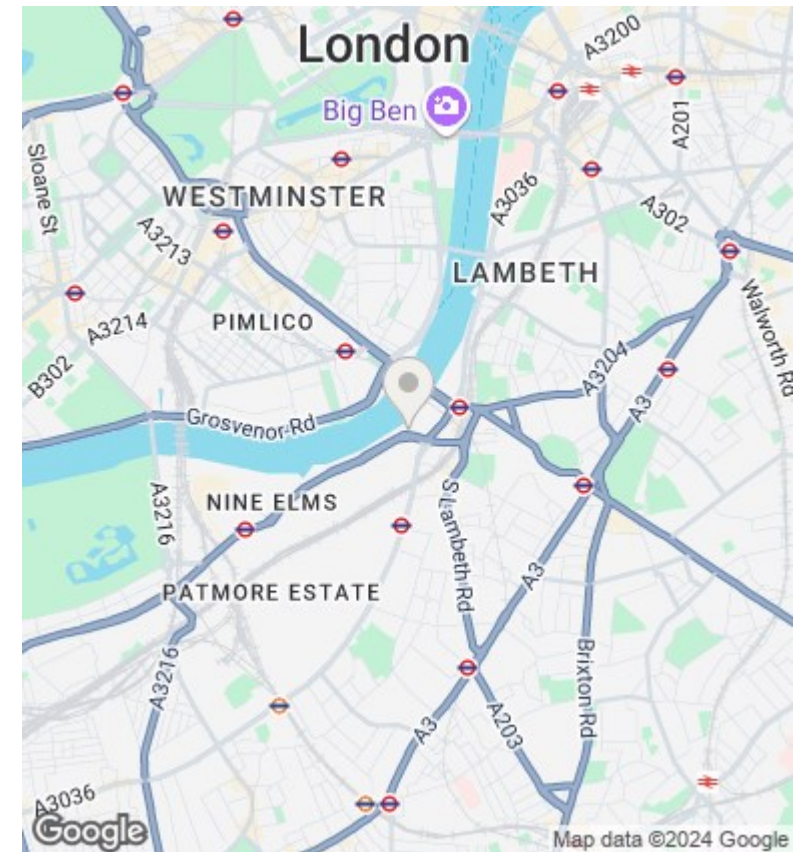

## The Tower , 1 St George Wharf , Vauxhall SW8 2BW

£7,999 Per Month

- 24/7 concierge
- cinema
- under floor heating
- minutes away from Vauxhall Tube station
- gym and spa
- dining room / meeting room
- air cooling
- swimming pool overlooking river
- business lounge
- river views

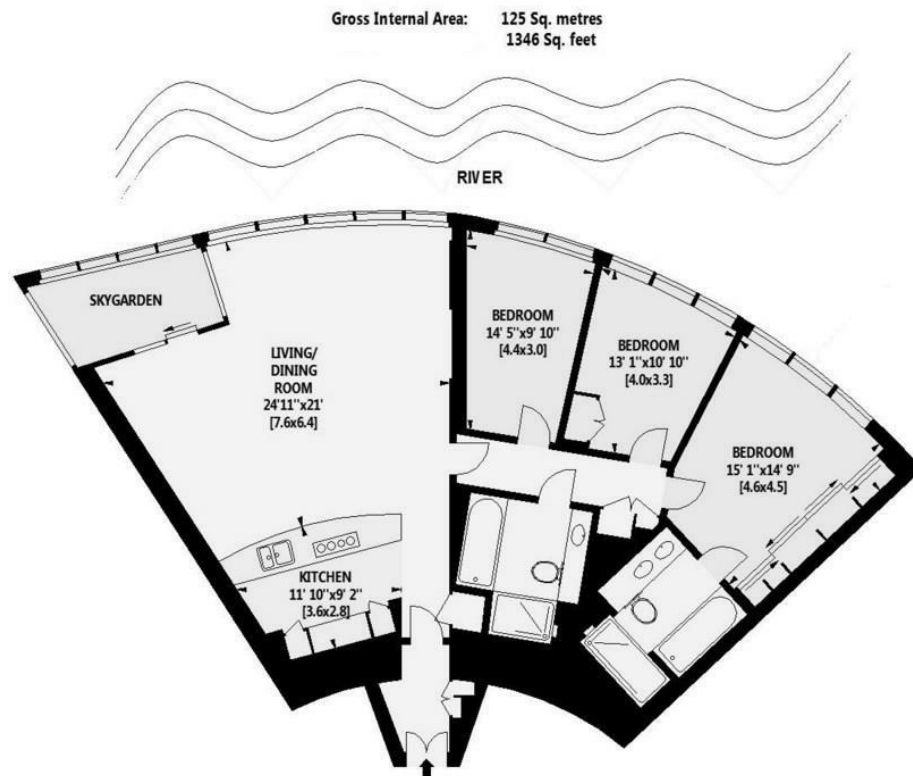

## Viewings

Viewings by arrangement only.  
Call 02077225022 to make an appointment.

## Council Tax Band

H

## EPC Rating:

Energy Efficiency Rating		
	Current	Potential
<i>Very energy efficient - lower running costs</i>		
(92 plus) <b>A</b>		
(81-91) <b>B</b>		
(69-80) <b>C</b>		
(55-68) <b>D</b>		
(39-54) <b>E</b>		
(21-38) <b>F</b>		
(1-20) <b>G</b>		
<i>Not energy efficient - higher running costs</i>		
<b>England &amp; Wales</b>	EU Directive 2002/91/EC	