



The Tower , St George Wharf , Vauxhall SW8 2BW

£2,300,000

- 24 Hour concierge
- swimming pool overlooking river
- residence lounge
- underfloor heating and air cooling
- video viewing available
- smart home system
- dining room / meeting room
- gym and spa
- cinema
- allocated parking space

The Tower

Approximate Gross Internal Area = 1452 sq ft / 134.9 sq m

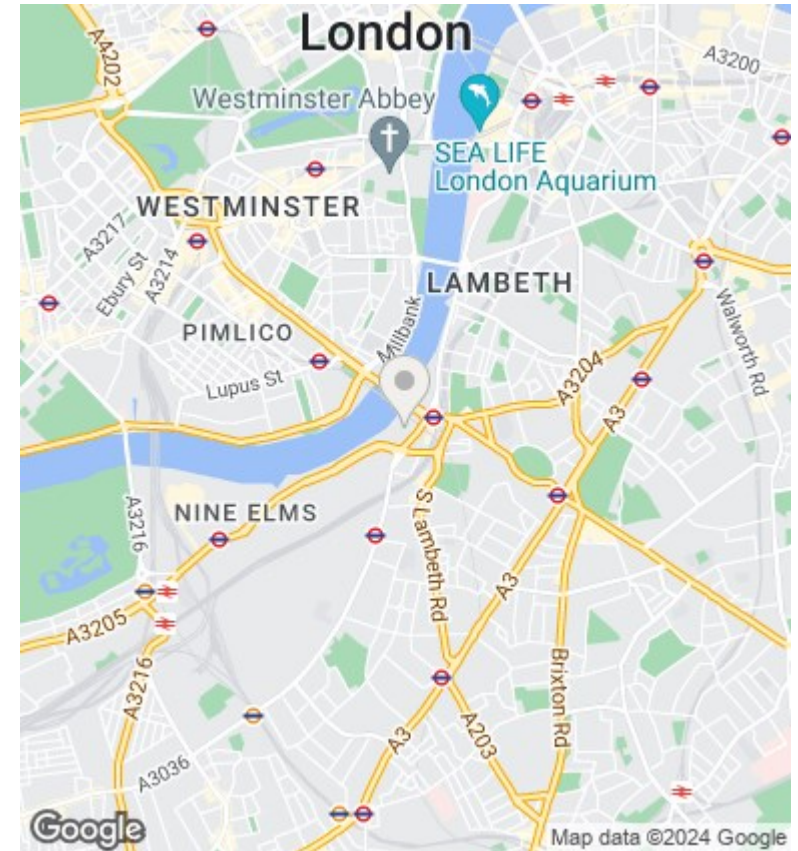
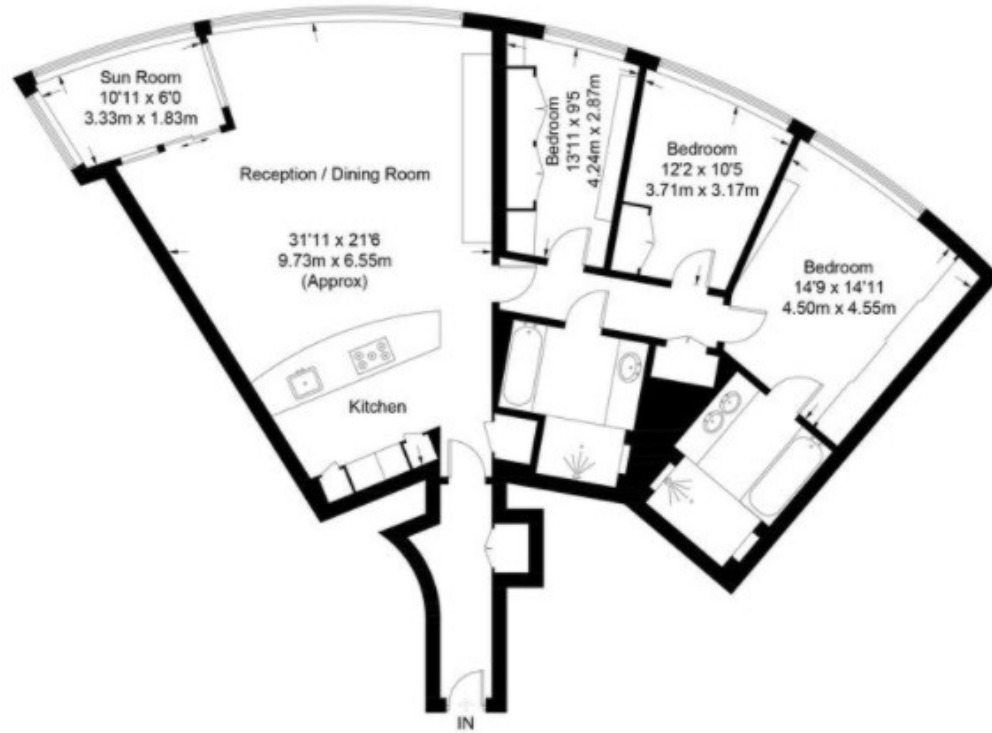

Viewings

Viewings by arrangement only.
Call 02077225022 to make an appointment.

Council Tax Band

EPC Rating:

Energy Efficiency Rating		
	Current	Potential
<i>Very energy efficient - lower running costs</i>		
(92 plus) A		
(81-91) B		
(69-80) C		
(55-68) D		
(39-54) E		
(21-38) F		
(1-20) G		
<i>Not energy efficient - higher running costs</i>		
England & Wales	EU Directive 2002/91/EC	