

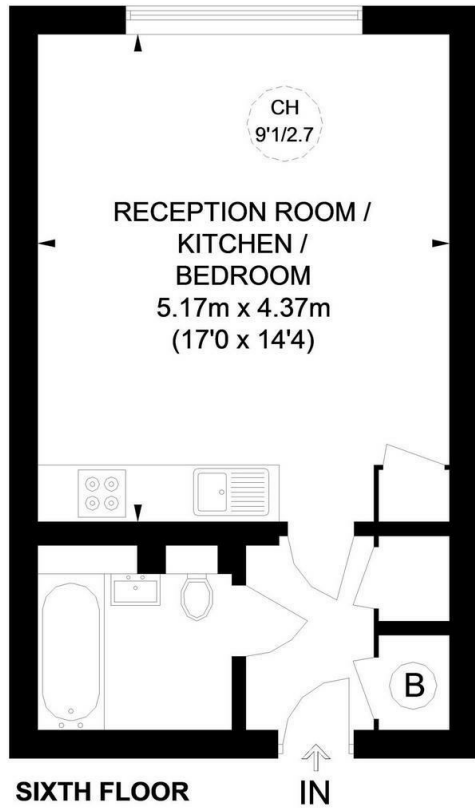

## Cubitt, Grosvenor Waterside SW1W 8QL

£1,993 PCM

- 24 Hour concierge
- Available now
- 339 sq foot
- Located on 6th floor
- Residents Spa & Gym
- Walking distance to Sloane Square & Victoria Station
- Studio Apartment
- Located on the 6th floor
- Fully Furnished
- Open plan living room



## CUBITT BUILDING

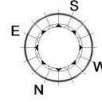

APPROXIMATE GROSS INTERNAL AREA  
345 SQ. FT. (32.1 SQ. M.)



This plan is for layout guidance only. Not drawn to scale unless stated. Windows and door openings are approximate. Whilst every care is taken in the preparation of this plan, please check all dimensions, shapes and compass bearings before making any decisions reliant upon them. Please be advised that Countrywide / our agents have not seen or reviewed any building regulations or planning permission in relation to works carried out to the property (ID574530)

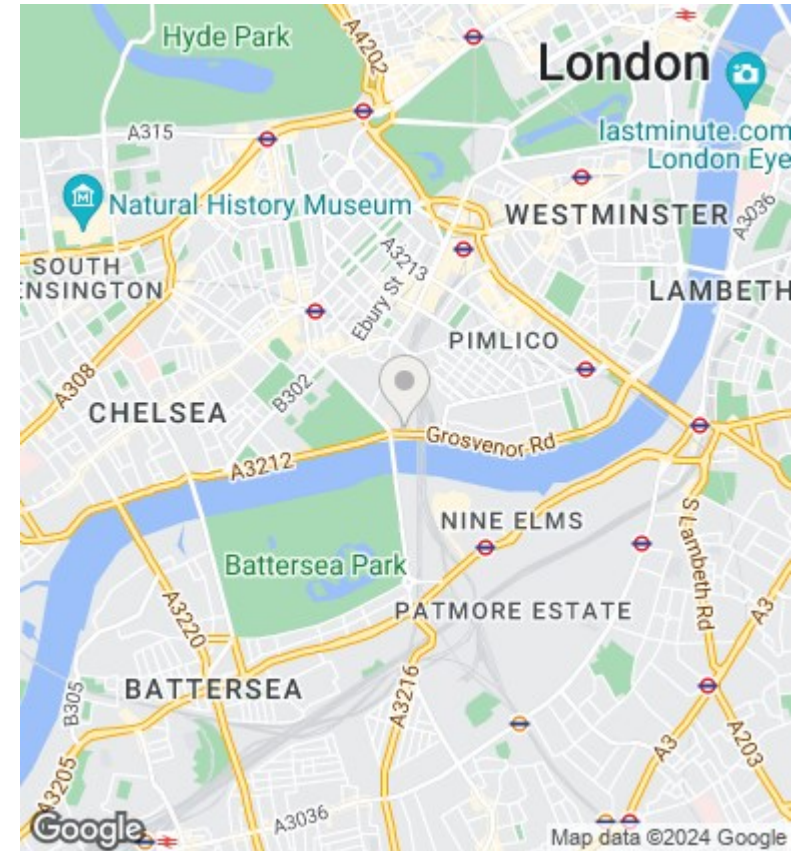

## Viewings

Viewings by arrangement only.  
Call 02077225022 to make an appointment.

## Council Tax Band

E

## EPC Rating:

B

Energy Efficiency Rating		Current	Potential
<i>Very energy efficient - lower running costs</i>			
(92 plus) <b>A</b>			
(81-91) <b>B</b>		85	87
(69-80) <b>C</b>			
(55-68) <b>D</b>			
(39-54) <b>E</b>			
(21-38) <b>F</b>			
(1-20) <b>G</b>			
<i>Not energy efficient - higher running costs</i>			
<b>England &amp; Wales</b>		EU Directive 2002/91/EC	