

Grosvenor Waterside, Gatliff Road, London, SW1W 8QP SW1W 8QP

£4,116 Per Month

- 870 Sq foot
- Secure Underground Parking
- Dock facing balcony
- 2 Bathrooms (1 ensuite)
- 24 Hour Concierge
- Walking distance to Sloane Square & Battersea Power Station
- Air cooling
- Spa & Residents Gym
- Fully Furnished
- 2 Double bedrooms

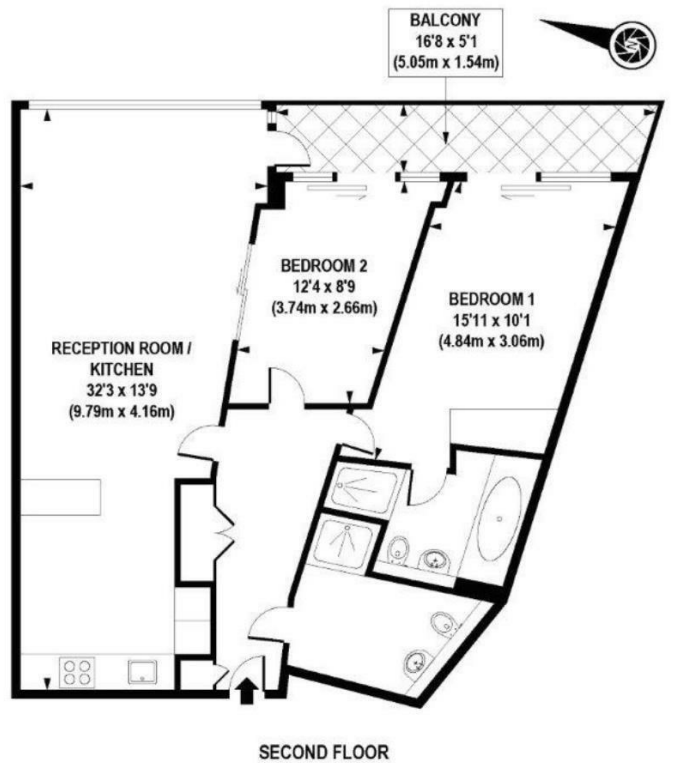

APPROX. GROSS INTERNAL FLOOR AREA 870 sq. ft / 80.69 sq. m

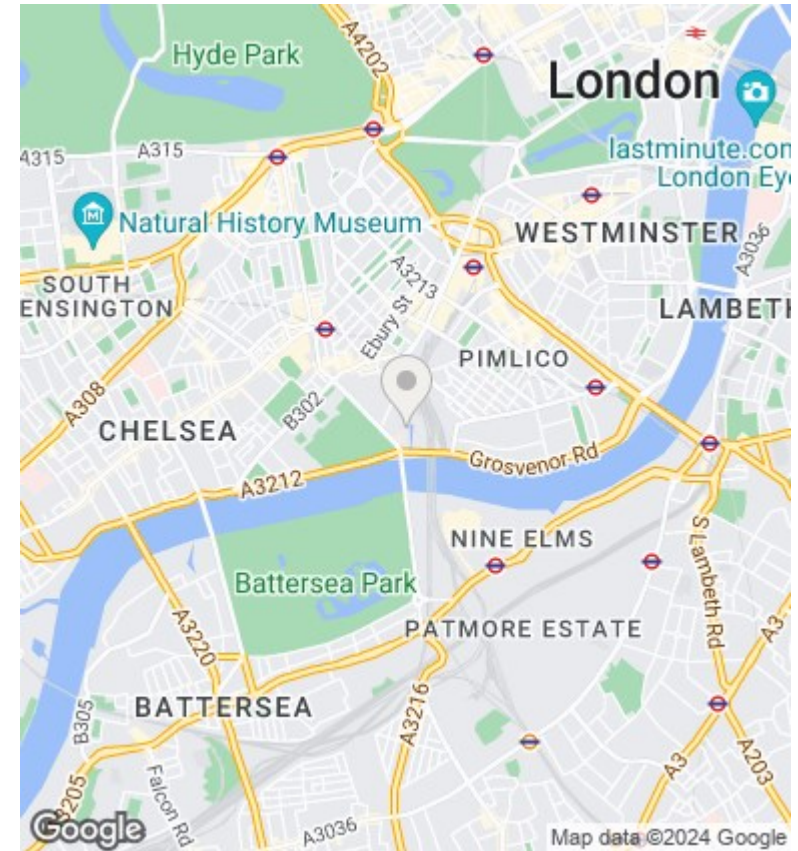

Viewings

Viewings by arrangement only.
Call 02077225022 to make an appointment.

Council Tax Band

F

EPC Rating:

B

Energy Efficiency Rating		
	Current	Potential
Very energy efficient - lower running costs		
(92 plus) A		
(81-91) B	85	85
(69-80) C		
(55-68) D		
(39-54) E		
(21-38) F		
(1-20) G		
Not energy efficient - higher running costs		
England & Wales	EU Directive 2002/91/EC	