

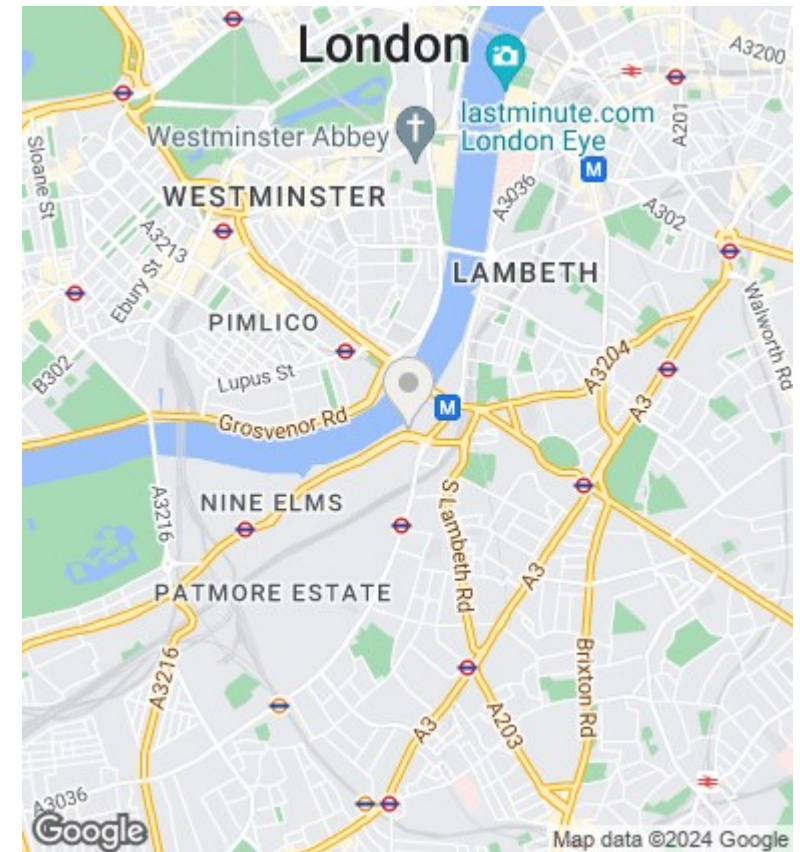

The Tower, 1 St. George Wharf, London, SW8 SW8 2DU

£7,800 PCM

- 180° River Views
- Open-Plan Kitchen
- Fitness and Spa
- Parking Included
- Spacious Double Bedrooms
- 24/7 Concierge
- Private Cinema Access
- Elegant Marble Bathrooms
- Exclusive Lifestyle
- Prime London Location

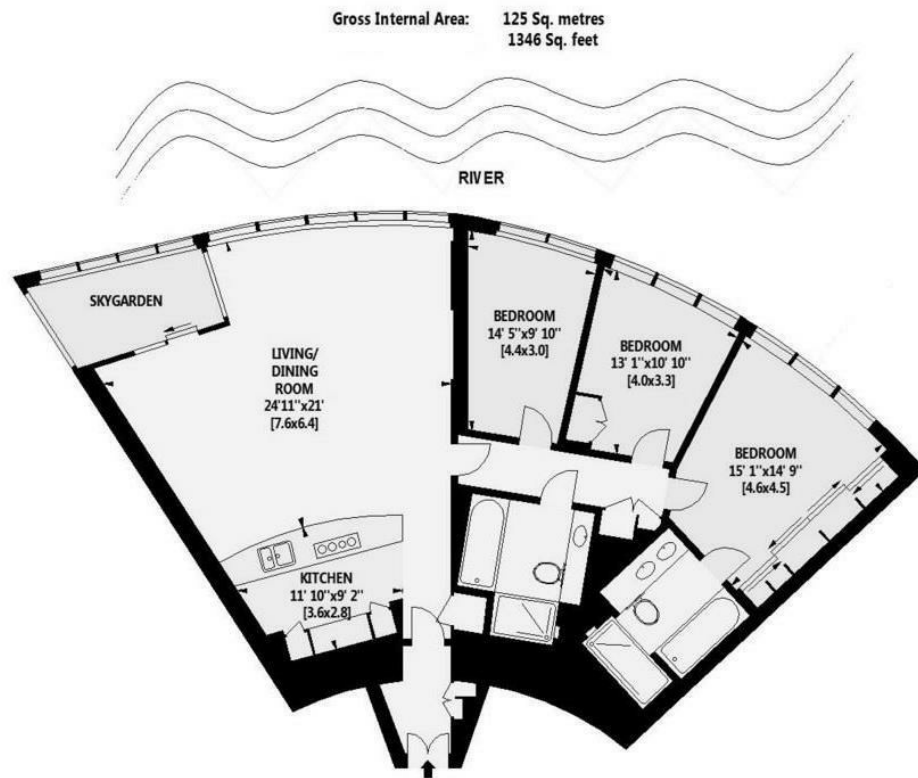

Viewings

Viewings by arrangement only.
Call 02077225022 to make an appointment.

Council Tax Band

H

EPC Rating:

B

Energy Efficiency Rating		Current	Potential
<i>Very energy efficient - lower running costs</i>			
(92 plus)	A		
(81-91)	B	85	85
(69-80)	C		
(55-68)	D		
(39-54)	E		
(21-38)	F		
(1-20)	G		
<i>Not energy efficient - higher running costs</i>			
England & Wales		EU Directive 2002/91/EC	