

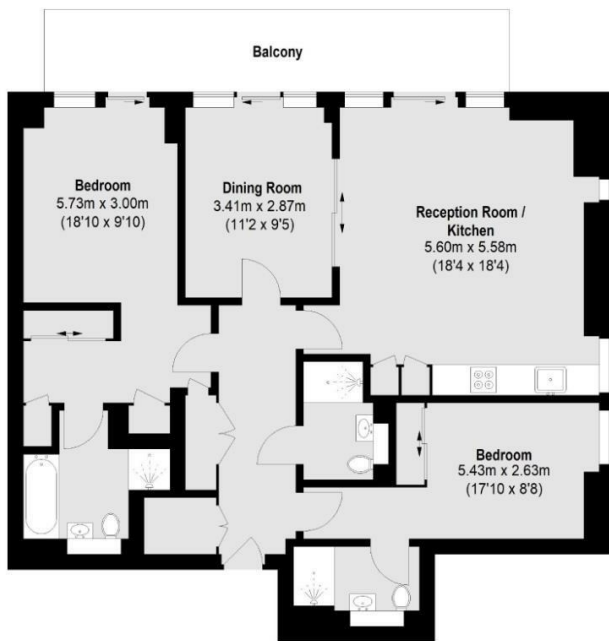

Hepworth Court , Grosvenor waterside , Gatliff Road SW1W 8QP

£1,495,000

- 24/7 concierge
- Walking distance to Victoria and Sloane Square station
- 3 bathrooms
- video viewing available
- allocated Underground Parking
- moments away from Battersea Park
- air cooling and under floor heating
- large private balcony
- onsite food shop and restaurant / coffee shop



Sixth Floor
 Total area (approx.): 100.61 sq. m (1083 sq. ft)
 Balcony: 14.48 sq. m (156 sq. ft)

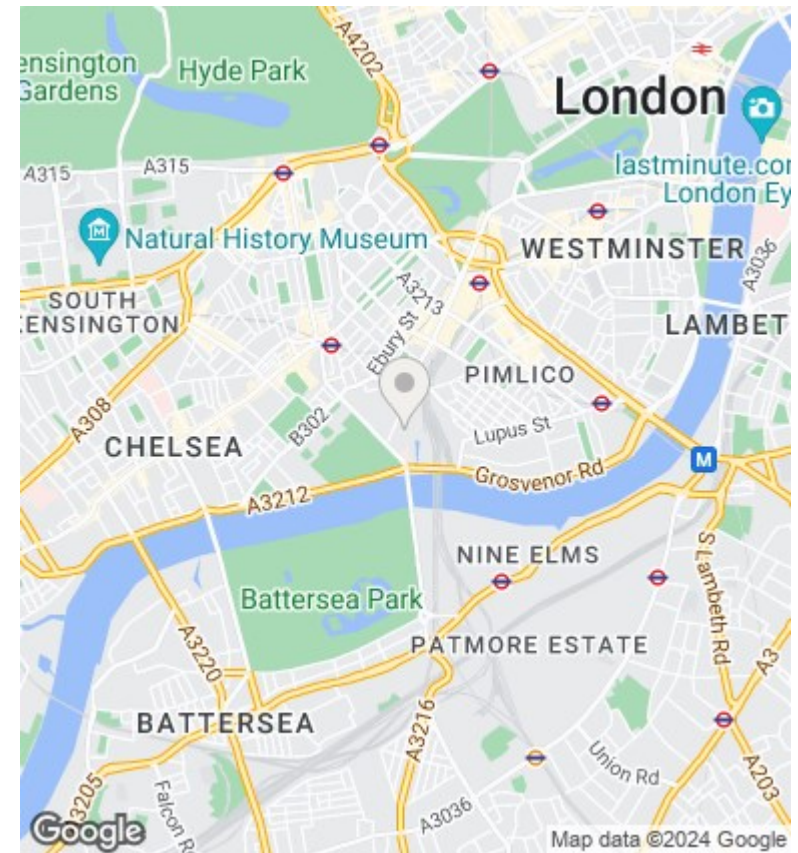

Viewings

Viewings by arrangement only.
 Call 02077225022 to make an appointment.

Council Tax Band

H

EPC Rating:

B

Energy Efficiency Rating		Current	Potential
<i>Very energy efficient - lower running costs</i>			
(92 plus) A			
(81-91) B		82	83
(69-80) C			
(55-68) D			
(39-54) E			
(21-38) F			
(1-20) G			
<i>Not energy efficient - higher running costs</i>			
England & Wales		EU Directive 2002/91/EC	