

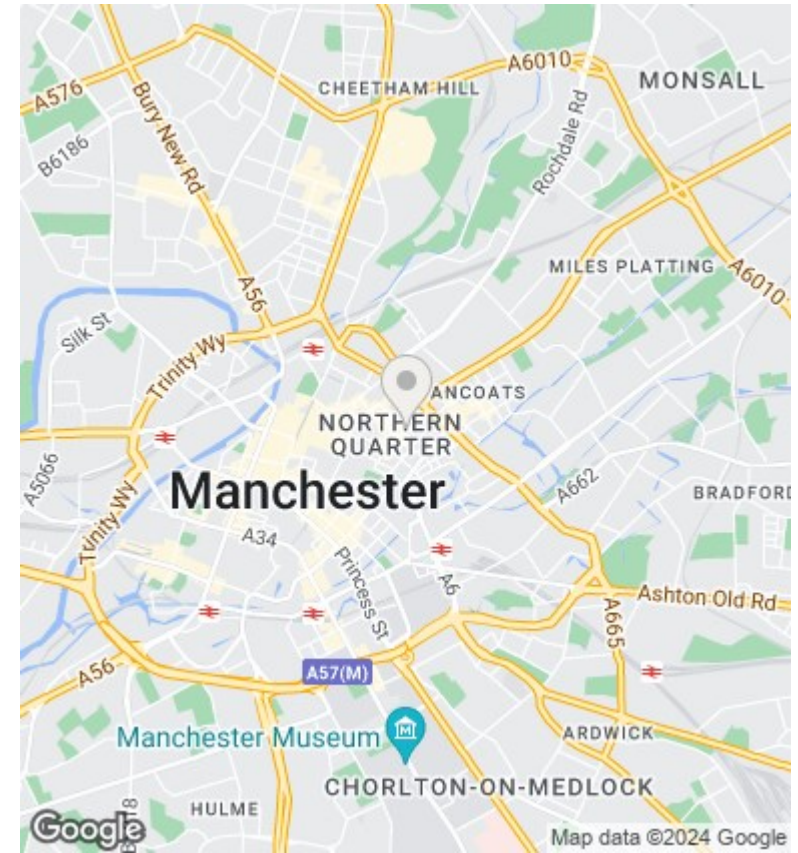

Oldham Street, Manchester M4 1LE

Offers Over £1,950,000

- Rare City Centre Freehold opportunity
- Existing building over 7000sq ft
- Development Opportunity subject to usual consents
- Highly popular Northern Quarter location
- Walking distance to Manchester Picadilly and Victoria station
- Total land size approx 11,000 sq ft
- Possible conversion to residential subject to usual consents

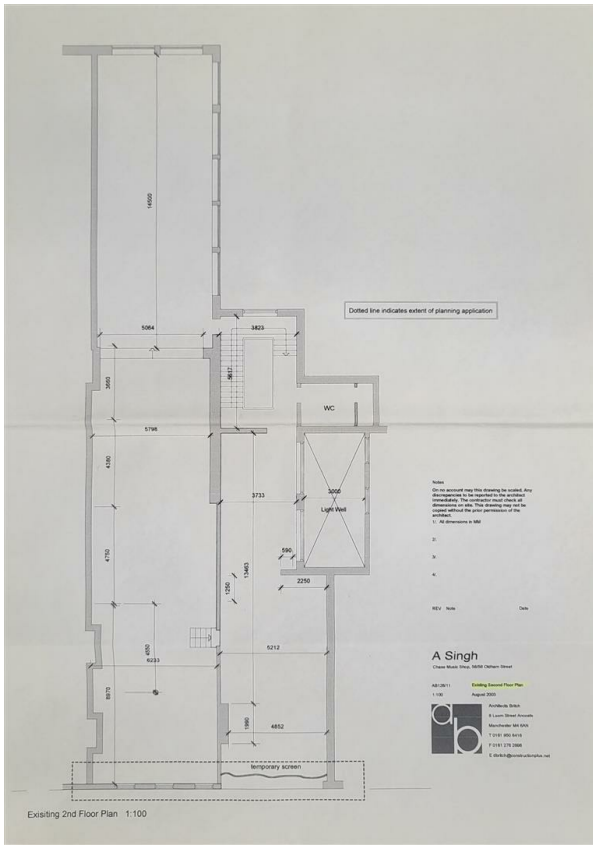

Viewings

Viewings by arrangement only.
 Call 02077225022 to make an appointment.

Council Tax Band

G

EPC Rating:

| Energy Efficiency Rating | | Current | Potential |
|--|--|-------------------------|-----------|
| <i>Very energy efficient - lower running costs</i> | | | |
| (92 plus) A | | | |
| (81-91) B | | | |
| (69-80) C | | | |
| (55-68) D | | | |
| (39-54) E | | | |
| (21-38) F | | | |
| (1-20) G | | | |
| <i>Not energy efficient - higher running costs</i> | | | |
| England & Wales | | EU Directive 2002/91/EC | |