

The Tower, 1 St. George Wharf, London, SW8 SW8 2DU

Asking Price £695,000

- 24 Hour Concierge
- Located on 2nd floor
- 612 sq. ft.
- Gym & Spa
- Exclusive Waterside development
- One bedroom
- Cinema Room
- Business Meeting rooms
- Walking distance to Vauxhall tube station



The Tower, SW8

Approximate Gross Internal Area = 56.9 sq m / 612 sq ft

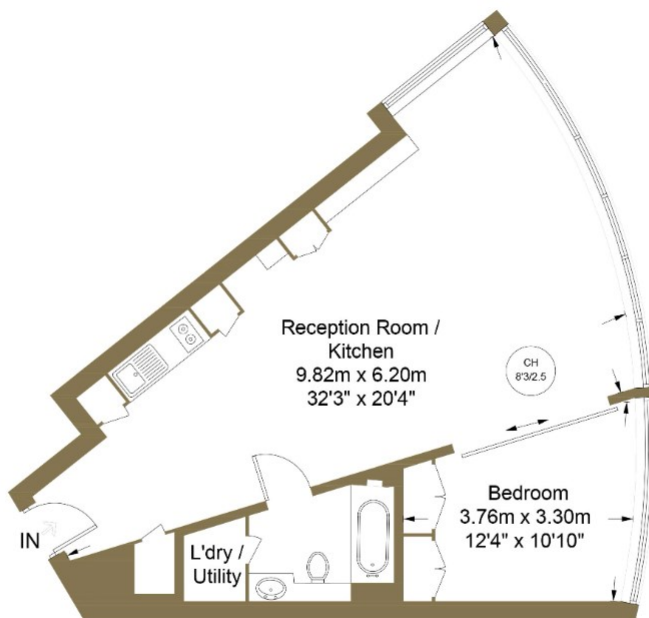

Second Floor

This plan is for layout guidance only. Not drawn to scale unless stated. Windows and door openings are approximate. Whilst every care is taken in the preparation of this plan, please check all dimensions, shapes and compass bearings before making any decisions reliant upon them. (ID909514)

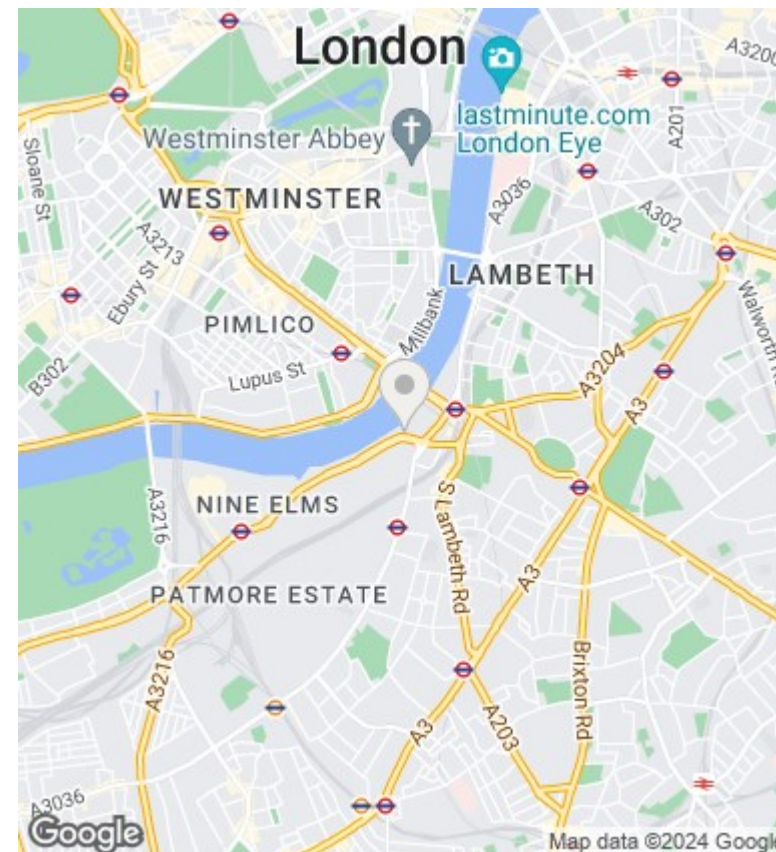

Viewings

Viewings by arrangement only.
Call 02077225022 to make an appointment.

Council Tax Band

F

EPC Rating:

Energy Efficiency Rating		
	Current	Potential
<i>Very energy efficient - lower running costs</i>		
(92 plus) A		
(81-91) B		
(69-80) C		
(55-68) D		
(39-54) E		
(21-38) F		
(1-20) G		
<i>Not energy efficient - higher running costs</i>		
England & Wales	EU Directive 2002/91/EC	