

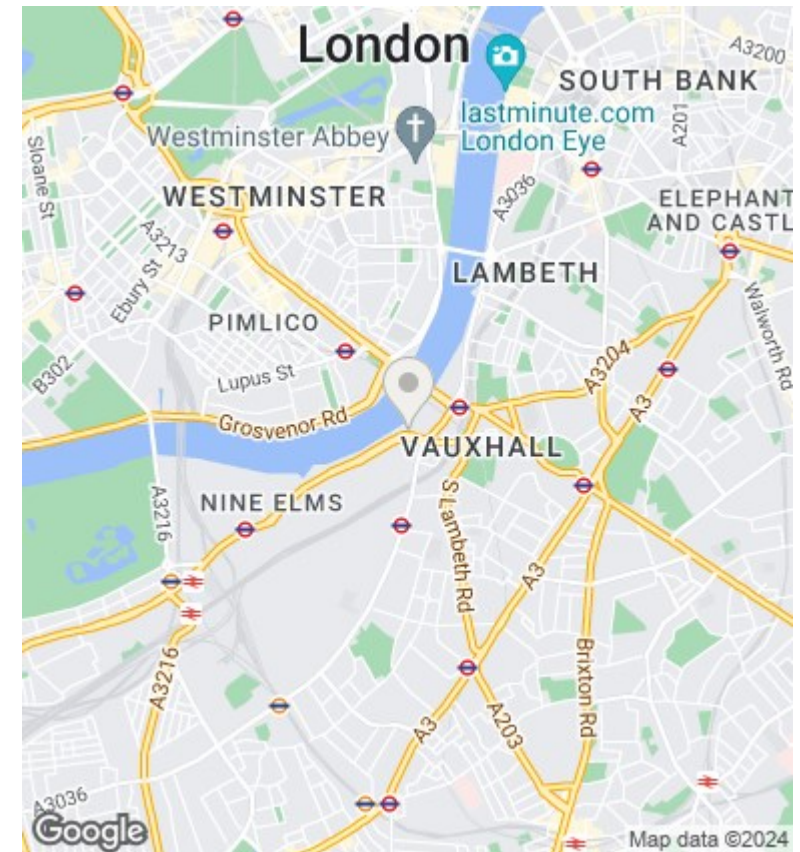

The Tower , St George Wharf , Vauxhall SW8 2DA

£2,350,000

- 24/7 concierge
- business lounge
- smart home system
- swimming pool overlooking river
- dining room / meeting room
- parking space
- gym and spa
- air cooling and under floor heating
- gated development

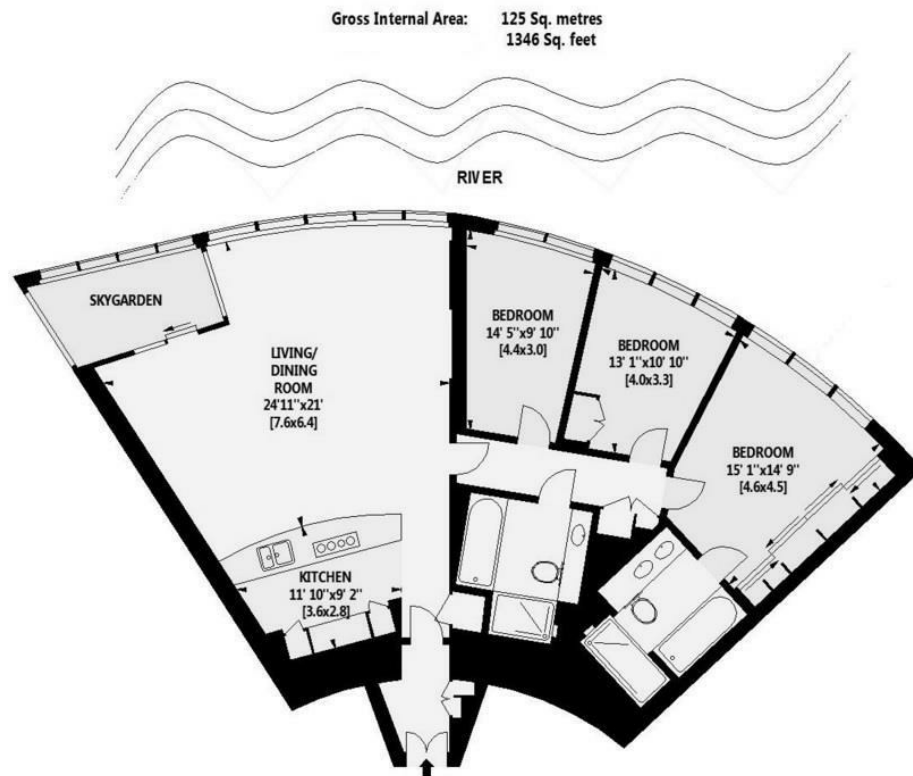

Viewings

Viewings by arrangement only.
Call 02077225022 to make an appointment.

Council Tax Band

H

EPC Rating:

B

Energy Efficiency Rating		Current	Potential
<i>Very energy efficient - lower running costs</i>			
(92 plus) A			
(81-91) B		84	84
(69-80) C			
(55-68) D			
(39-54) E			
(21-38) F			
(1-20) G			
<i>Not energy efficient - higher running costs</i>			
England & Wales		EU Directive 2002/91/EC	