

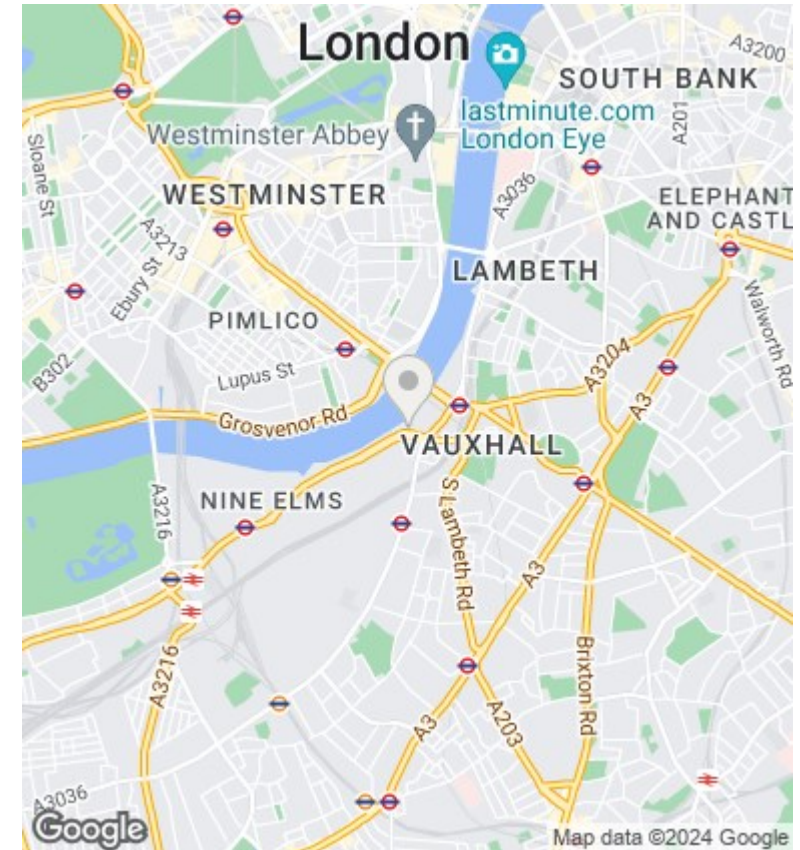

The Tower, 1 St George Wharf, Vauxhall SW8 2DU

£1,999,950

- 24/7 concierge
- VIDEO VIEWING AVAILABLE
- dining / meeting room
- SWIMMING POOL OVERLOOKING RIVER
- 24 HOUR CONCIERGE
- cinema
- DINNING / MEETING ROOM
- gym/spa
- DIRECT RIVER VIEWS
- business lounge

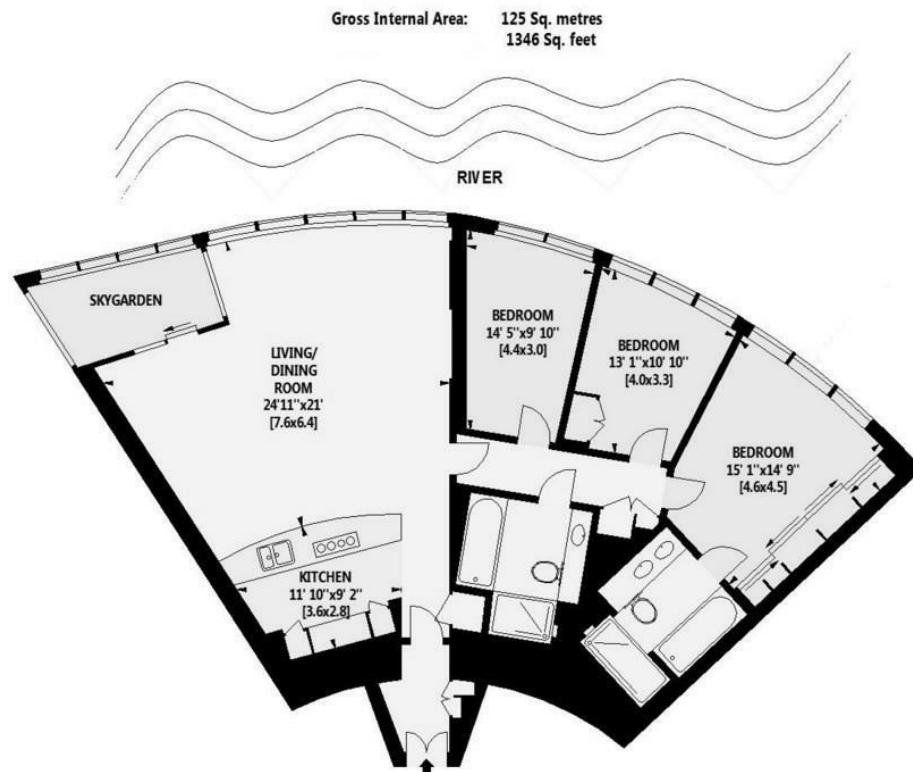

Viewings

Viewings by arrangement only.
Call 02077225022 to make an appointment.

Council Tax Band

H

EPC Rating:

B

| Energy Efficiency Rating | | Current | Potential |
|--|---|-------------------------|-----------|
| <i>Very energy efficient - lower running costs</i> | | | |
| (92 plus) | A | | |
| (81-91) | B | 84 | 84 |
| (69-80) | C | | |
| (55-68) | D | | |
| (39-54) | E | | |
| (21-38) | F | | |
| (1-20) | G | | |
| <i>Not energy efficient - higher running costs</i> | | | |
| England & Wales | | EU Directive 2002/91/EC | |