



Tolcarne Drive, Pinner, HA5 2DH

**£1,400 PCM**

We are pleased to offer for rent this bright and modern one bedroom flat in Northwood Hills

The property comprises of one large double bedroom and a bathroom with "shower-over" bath. The reception room opens onto a separate and fully fitted kitchen. The property benefits from gas central heating and double glazed windows.

Resident street parking is available directly outside the property.

The flat is located in the heart of Northwood Hills, which benefits from excellent transport links, with Northwood Hills Station a short walk away affording easy access into Central London in approx. 30 mins. In addition, just around the corner is the High Street with a range of local shops, restaurants and bars. Close by are a number of "open spaces" for recreation and the highly sought after Harlyn Primary School.

The property is available from 19th July.

- One Bedroom Flat
- Large Double Bedroom
- Separate Kitchen
- Close to Shops and Train Station
- Double Glazed & Energy Efficient
- Gas Central Heating
- Parks Close By
- Available 19th July 2025

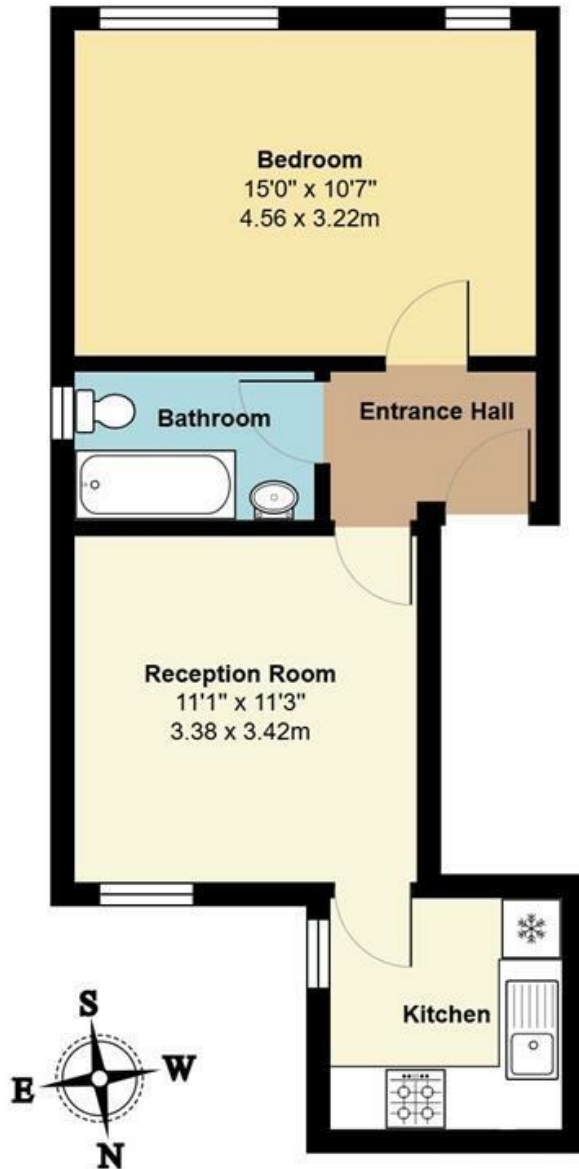

**First Floor**  
Area: 424 ft<sup>2</sup> ... 39.4 m<sup>2</sup>

Total Area: 424 ft<sup>2</sup> ... 39.4 m<sup>2</sup>

All measurements are approximate and for display purposes only

**SUSMANS**  
ESTATES

## VIEWING

Strictly by appointment with Susmans Estates

**Tel:** 01923 859444

**299 Watling Street**  
**Radlett**  
**WD7 7LA**

## E-mail:

office@susmansestates.com

## Website:

susmansestates.com

Ref:

