



**27 Beconsall Drive**

CW1 4RU

**£240,000**



3



1



1



D



STEPHENSON BROWNE



This beautiful home is tucked nicely behind an open plan lawn with driveway to the side providing invaluable off road parking. Nestled on Becconsall Drive, this lovely home offers a perfect blend of comfort and style, contemporary, bright and spacious throughout. As you approach the property, you will be greeted by an immaculate exterior that sets the tone for what lies within.

Upon entering, you will find a welcoming entrance with stairs off. The great size lounge provides a warm and inviting atmosphere, ideal for both relaxation and entertaining. The heart of the home is the fitted kitchen diner, which features a lovely range of units which provide ample storage, there is also space for a dining table to allow the family to gather for meals whilst reflecting on the days activities. To the rear of the garage a utility space has been created keeping all the household chores out of the kitchen, providing additional convenience for your daily needs.

On the first floor the property features three spacious bedrooms, each designed to offer a peaceful retreat at the end of the day. The layout ensures that there is plenty of room for family members or guests, making it a perfect choice for those seeking a comfortable living environment. The accommodation is completed by the bathroom.

One of the standout features of this home is the lovely landscaped enclosed garden. This outdoor space is perfect for enjoying the fresh air, hosting summer barbecues, or simply unwinding in a tranquil setting.

Overall, this immaculate detached house is a wonderful opportunity for anyone looking to settle in a delightful area of Crewe. With its modern amenities and charming features, it is sure to impress those who value both style and functionality in their living space.

## Entrance Hall

**Lounge**  
13'1" x 10'11" (4.002m x 3.343m)

**Kitchen Diner**  
14'0" x 9'8" (4.268m x 2.968m)







**Garage/Utility**  
16'3" x 7'1" (4.955m x 2.178m)

**Stairs to First Floor**

**Bedroom One**  
12'0" x 8'3" (3.677m x 2.525m)

**Bedroom Two**  
8'0" x 7'3" (2.447m x 2.235m)

**Bedroom Three**  
7'7" x 5'4" (2.335m x 1.641m)

**Bathroom**  
6'3" x 5'9" (1.911m x 1.774m)

### **Externally**

The property stands within beautifully maintained gardens, the rear is enclosed providing a wonderful outdoor space, ideal for hosting bar be ques during the summer months.

### **Tenure**

We understand from the vendor that the property is freehold. We would however recommend that your solicitor check the tenure prior to exchange of contracts.

### **Need to Sell?**

For a FREE valuation please call or e-mail and we will be happy to assist.

### **Council Tax**

Band B



Floor Plan

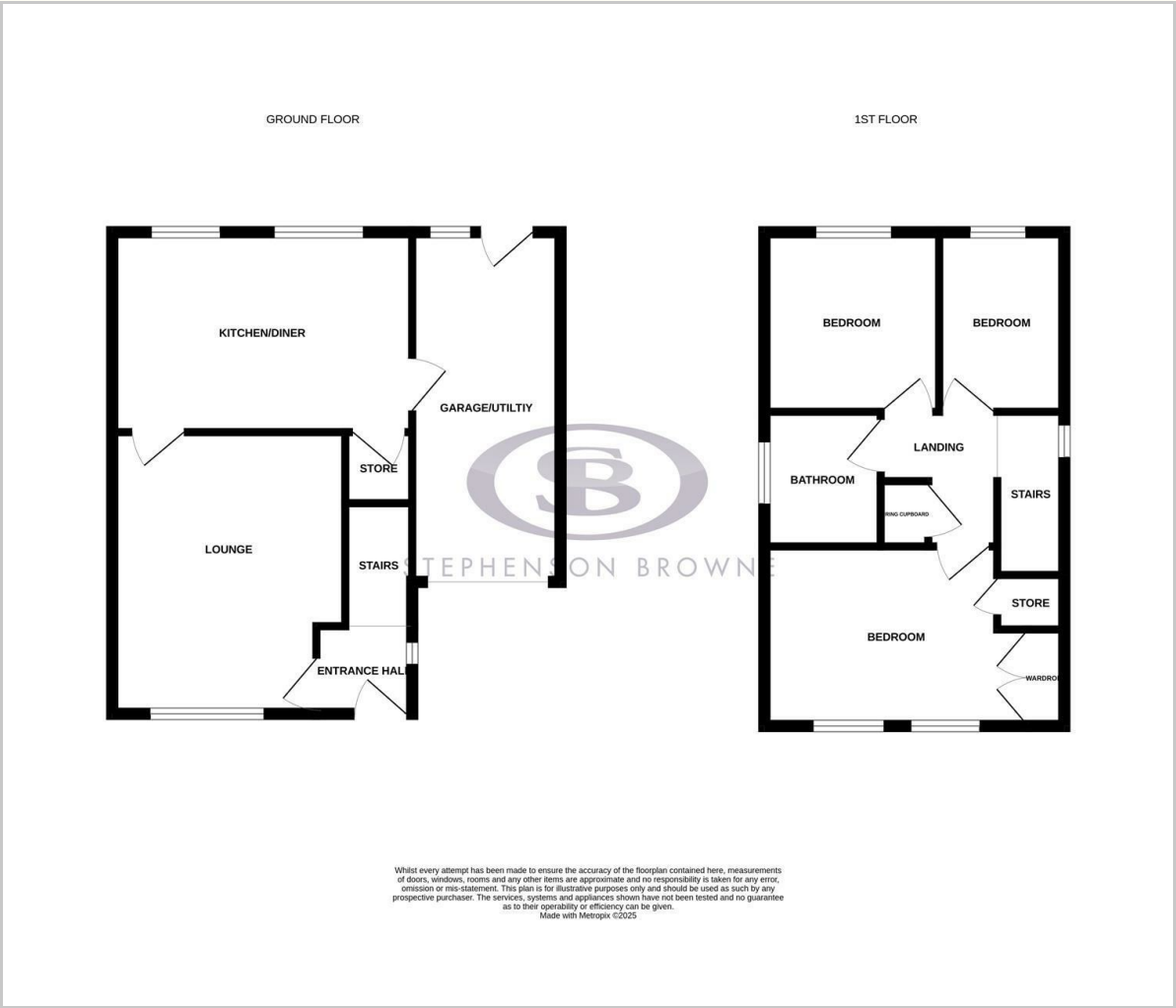

Viewing

Please contact our Crewe Sales Office on 01270 252545 if you wish to arrange a viewing appointment for this property or require further information.

Area Map

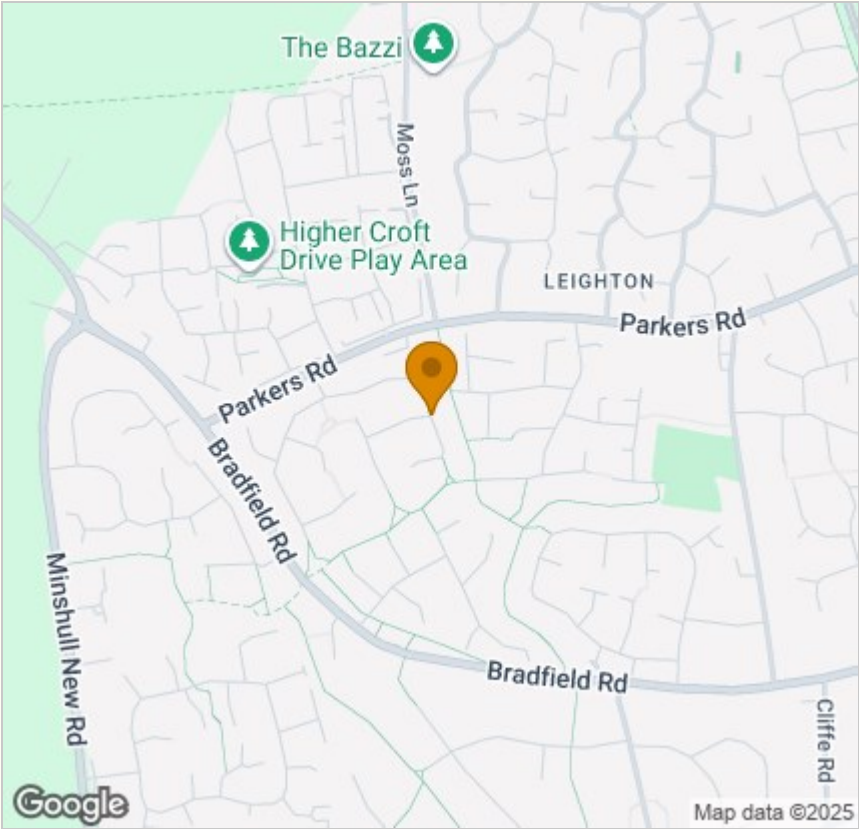

Energy Efficiency Graph

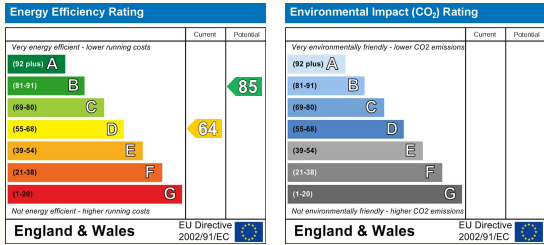

NOTICE: Stephenson Browne for themselves and for the vendors or lessors of this property whose agents they are give notice that: (1) the particulars are set out as a general guideline only for the guidance of intending purchasers or lessees, and do not constitute, nor constitute part of, an offer or contract; (2) all descriptions, dimensions, references to condition and necessary permissions for use and occupation, and other details are given in good faith and are believed to be correct but any intending purchasers or tenants should not rely on them as statements or representations of fact but must satisfy themselves by inspection or otherwise as to the correctness of each theme; (3) no person in the employment of Stephenson Browne has any authority to make representation or warranty whatever in relation to this property. (4) fixtures & fittings are subject to a formal list supplied by the vendors solicitors. **Referring to:** Move with Us Ltd **Average Fee:** £123.64

234 Nantwich Road, Crewe, Cheshire, CW2 6BP

T: 01270 252545 E: crewe@stephensombrowne.co.uk | www.stephensombrowne.co.uk