



**8 BERKELEY CRESCENT, WISTASTON, CREWE, CHESHIRE,
CW2 6QA**

OFFERS OVER £400,000

A gorgeous, beautifully presented and enviably positioned three bedroom traditional semi-detached home. Nestled onto a highly sought after road in the beautiful suburban locality of Wistaston, this excellent family home occupies a generous, larger than average plot and has been lovingly cared for.

The home opens with a traditional separate entrance hallway providing access to all rooms and stairs to first floor. Spacious bay fronted lounge with parquet flooring and leaded windows. Rear aspect dining room with French doors opening direct to the garden decking. Under-stairs and separate cupboard spaces for added versatility. Fitted kitchen with a comprehensive range of units with work surfaces, side bay window aspect, separate utility area and downstairs WC.

To the first floor, a galleried landing offers potential for another bedroom, further to the existing three. Substantial principal bedroom with bay window front, double secondary bedroom on the rear aspect and a well sized single room. High specification luxury fitted shower room with rainfall shower head.

To the outside, the home is fronted by a substantial driveway providing off road parking for multiple vehicles via a gravel driveway. Secure gated tarmac area providing further parking, storage for bins and access to the single detached garage with light and power. Incredibly well presented front garden, with mature shrubbery to the front aspect providing excellent privacy from the front.

Leading around to the rear, there is a long South facing garden that benefits from multiple levels and seating areas, with a decked area immediately beyond the dining room French doors, block paved patio, with a further seating area at the side and a bar area, with light, power and external heating. The garden is also laid with a plethora of mature shrubs and plant life, further to established tree coverage from the rear most aspect. Array of spotlighting and outdoor sockets.

Perfect family home, an absolute must view!



Entrance Hallway
13'6" x 7'4"

Living Room
14'2" into bay x 12'4"

Dining Room
13'7" x 11'10"

Cupboard
4'5" x 3'3"

Kitchen
13'6" x 9'9" into bay

Utility Room
8'1" x 6'8"

Downstairs WC
4'9" x 3'3"

Galleried Landing
13'6" x 7'4"

Bedroom One
14'9" into bay x 12'4"

Bedroom Two
13'10" x 10'8"

Bedroom Three
9'2" x 7'9"

Shower Room
9'3" x 5'9"



- Spectacular Traditional Semi-Detached Residence
- Three Generously Proportioned Bedrooms
- Traditional Bay-Fronted Living Room
- Separate Dining Room with French Doors
- Fitted Kitchen with Breakfast Bar, Separate Utility Area and Downstairs WC
- Incredible Luxury Fitted Upstairs Shower Room
- Off Road Parking for Multiple Vehicles
- Huge Plot with South-Facing Rear Garden, Decking, Patio and Bar Area
- Detached Single Garage with Light and Power
- Highly Sought After, Desirable Wistaston Location







Floor Plan

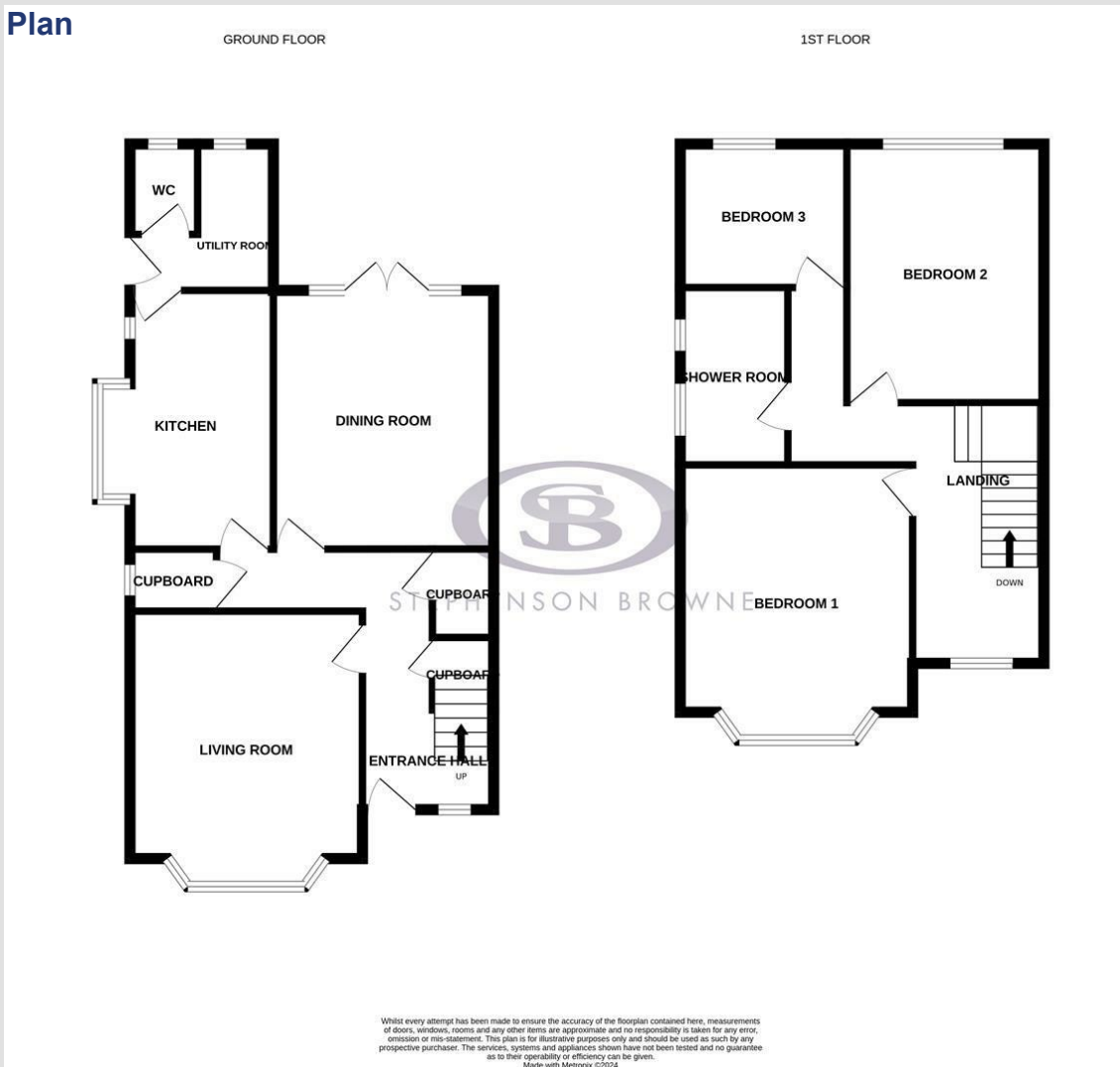

Area Map



Energy Efficiency Rating		Environmental Impact (CO ₂) Rating	
	Current	Potential	
Very energy efficient - lower running costs			Very environmentally friendly - lower CO ₂ emissions
(92 plus) A			(92 plus) A
(81-91) B			(81-91) B
(69-80) C			(69-80) C
(55-68) D			(55-68) D
(39-54) E			(39-54) E
(21-38) F			(21-38) F
(1-20) G			(1-20) G
Not energy efficient - higher running costs			Not environmentally friendly - higher CO ₂ emissions
England & Wales		EU Directive 2002/91/EC	England & Wales
			EU Directive 2002/91/EC

Viewing

Please contact our Newcastle Office on 01782 625734 if you wish to arrange a viewing appointment for this property or require further information.

NOTICE: Stephenson Browne for themselves and for the vendors or lessors of this property whose agents they are give note that: (1) the particulars are set out as a general guideline only for the guidance of intending purchasers or lessees, and do not constitute, nor constitute part of, an offer or contract; (2) all descriptions, dimensions, references to condition and necessary permissions for use and occupation, and other details are given in good faith and are believed to be correct but any intending purchasers or tenants should not rely on them as statements or representations of fact but must satisfy themselves by inspection or otherwise as to the correctness of each theme; (3) no person in the employment of Stephenson Browne has any authority to make representation or warranty in relation to this property; (4) fixtures and fittings are subject to a formal list supplied by the vendors solicitor. Referring to: Move with Us Ltd Average fee: £123.64

234 Nantwich Road, Crewe, Cheshire, CW2 6BP
 T: 01270 252545
 E: newcastle@stephensonbrowne.co.uk
 W: www.stephensonbrowne.co.uk