

Town & Country

Estate & Letting Agents



19, Castle Street, Oswestry, Shropshire, SY11 1JY

Available Soon! A TWO BEDROOM TERRACED PROPERTY which benefits from uPVC double glazing and gas central heating. The accommodation briefly comprises lounge, kitchen/diner and cloakroom to the ground floor, and two bedrooms and a bathroom to the first floor. Outside the property has off road parking and gardens to the front and a shared yard to the rear.) All deposits are held within the Deposit Protection Service (Custodial). All rentals require one months rent in advance and one months rent held for the deposit.

- Available Immediately
- Terraced Property
- Two Bedrooms
- Gas Central Heating
- uPVC Double Glazing
- Off Road Parking

£725 Per Month

Ground Floor



First Floor

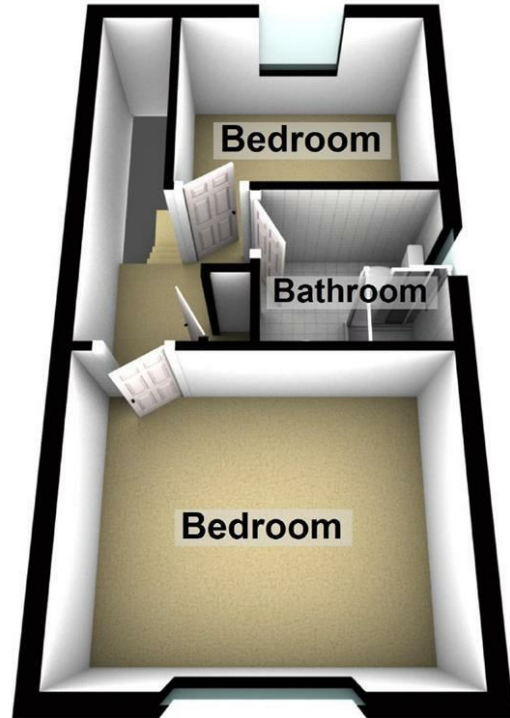

Energy Efficiency Rating		Current	Potential
<i>Very energy efficient - lower running costs</i>			
(92 plus) A			
(81-91) B			
(69-80) C			
(55-68) D		68	
(39-54) E			
(21-38) F			
(1-20) G			
<i>Not energy efficient - higher running costs</i>			
England & Wales	EU Directive 2002/91/EC		