



48 WELLINGTON PLACE

WILLENHALL, WV13 3AB

OFFERS IN THE REGION OF £150,000
FREEHOLD

NO CHAIN - Cash offers are sought for this two bedroom semi-detached bungalow requiring a scheme of modernisation. The property has a garage to the rear and internal accommodation comprising entrance hall, spacious living room, kitchen, two double bedrooms and bathroom. Lawned gardens to the front and rear.

Please note this property is unsuitable for Buy to Let mortgage lending.



48 WELLINGTON PLACE

- NO CHAIN • REQUIRES MODERNISATION • GARAGE TO REAR • TWO BEDROOMS • LAWNED REAR GARDEN



ENTRANCE HALL

LIVING ROOM

16'0" x 11'11"

Double-glazed window to the front, radiator.

KITCHEN

9'1" x 8'2"

Window to the front, doorway to the living room.

BEDROOM ONE

12'10" x 10'0"

Window to the rear, radiator.

BEDROOM TWO

10'2" x 9'9"

Window to the rear, radiator.

BATHROOM

Window to the side, radiator, pedestal wash hand basin, low-level w.c. and bath.

GARAGE

Accessed via Stonehouse Avenue to the rear and having a pedestrian door to the rear garden.

REAR GARDEN

Lawned garden to the rear and access to the rear of the garage.

COUNCIL TAX

Walsall Council - Tax Band B

TENURE Freehold

The property is freehold.

SERVICES

The agent understands that mains gas, electricity, water and drainage are available.

OTHER INFORMATION

The agent understands that a grant of probate / letters of administration have been applied for but are currently outstanding.

48 WELLINGTON PLACE



Ground Floor

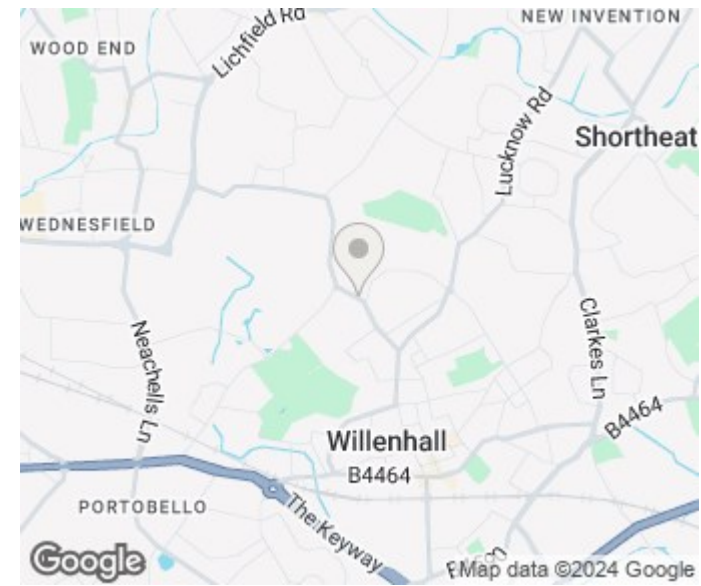
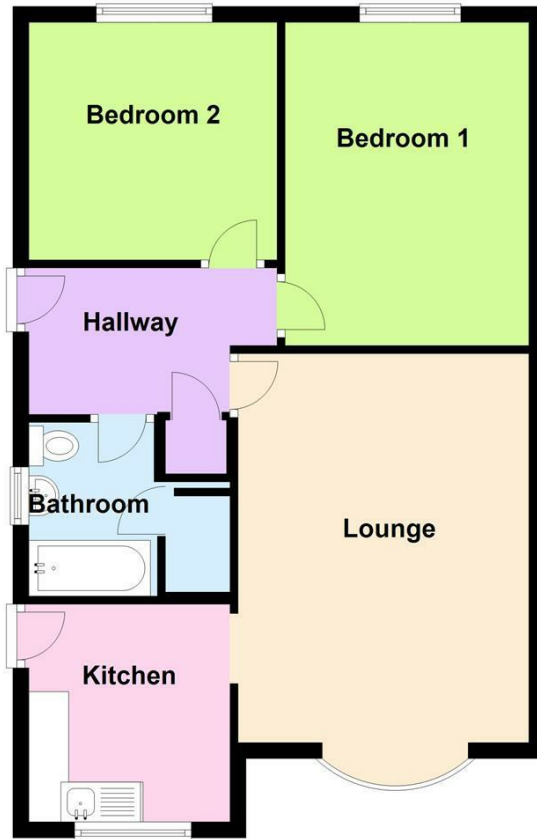

Energy Efficiency Rating		Current	Potential
<i>Very energy efficient - lower running costs</i>			
(92 plus) A			
(81-91) B			
(69-80) C			74
(55-68) D			
(39-54) E		43	
(21-38) F			
(1-20) G			
<i>Not energy efficient - higher running costs</i>			
England & Wales		EU Directive 2002/91/EC	



Sanders, Wright & Freeman - Sales
 13 Waterloo Road
 Wolverhampton
 West Midlands
 WV1 4DJ

01902 575555
 enquiries@swfestateagents.co.uk
 www.swfestateagents.co.uk

Agents Note: Whilst every care has been taken to prepare these particulars, they are for guidance purposes only. All measurements are approximate and are for general guidance purposes only and whilst every care has been taken to ensure their accuracy, they should not be relied upon and potential buyers/tenants are advised to recheck the measurements