



Foxhill Close, Hull, HU9

Asking Price £95,000













## Foxhill Close, Hull, HU9

Presenting a lovely semi-detached residence, now offered for sale with the distinct advantage of no onward chain. This property is an ideal acquisition for first-time buyers, featuring an entrance hall, lounge, and a kitchen/diner on the ground floor. Ascending to the upper level, one discovers two generously proportioned double bedrooms and a meticulously designed bathroom. The exterior boasts both a rear and front garden, completing this exceptional offering.

Situated on Foxhill Grove, just off Annandale Road, this property is in a highly convenient location, close to a wide range of amenities, including Heron Foods, Co-Op, and ALDI. Well-regarded schools such as Oldfleet Primary School and Aspire Academy are nearby. Additionally, excellent bus routes provide easy access to Hull City Centre and surrounding areas.

Score	Energy rating	Current	Potential
92+	A		
81-91	B		85 B
69-80	C		
55-68	D	67 D	
39-54	E		
21-38	F		
1-20	G		

### KEY FEATURES

- SEMI-DETACHED
- NO CHAIN
- 2 BEDROOMS
- CLOSE TO AMENITIES
- FREEHOLD
- FRONT & REAR GARDEN

# DETAILS

## Entrance Hall

With carpet flooring, radiator, stairs leading to the first floor and door leading to the lounge.

## Lounge

With carpet flooring, double glazed window, radiator and door leading to the kitchen/diner.

## Kitchen/Diner

With tiled flooring, laminate work surfaces, space for appliances, sink/drain, hob, oven, radiator, extractor fan, double glazed window and door leading to the rear garden.

## Bedroom 1

With carpet flooring, radiator, double glazed window and fitted wardrobes.

## Bedroom 2

With carpet flooring, radiator and double glazed window.

## Bathroom

With laminate flooring, bath tub, shower attachment, radiator, WC, wash hand vanity basin, light-up mirror and double glazed windows.

## Outside

Rear & front garden.

## Viewings

Strictly by appointment with selling agents. Please contact Wigwam Homes today to book your viewing.

## Fixtures & Fittings

Various fixtures and fittings may be available by separate negotiation and need to be confirmed prior to processing a formal offer.

## Free Market Appraisals / Property Valuations

We at Wigwam Homes are delighted to offer any homeowner a FREE no obligation valuation on your property. Call today to book! Interested in selling? We offer zero tie-in periods and no-sale NO-fee! Call us now on

01482 50 51 52 to book a valuation.

## Free Mortgage Consultations

At Wigwam Homes we have our own independent mortgage advisors with access to over 90 lenders. With so many mortgage products on the market, an independent advisor can show you all the various options and help you discover which one is right for you. We can also help with any property, income and personal insurances which you may need to complete your mortgage application.

## About Us

At Wigwam Homes we take pride in the success we achieve for our clients. Whether it is selling your properties, finding your forever home, searching for a long-term rental investment or looking to profit from onward selling, the Wigwam team is here to guide you through the housing market.

## Disclaimer

Here at Wigwam Homes we try to ensure that all information in the advertisements are correct. However, we do advise any potential buyers to conduct their own viewing. The Agent has not checked the legal documentation to verify legal status of the property or the validity of any guarantee. A buyer must assume the information is incorrect, until it has been verified by their own solicitors. The measurements supplied are for general guidance, and as such must be considered as incorrect. A buyer is advised to re-check the measurements themselves before committing. Nothing concerning the type of construction or the condition of the structure is to be implied from the photograph of the property. These details are prepared as a general guide only, and should not be relied upon as a basis to enter into a legal contract, or to commit expenditure. An interested party should consult their own surveyor, solicitor or other professionals before committing themselves to any expenditure.



Approx Gross Internal Area  
67 sq m / 717 sq ft

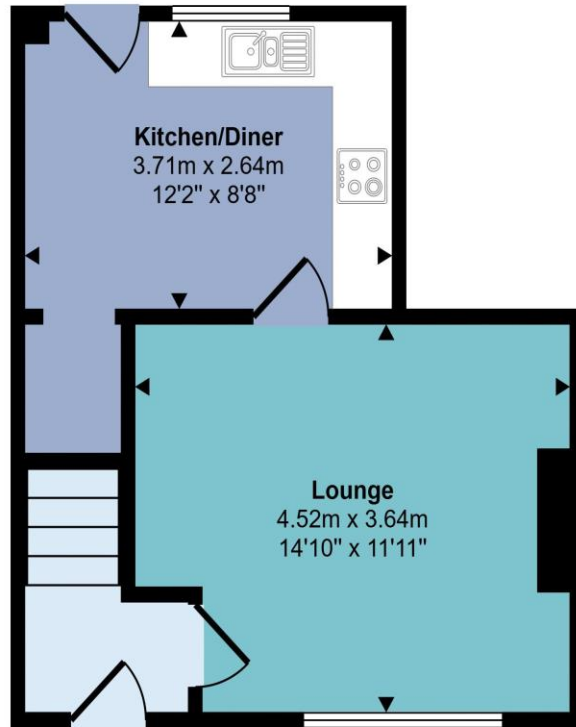

Ground Floor  
Approx 30 sq m / 326 sq ft

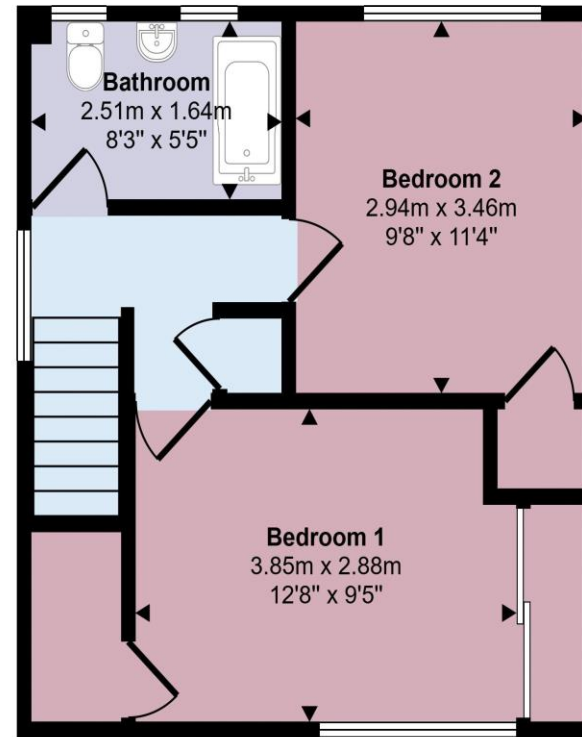

First Floor  
Approx 36 sq m / 391 sq ft

This floorplan is only for illustrative purposes and is not to scale. Measurements of rooms, doors, windows, and any items are approximate and no responsibility is taken for any error, omission or mis-statement. Icons of items such as bathroom suites are representations only and may not look like the real items. Made with Made Snappy 360.