



Woodleigh Drive, Sutton-On-Hull, HU7

Asking Price £180,000











Woodleigh Drive, Sutton-On-Hull, HU7

This semi-detached property presents an exciting opportunity for those looking to create their dream home. Offered with no chain, whilst in need of updating, allowing you to design and renovate to your taste. Presenting an entrance hall that leads to a spacious lounge/diner and a well-appointed kitchen. Ascending to the upper level, you will find three bedrooms, alongside a bathroom and a separate WC. Externally, the property features a lovely garden, a large driveway, and a convenient garage, making it an exceptional find.

Situated in Sutton-On-Hull this property located in a peaceful location with close proximity to a wide variety of shops and amenities available on Sutton Road. Popular schools, such as Cavendish, Gillshill Primary and Malet Lambert, are a short distance away. Excellent transport links around Hull and the surrounding areas are available.

KEY FEATURES

- SEMI-DETACHED
- 3 BEDROOMS
- NO CHAIN
- GARAGE
- DRIVEWAY
- FREEHOLD

DETAILS

Entrance Hall

With carpet flooring, radiator, stairs leading to the first floor and doors leading to the lounge and kitchen.

Lounge/Diner

With carpet flooring, double glazed windows, radiators and electric fire.

Kitchen

With vinyl flooring, laminate work surfaces, sink/drainage, double glazed window, central heating boiler, space for appliances, radiator and door leading to the rear garden.

Bedroom 1

With carpet flooring, radiator and double glazed window.

Bedroom 2

With carpet flooring, radiator and double glazed window.

Bedroom 3

With carpet flooring, radiator and double glazed window.

Bathroom

With carpet flooring, radiator, wash hand pedestal basin, double glazed window, bath cubicle and shower attachment.

WC

With vinyl flooring, WC and double glazed window.

Outside

Externally, the property features a lovely garden, a large driveway, and a convenient garage, making it an exceptional

find.

Viewings

Strictly by appointment with selling agents. Please contact Wigwam Homes today to book your viewing.

Fixtures & Fittings

Various fixtures and fittings may be available by separate negotiation and need to be confirmed prior to processing a formal offer.

Free Market Appraisals / Property Valuations

We at Wigwam Homes are delighted to offer any homeowner a FREE no obligation valuation on your property. Call today to book! Interested in selling? We offer zero tie-in periods and no-sale NO-fee! Call us now on 01482 50 51 52 to book a valuation.

Free Mortgage Consultations

At Wigwam Homes we have our own independent mortgage advisors with access to over 90 lenders. With so many mortgage products on the market, an independent advisor can show you all the various options and help you discover which one is right for you. We can also help with any property, income and personal insurances which you may need to complete your mortgage application.

About Us

At Wigwam Homes we take pride in the success we achieve for our clients. Whether it is selling your properties, finding your forever home, searching for a long-term rental investment or looking to profit from onward selling, the Wigwam team is here to guide you through the housing market.

Approx Gross Internal Area
80 sq m / 866 sq ft

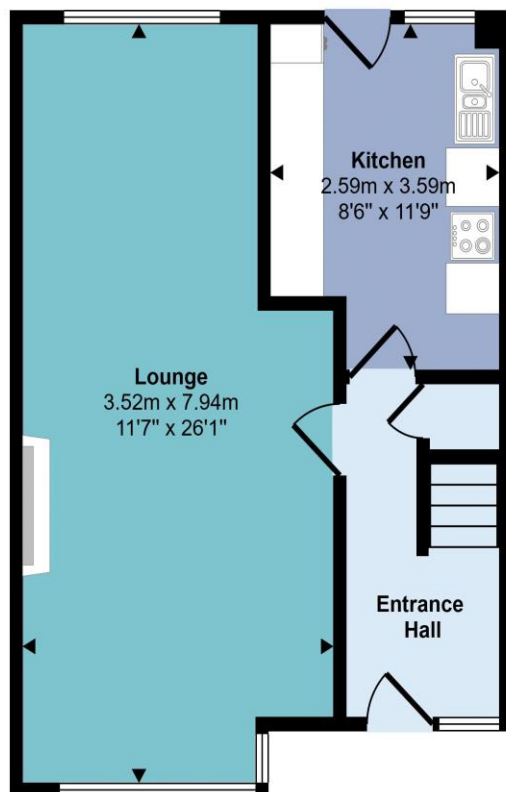

Ground Floor
Approx 41 sq m / 439 sq ft

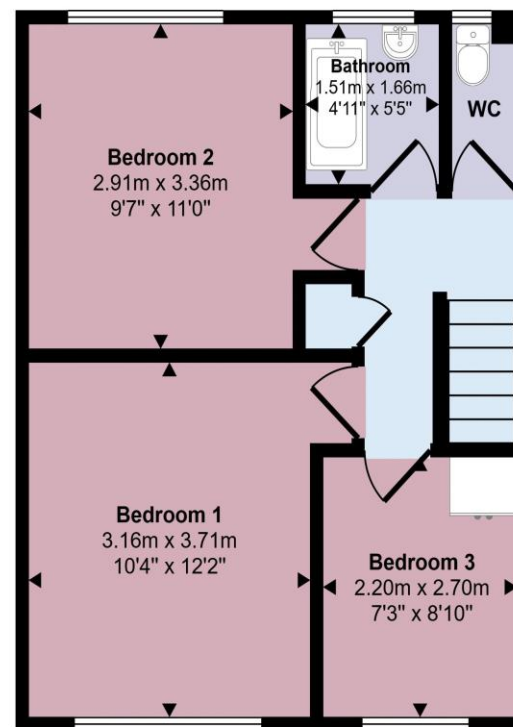

First Floor
Approx 40 sq m / 427 sq ft

This floorplan is only for illustrative purposes and is not to scale. Measurements of rooms, doors, windows, and any items are approximate and no responsibility is taken for any error, omission or mis-statement. Icons of items such as bathroom suites are representations only and may not look like the real items. Made with Made Snappy 360.