



**Bachelers Street, Hull, HU3**

**Asking Price £120,000**















# Bachelor Street, Hull, HU3

**SELLING WITH NO CHAIN!** This end-terraced property presents a fantastic opportunity for those looking to add their personal touch to a home, located in a prime area close to popular amenities. Upon entering, you are greeted by an entrance hall that leads into the spacious dining room and lounge, which offers an ample living space for relaxation and entertaining guests. The ground floor also features a kitchen, ideal for preparing family meals.

Moving to the first floor, you'll find three well-proportioned bedrooms, providing plenty of space for family or guests, along with a family bathroom. The rear garden offers an ideal outdoor space for gardening, play, or simply enjoying the fresh air. The property also benefits from off-road parking to the rear.

Situated on Bachelor Street just off Hessle Road, this property is in a highly convenient location, close to a wide range of amenities, including Home Bargains, B&M, Lidl, and Asda Superstore. The popular Kingston Retail Park and St. Andrews Quay Retail Park are just minutes away, providing even more shopping options. Well-regarded schools such as Chiltern Primary School, Adelaide Primary School, and The Boulevard Academy are nearby. Additionally, excellent bus routes offer easy access to Hull City Centre and surrounding areas.

Score	Energy rating	Current	Potential
92+	A		
81-91	B		
69-80	C		74 C
55-68	D		
39-54	E	53 E	
21-38	F		
1-20	G		

## KEY FEATURES

- End-Terraced
- 3 Bedrooms
- NO CHAIN
- Freehold
- Off Road Parking

# DETAILS

## Entrance Hall

With tiled flooring, radiator, door leading to dining room, spotlights, stairs leading to first floor.

## Lounge

With tiled flooring, radiator, double glazed windows, spotlights and open arch leading to dining room

## Dining Room

With tiled flooring, double glazed windows, floor to ceiling radiator, spotlights and door way leading to kitchen

## Kitchen

With laminate flooring, radiator, laminate worksurfaces, cabinets, spotlights, integrated hob, integrated oven, fan extractor, sink/drainage, space for appliances and door leading rear garden.

## Bedroom 1

With carpet flooring and double glazed windows.

## Bedroom 2

With carpet flooring, spotlights and double glazed windows.

## Bedroom 3

With carpet flooring, radiator and double glazed windows.

## Bathroom

With vinyl flooring, towel radiator, pedestal hand wash basin, WC and bath tub with shower attachment.

## Rear Garden

With artificial lawn, gravel, decking, fence boundary, patio, access to the rear aspect and door leading to kitchen.

## Parking

Offers off road parking to the rear aspect.

## Viewings

Strictly by appointment with selling agents. Please contact Wigwam Homes today to book your viewing.

## Fixtures & Fittings

Various fixtures and fittings may be available by separate negotiation and need to be confirmed prior to processing a formal offer.

## Free Market Appraisals / Property Valuations

We at Wigwam Homes are delighted to offer any homeowner a FREE no obligation valuation on your property. Call today to book! Interested in selling? We offer zero tie-in periods and no-sale NO-fee! Call us now on 01482 50 51 52 to book a valuation.

## Free Mortgage Consultations

At Wigwam Homes we have our own independent mortgage advisors with access to over 90 lenders. With so many mortgage products on the market, an independent advisor can show you all the various options and help you discover which one is right for you. We can also help with any property, income and personal insurances which you may need to complete your mortgage application.



Approx Gross Internal Area  
97 sq m / 1041 sq ft

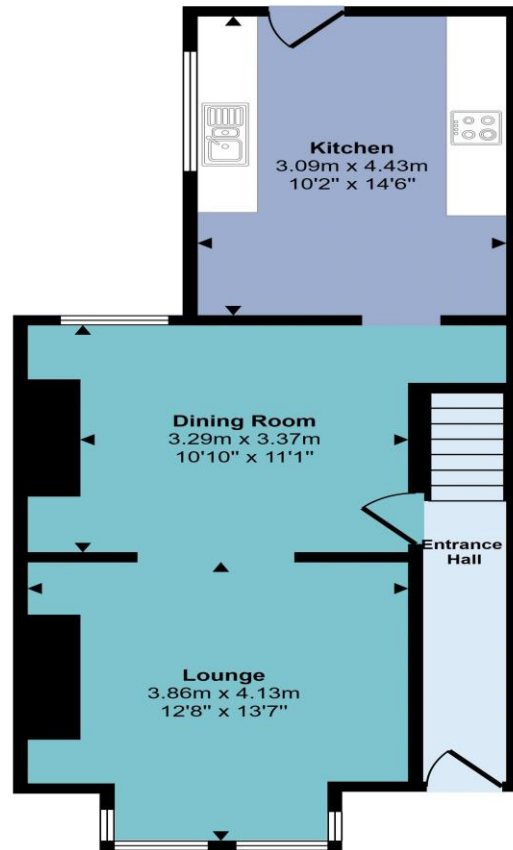

Ground Floor  
Approx 49 sq m / 525 sq ft

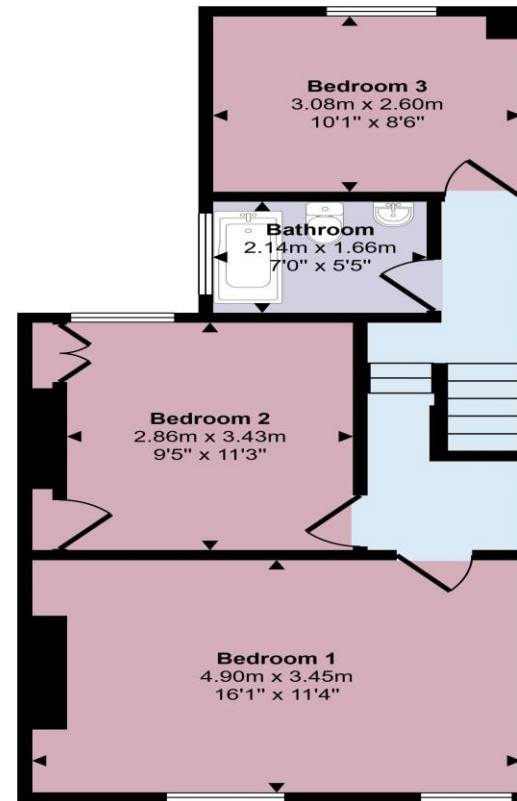

First Floor  
Approx 48 sq m / 515 sq ft

This floorplan is only for illustrative purposes and is not to scale. Measurements of rooms, doors, windows, and any items are approximate and no responsibility is taken for any error, omission or mis-statement. Icons of items such as bathroom suites are representations only and may not look like the real items. Made with Made Snappy 360.