



## 327 BISHOPSFORD ROAD MORDEN, SM4 6BW

£440,000  
FREEHOLD

\*\*\* OFFERED WITH IMMEDIATE VACANT POSSESSION IS THIS SPACIOUS THREE BEDROOM END OF TERRACE HOUSE \*\*\*

The house features good size accommodation which includes through lounge, modern kitchen and bathroom and three good size bedrooms. The house features a rear and side garden which could possibly provide room to extend subject to the normal planning consents.

Bishopsford Road is a popular residential road providing access to Both Morden and Suttons with their respective shopping centres and transport links. The house is also close to the local shops of Rosehill and St Helier hospital.

The house is offered for sale with NO FORWARD CHAIN and ready to move into.



**TOOMEY**  
ESTATE AGENTS



**Ground Floor**

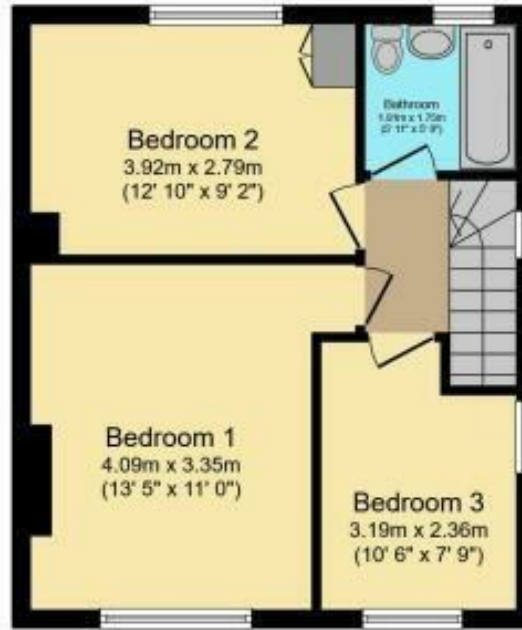

**First Floor**

Total floor area 83.3 sq.m. (897 sq.ft.) approx



Energy Efficiency Rating		Current	Potential
Very energy efficient - lower running costs			
(92 plus) A			85
(81-91) B			
(69-80) C		71	
(55-68) D			
(39-54) E			
(21-38) F			
(1-20) G			
Not energy efficient - higher running costs			
<b>England &amp; Wales</b>		EU Directive 2002/91/EC	

Agents Note: Whilst every care has been taken to prepare these particulars, they are for guidance purposes only. All measurements are approximate and are for general guidance purposes only and whilst every care has been taken to ensure their accuracy, they should not be relied upon and potential buyers/tenants are advised to recheck the measurements

Toomey Estate Agents Sales  
333a London Road  
Mitcham  
Surrey  
CR4 4BE

0208 715 9333  
enquiries@toomeyestateagents.co.uk  
www.toomeyestateagents.co.uk

