



Main Street

Empingham, Oakham, LE15 8PS

**Price Guide £480,000**

Richardson

## Main Street

Empingham, Oakham, LE15 8PS

Positioned within the conservation area of this highly sought after Rutland village, Rosery Farm is an attractive Grade II Listed thatched cottage retaining many period features with a superb range of outbuildings/barns forming a courtyard to the rear. In need of updating and modernisation, the property does have gas central heating with the accommodation comprising, reception hall, sitting room, dining room, kitchen breakfast room, rear lobby and cloakroom. To the first floor, which has sloping ceilings, there are 3 bedrooms and a shower room. Enclosed front garden with driveway to the side and a 5 bar gate opening to the rear garden/courtyard with range of out buildings to all sides. There is a workshop with a pantile roof which is attached to the neighbouring property, a long open faced store/car port with a pantile roof, a stone built former stable with a corrugated metal roof which is attached to a good sized stone barn with a Collyweston roof. The property is offered with no chain and subject to obtaining any required planning permission has a great scope for improvement and extension.

Entrance hall

Sitting room  
22'11" x 14'6" max (6.99m x 4.42m max)

Dining room  
16'11" x 13'10" (5.16m x 4.24m)

Kitchen breakfast room  
13'3" x 8'0" (4.04m x 2.45m)

Rear lobby

Cloakroom





#### First floor landing

Bedroom  
13'10" max x 11'10" max (4.24m max x 3.63m max)

Bedroom  
11'0" max x 10'7" max (3.36m max x 3.23m max)

Bedroom  
10'1" max x 8'1" max (3.09m max x 2.48m max)

#### Shower room

#### External details

The property is set back behind a dwarf wall and hedging with hand gate and pathway to front door. Driveway to the side with 5 bar gate opening to the rear garden and courtyard area.

Workshop  
15'1" x 11'10" max (4.62m x 3.62m max)

Carport/store  
40'5" x 10'3" (12.32m x 3.13m)

Stable/outbuilding  
14'5" x 12'9" (4.41m x 3.91m)

Barn  
19'1" x 15'3" (5.83m x 4.66m)

Services  
All mains services are connected.

Communication  
According to Ofcom Mobile Coverage: is Likely with EE, Three, O2 and Vodafone  
According to Ofcom Broadband: Ultrafast is available

Agents Notes  
Under the Estate Agents Act of 1979 we hereby give notice that a Partner in this firm has an interest in this property as Trustee.

Viewing  
By appointment with Richardson 01780 762433 [post@richardsonsurveyors.co.uk](mailto:post@richardsonsurveyors.co.uk)



## Floor Plan

## Area Map

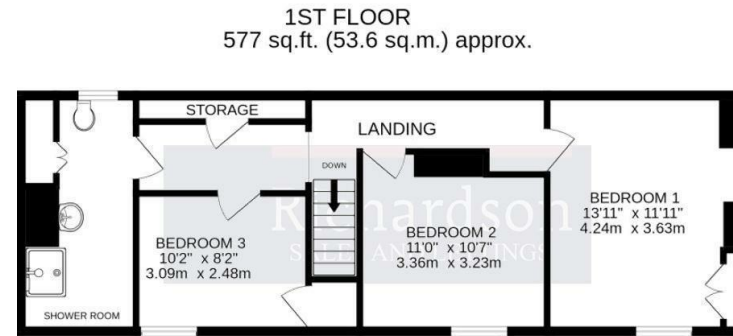
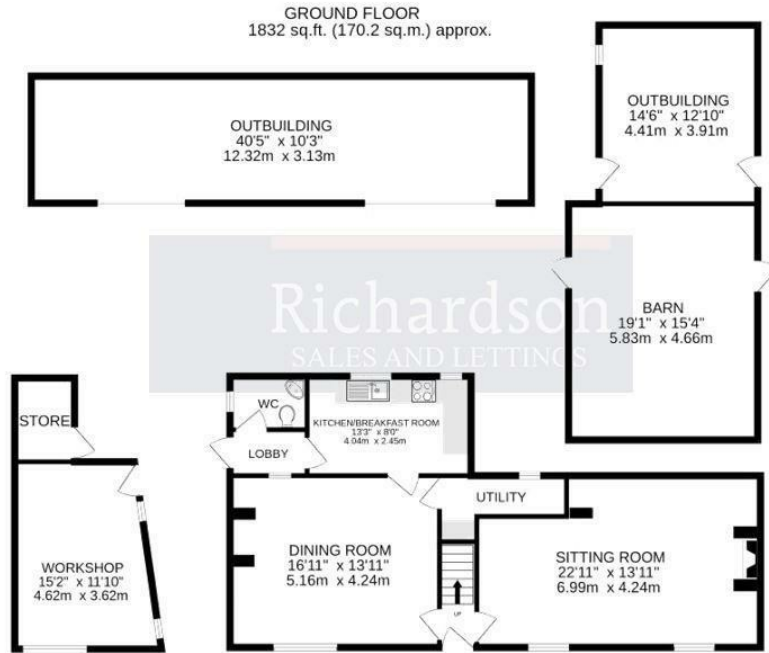

**TOTAL FLOOR AREA : 2408 sq.ft. (223.7 sq.m.) approx.**

Made with Metropix ©2024



**IMPORTANT NOTICE** - Richardson for themselves and the Vendors or Lessors of this property whose agents they are given notice that:

1. The particulars are intended to give a fair and substantially correct overall description for the use and the guidance of intending purchasers and do not constitute, nor constitute any part of an offer or contract. Prospective purchasers and lessees should seek their own professional advice.
2. All descriptions, dimensions, reference to condition and necessary permissions for the use and occupation and their details are given in good faith, and are believed to be correct, but any intending purchaser or tenants should not rely on them as statements or representations of fact but must satisfy themselves by inspection or otherwise to the correctness of each or them.
3. No person in the employment of Richardson has the authority to make or give any representation or warranty whatever in relation to this property on behalf of Richardson, nor enter into any contract on behalf of the vendor.
4. No responsibility can be accepted for any expenses incurred by intending purchasers or lessees in inspecting properties which have been sold, let or withdrawn.

**MEASUREMENTS AND OTHER INFORMATION** - All measurements are approximate. Whilst we endeavour to make our sales details reliable, if there is any point which is of particular importance to you, please contact the agent, who will be pleased to check the information for you, especially if you will be travelling some distance to view the property. Electrical and other appliances mentioned within the sale particulars have not been tested by Richardson, therefore prospective purchasers must satisfy themselves as to their working order. The sale is subject to all rights of support, public and private rights of way, water, light, drainage and other easements, quasi-easements and way leaves, all other rights, whether mentioned in these particulars or not.

**MONEY LAUNDERING REGULATIONS** intending purchasers will be asked to produce identification and proof of financial status when an offer is received. We would ask for your co-operation in order that no delay in agreeing a sale.

**Sheep Market House Sheep Market, Stamford, Lincs, PE9 2RB**

[www.richardsonsurveyors.co.uk](http://www.richardsonsurveyors.co.uk)

**01780 762433**