



1A Dickinson Square, Croxley Green, WD3 3EZ  
Price Guide £810,000





Floor Plan

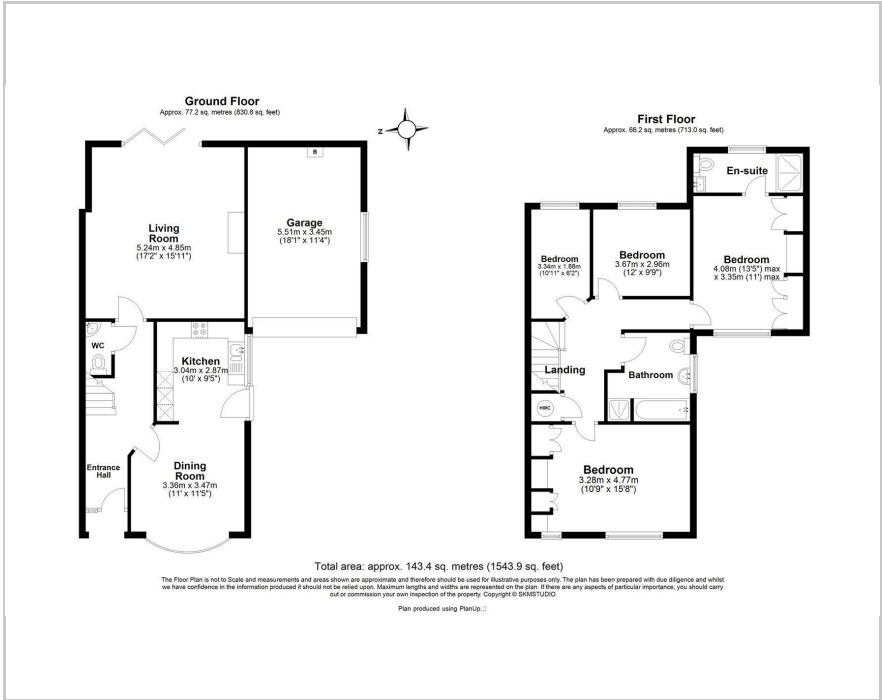

Area Map



Accommodation

- Very well presented 4 bed 2 bath semi detached with garage
- Short walk to Harvey Road and Rickmansworth schools
- Within easy walking distance of Croxley Met Line station
- Plenty of scope to develop property further S.T.P.P
- Master bed with En-Suite
- Large family bathroom
- Patio area with garden to the side of the property

Viewing

Please contact our Grosvenor Estate Agents Ltd Office on 01923 711651 if you wish to arrange a viewing appointment for this property or require further information.

Energy Efficiency Graph

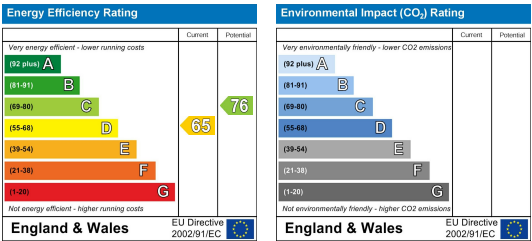

These particulars, whilst believed to be accurate are set out as a general outline only for guidance and do not constitute any part of an offer or contract. Intending purchasers should not rely on them as statements of representation of fact, but must satisfy themselves by inspection or otherwise as to their accuracy. No person in this firms employment has the authority to make or give any representation or warranty in respect of the property.