

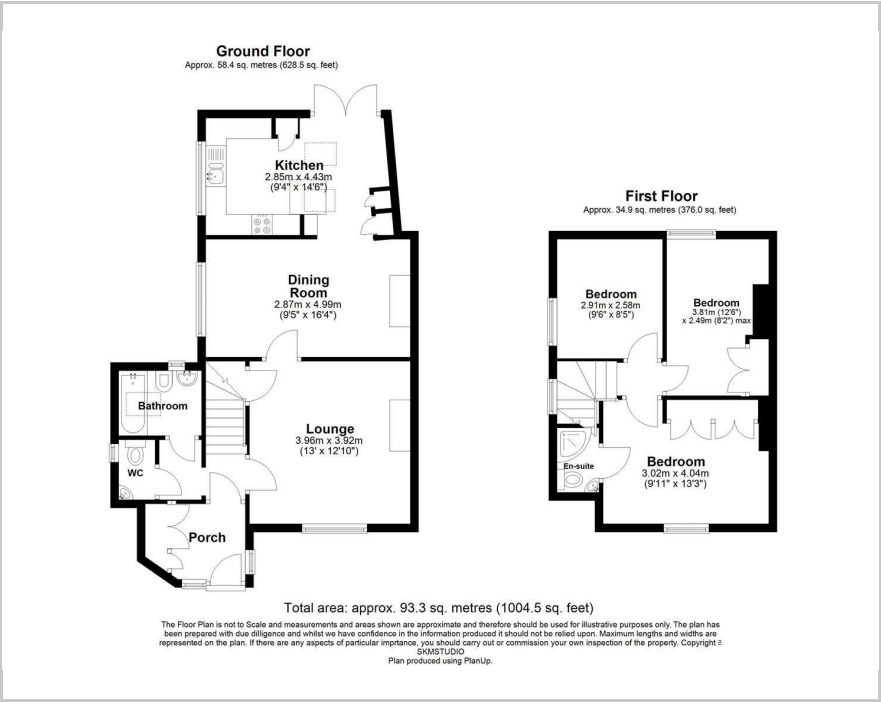

1 New Road, Croxley Green, WD3 3EJ
Price Guide £750,000



Floor Plan



Area Map



Accommodation

- Charming end of terrace character property
- Just off The Green in the heart of village
- Beautiful cottage garden with garden room
- Two reception rooms and separate kitchen/breakfast room
- Downstairs bathroom
- Master bedroom with En-Suite
- Off street parking for two cars
- Close to the Met Line station

Viewing

Please contact our Grosvenor Estate Agents Ltd Office on 01923 711651 if you wish to arrange a viewing appointment for this property or require further information.

Energy Efficiency Graph

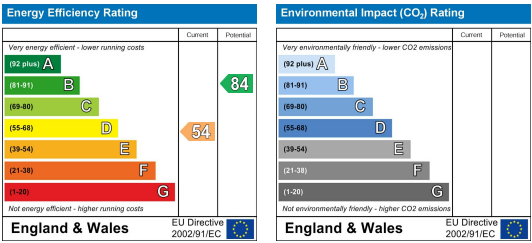

These particulars, whilst believed to be accurate are set out as a general outline only for guidance and do not constitute any part of an offer or contract. Intending purchasers should not rely on them as statements of representation of fact, but must satisfy themselves by inspection or otherwise as to their accuracy. No person in this firms employment has the authority to make or give any representation or warranty in respect of the property.