



87 Valley Walk, Croxley Green, WD3 3TQ  
Price Guide £615,000





Floor Plan

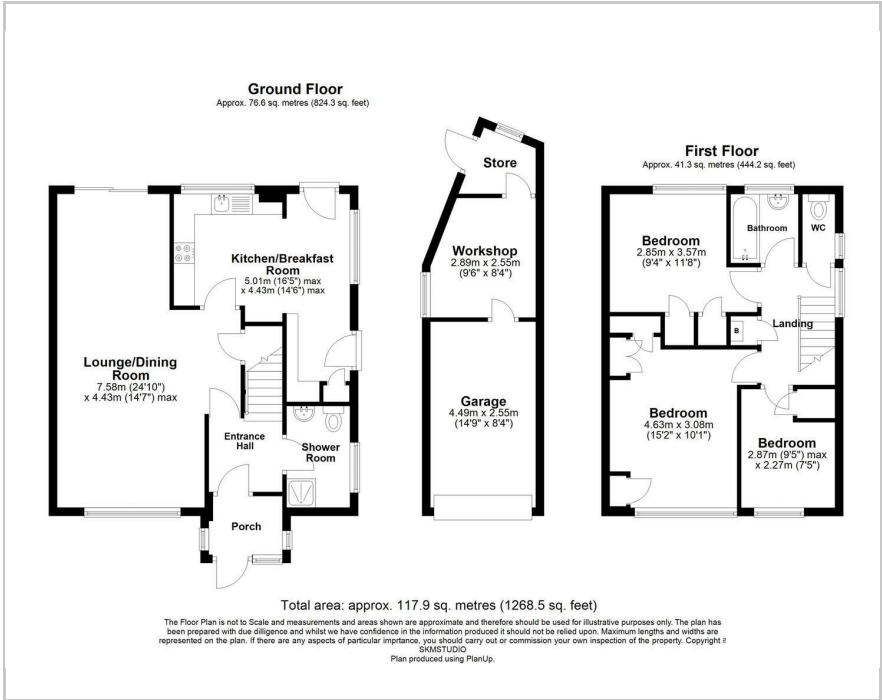

Area Map



Accommodation

- Extended 3 bed 2 bath end of terrace with separate single garage
- Good size Kitchen/Breakfast Room
- Good size Lounge
- Downstairs Shower Room
- 3 Good size bedrooms, family Bathroom
- Quiet location close to the Grand Union Canal
- Walking distance to Met Line

Viewing

Please contact our Grosvenor Estate Agents Ltd Office on 01923 711651 if you wish to arrange a viewing appointment for this property or require further information.

Energy Efficiency Graph

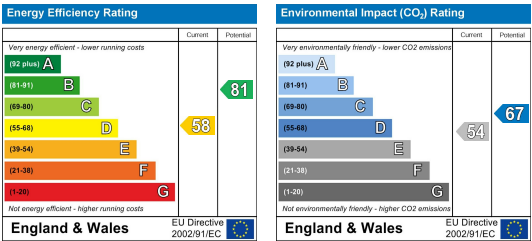

These particulars, whilst believed to be accurate are set out as a general outline only for guidance and do not constitute any part of an offer or contract. Intending purchasers should not rely on them as statements of representation of fact, but must satisfy themselves by inspection or otherwise as to their accuracy. No person in this firms employment has the authority to make or give any representation or warranty in respect of the property.