



27 Malvern Way, Croxley Green, WD3 3QQ  
Price Guide £349,950





Floor Plan

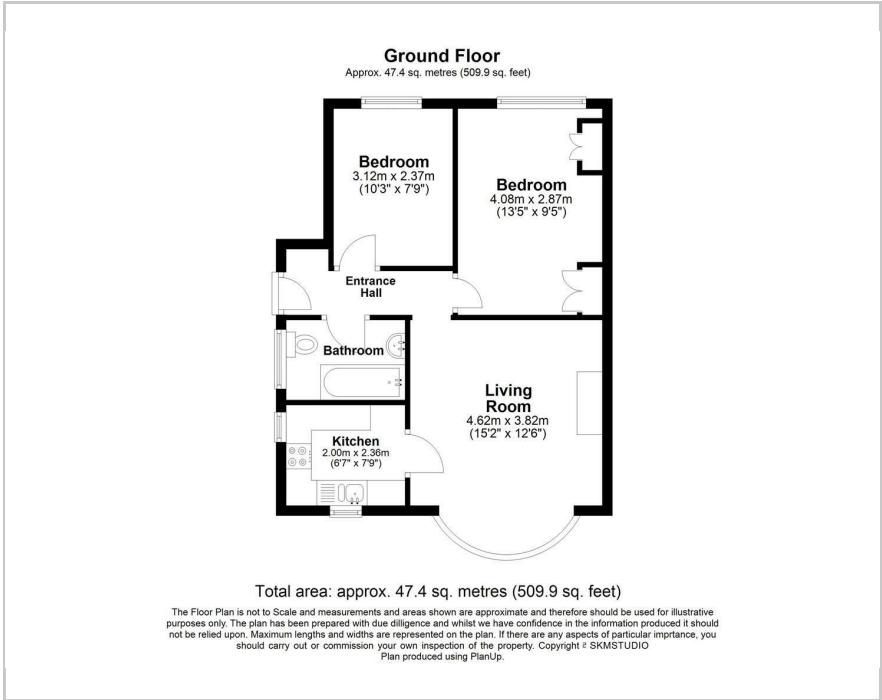

Area Map

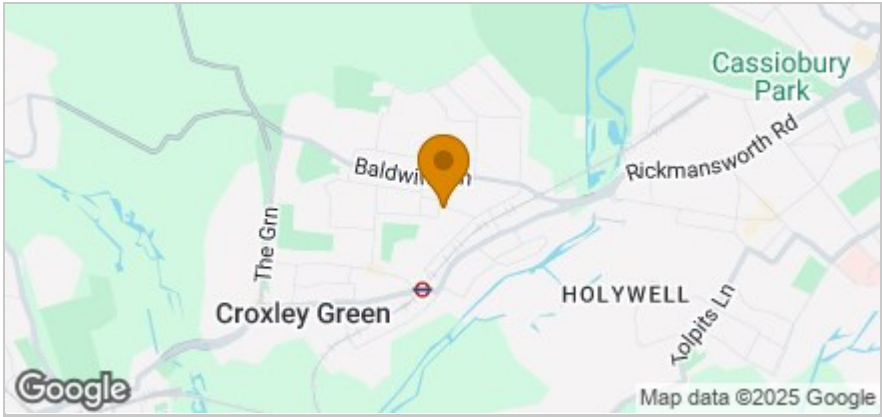

These particulars, whilst believed to be accurate are set out as a general outline only for guidance and do not constitute any part of an offer or contract. Intending purchasers should not rely on them as statements of representation of fact, but must satisfy themselves by inspection or otherwise as to their accuracy. No person in this firms employment has the authority to make or give any representation or warranty in respect of the property.

163 New Road, Croxley Green, Hertfordshire, WD3 3HB  
Tel: 01923 711651 Email: [sales@grosvenorestateagents.co.uk](mailto:sales@grosvenorestateagents.co.uk) [www.grosvenorestates.co.uk](http://www.grosvenorestates.co.uk)

Accommodation

- Leasehold ground floor maisonette
- 2 Beds, separate kitchen, lounge/dining room
- Garden to the side of the property
- Close to Met Line station
- Close to Malvern Way school
- Long lease, low ground rent and no service charge
- NO UPPER CHAIN

Viewing

Please contact our Grosvenor Estate Agents Ltd Office on 01923 711651 if you wish to arrange a viewing appointment for this property or require further information.

Energy Efficiency Graph

