

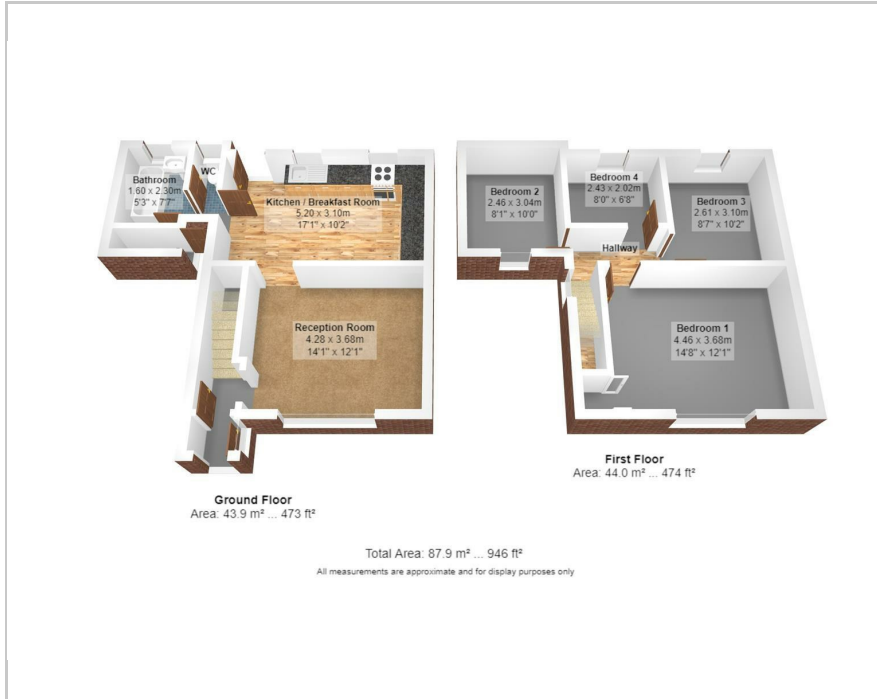

10 Springfield Close, Croxley Green, WD3 3HQ  
Price Guide £565,000



## Floor Plan



## Area Map

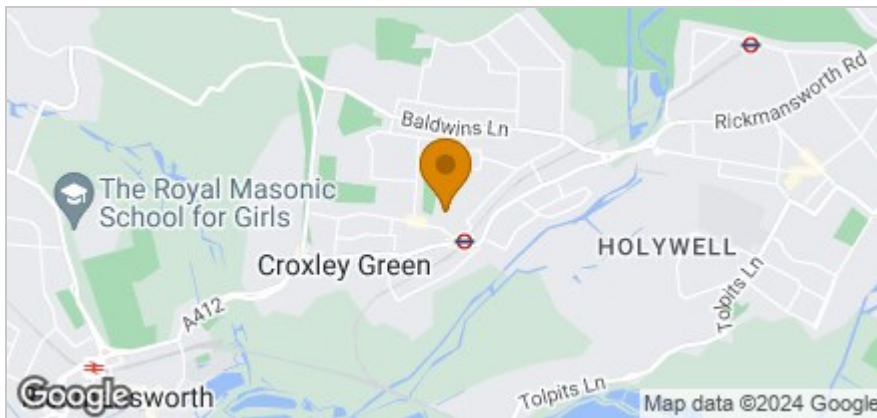

## Accommodation

- Great sized extended 4 double bedroom semi.
- Sought after location close to Met Line and good schools.
- Reception room
- Kitchen Diner
- Bathroom
- Gas central heating
- Double glazing
- In need of upgrading in places.
- Scope to extend further STPP
- NO UPPER CHAIN

## Viewing

Please contact our Grosvenor Estate Agents Ltd Office on 01923 711651 if you wish to arrange a viewing appointment for this property or require further information.

## Energy Efficiency Graph

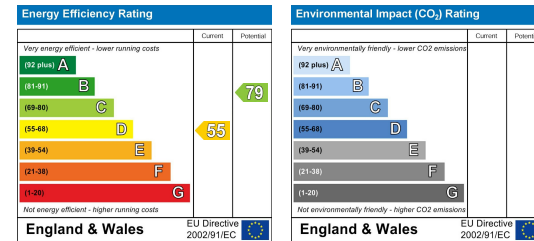

These particulars, whilst believed to be accurate are set out as a general outline only for guidance and do not constitute any part of an offer or contract. Intending purchasers should not rely on them as statements of representation of fact, but must satisfy themselves by inspection or otherwise as to their accuracy. No person in this firm's employment has the authority to make or give any representation or warranty in respect of the property.

163 New Road, Croxley Green, Hertfordshire, WD3 3HB  
Tel: 01923 711651 Email: sales@grosvenorestateagents.co.uk www.grosvenorestates.co.uk