



37 Rugby Way, Croxley Green, WD3 3PD  
Price Guide £795,000





## Floor Plan

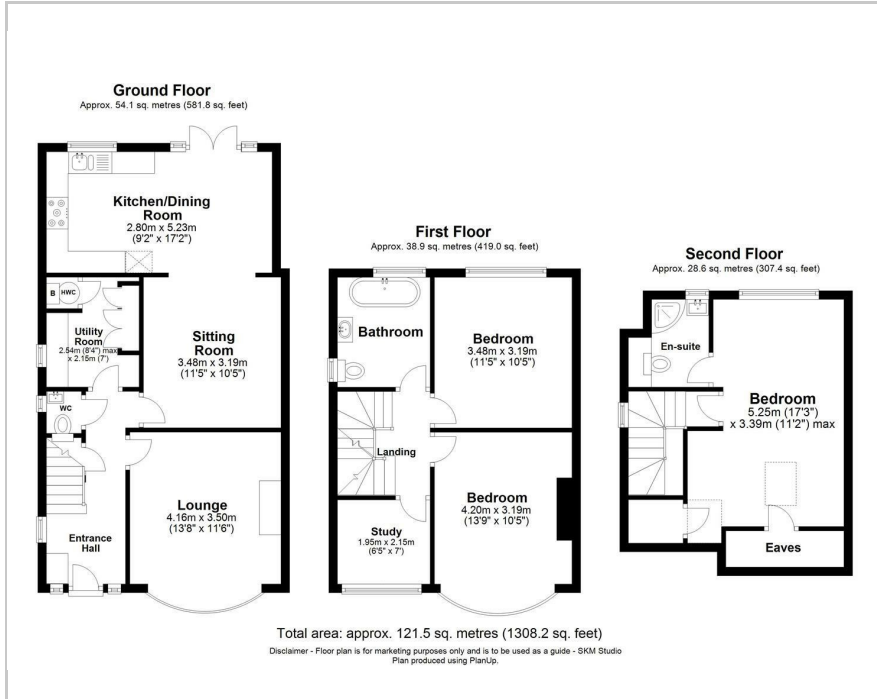

## Area Map

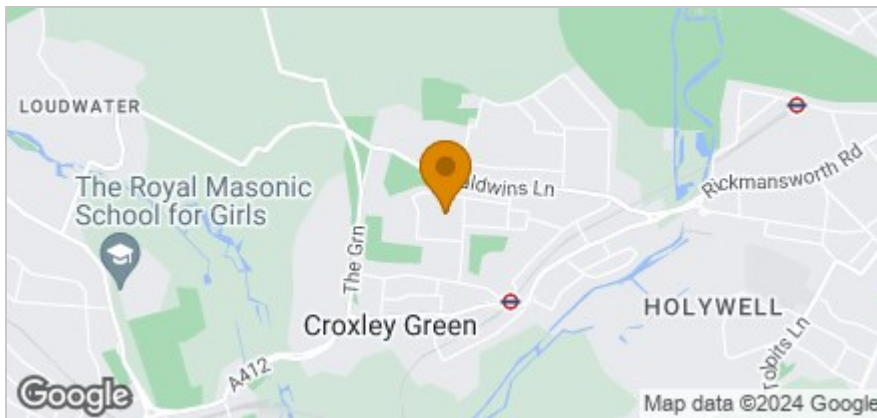

## Accommodation

- Beautifully presented in immaculate condition
- Quiet side road close to Yorke Mead, Rickmansworth and Croxley Danes schools
- Close to Met Line station
- 4 Bed 2 bath 2 reception rooms
- Gorgeous West facing garden with pretty pagoda over seating area
- Central village location
- VIEWINGS 11TH MAY 2024 BY APPOINTMENT

## Viewing

Please contact our Grosvenor Estate Agents Ltd Office on 01923 711651 if you wish to arrange a viewing appointment for this property or require further information.

## Energy Efficiency Graph

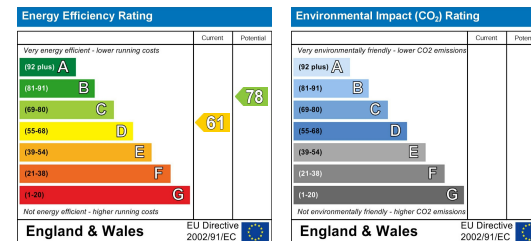

These particulars, whilst believed to be accurate are set out as a general outline only for guidance and do not constitute any part of an offer or contract. Intending purchasers should not rely on them as statements of representation of fact, but must satisfy themselves by inspection or otherwise as to their accuracy. No person in this firm's employment has the authority to make or give any representation or warranty in respect of the property.