



ASKING PRICE

**£695,000**

**Hollydale Road**

London, SE15 2AR

**GARETH  
JAMES**

## PROPERTY SUMMARY

We're pleased to bring to the market this fantastic and rare opportunity to purchase a much loved three bedroom end of terrace family home wonderfully located on Hollydale Road just a hop skip and a jump away from the centre of Nunhead, one of London's most desirable places to live.

3



1



2

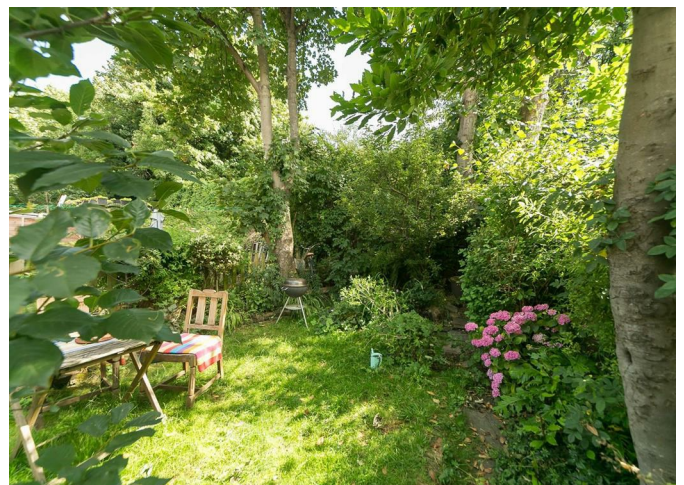







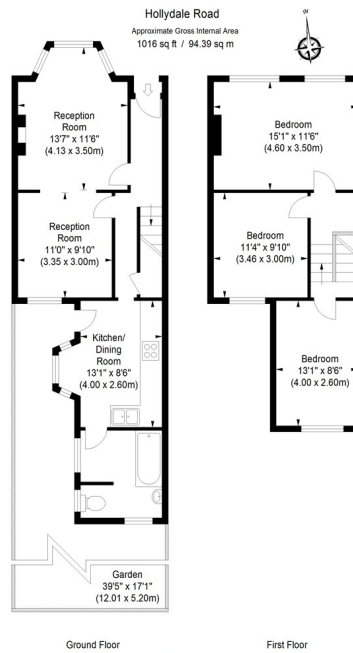

ILLUSTRATION FOR IDENTIFICATION PURPOSES ONLY

ALL MEASUREMENTS ARE MAXIMUM, AND INCLUDE WINDOW BAYS AND WARDROBES WHERE APPLICABLE  
THIS PLAN MUST NOT BE REPRODUCED BY ANY OTHER PERSON WITHOUT PERMISSION

3

1

2

Energy Efficiency Rating		
	Current	Potential
Very energy efficient - lower running costs		
(92 plus) <b>A</b>		
(81-91) <b>B</b>		85
(69-80) <b>C</b>		
(55-68) <b>D</b>	58	
(39-54) <b>E</b>		
(21-38) <b>F</b>		
(1-20) <b>G</b>		
Not energy efficient - higher running costs		
England & Wales	EU Directive 2002/91/EC	

Agents Note: Whilst every care has been taken to prepare these particulars, they are for guidance purposes only. All measurements are approximate and are for general guidance purposes only and whilst every care has been taken to ensure their accuracy, they should not be relied upon and potential buyers/tenants are advised to recheck the measurements

# GARETH JAMES

**OFFICE ADDRESS**  
129 Bellenden Road  
London  
SE15 4QY

**OFFICE DETAILS**  
02077324330  
sales@garethjames.com  
<https://www.garethjames.com/>