

**DETACHED  
BUNGALOW**

**£305,000**



## **PENSTRASSE PLACE TYWARDREATH PL24 2QL**

### **DETACHED 3 BEDROOM BUNGALOW**

An appealing detached bungalow situated in the highly regarded village of Tywardreath. The property has an attractive front garden with driveway parking and would benefit from further cosmetic refreshment.

In brief the property comprises:

Entrance Hall, Cloakroom, Lounge/Dining Room, Kitchen, 3 Bedrooms, Conservatory and Wet Room. Further benefits include gas fired central heating and double glazing. Viewing is recommended to fully appreciate the potential and setting on offer.

**Early Viewing Recommended**  
**\* No Onward Chain \***

### **Key Features**

Detached Bungalow

Garage & Driveway  
Parking

Conservatory

Highly Regarded  
Village Location

Front & Rear Gardens

Gas Central Heating

Chain Free

## About The Location

Tywardreath is an extremely popular and sought after village with good local facilities. The village has its own primary school, butchers, small general store, fish and chip shop, hairdresser and local public house. The larger village of Par which is within easy walking distance, boasts a wider range of shops and facilities including chemist, local supermarket, post office and main line railway station. Par also has a sandy beach, tennis court facilities and sports field with running track. The market town of St Austell is approximately 4 miles distant and offers a comprehensive range of amenities including, mainline railway station to London Paddington, Recreation Centre, Library, Cinema, Bowling Alley and a range of cafes and public houses. The picturesque Harbour Town of Fowey is approximately 3 miles with independent shops and restaurants and is the home of the writer Daphne du Maurier, the area being the inspiration for many of her books.

## ACCOMMODATION COMPRISES:

(All sizes approximate)

### Entrance Hall

uPVC double glazed door and side panel into the hall. Wood paneling to dado height. Doors to cloakroom and lounge.

### Cloakroom

**7' 3" x 4' 3" (2.2m x 1.3m)**

uPVC double glazed window. WC, wash hand basin.

### Lounge/Dining Area

**21' 4" x 12' 10" (6.5m x 3.9m) max**

Two uPVC double glazed windows to the front elevation overlooking the front garden and providing generous natural light. Cornish stone fireplace with living flame gas fire. Two ceiling lights. Central heating radiator. Glazed door to:

### Inner Hall

Central heating radiator. Full-height storage cupboard with shelving. Doors to kitchen, wet room and bedrooms. PIV system. Loft with pull-down ladder, power, light, partially boarded and insulated.

### Kitchen

**10' 6" x 8' 6" (3.2m x 2.6m) MAX**

A modern shaker style kitchen in country cream consisting of wall, base and larder units with complementary worktop and upstand. Space and plumbing for a washing machine and dishwasher, space for a fridge. Built-in oven and ceramic hob with extractor over. One and a half bowl stainless steel sink. Majority tiled walls. Vinyl flooring. uPVC double glazed door with tilt and turn built-in window giving access to the side leading to both the front and rear gardens. Further uPVC double glazed windows to either side. Glazed panel overlooking dining area.

### Bedroom

**10' 2" x 9' 10" (3.1m x 3.0m)**

uPVC double glazed window to the rear elevation. Central heating radiator. Ceiling light.

### Bedroom

**9' 6" x 7' 10" (2.9m x 2.4m)**

uPVC double glazed window to the side elevation. Ceiling light.

### Bedroom / Reception Room

**10' 10" x 9' 10" (3.3m x 3.0m)**

Patio doors to Conservatory. Wood effect laminate flooring. Central heating radiator. Ceiling light.

### Conservatory

**8' 6" x 6' 7" (2.6m x 2.0m)**

Dwarf walls with uPVC double glazed windows. Two uPVC double glazed doors, giving access to either side of the garden. Tiled floor. Power and light.

### Wet Room

**6' 7" x 5' 7" (2.0m x 1.7m)**

Shower with glazed screen. Built-in vanity unit with storage and incorporating a low level WC and wash-hand basin. uPVC double glazed window to the side. Fully tiled walls and floor. Heated towel rail.

### Garage

**15' 9" x 8' 10" (4.8m x 2.7m)**

Up and over door (new). Updated consumer panel. Power and light. Access to the rear of the garage into a covered area, with door to garden and a step to:

### Workshop

**11' 6" x 7' 7" (3.5m x 2.3m)**

Window to the side. Power and light.

### Exterior

To the front of the property is a paved drive leading to an attached garage and a generous area of lawn with mature shrub borders. There is a path from the drive across the front of the property continuing to the side and leading to the rear garden. The path continues around the conservatory with steps either side of the garden leading to a lawn and greenhouse. Outside tap. A hedge forms the rear boundary with established trees with open fields beyond.

### Additional Information

**EPC 'D'**

**Council Tax Band 'C'**

**Services** – Mains Electric, Gas and Drainage

**Cavity Insulation** – Certificated

**Combi Boiler** – Annually Serviced

**Property Age** - 1975

**Tenure** - Freehold

### Viewing

Strictly by appointment with the managing agent Jefferys. If you would like to arrange an appointment to view this property, or require any further information, please contact the office on 01726 73483.

### Floor Plans

Please note that floorplans are provided to give an overall impression of the accommodation offered by the property. They are not to be relied upon as true, scaled and precise representation.



**Lounge/Dining Room**



**Kitchen**



**Kitchen**



**Bedroom / Reception 2**



**Conservatory**



**Bedroom**



**Rear Garden with Open Fields Beyond**



**View from the Drive**

Energy Efficiency Rating		Current	Potential
Very energy efficient - lower running costs			
(92-100)	<b>A</b>		
(81-91)	<b>B</b>		82
(69-80)	<b>C</b>		
(55-68)	<b>D</b>	62	
(39-54)	<b>E</b>		
(21-38)	<b>F</b>		
(1-20)	<b>G</b>		
Not energy efficient - higher running costs			
England, Scotland & Wales		EU Directive 2002/91/EC	

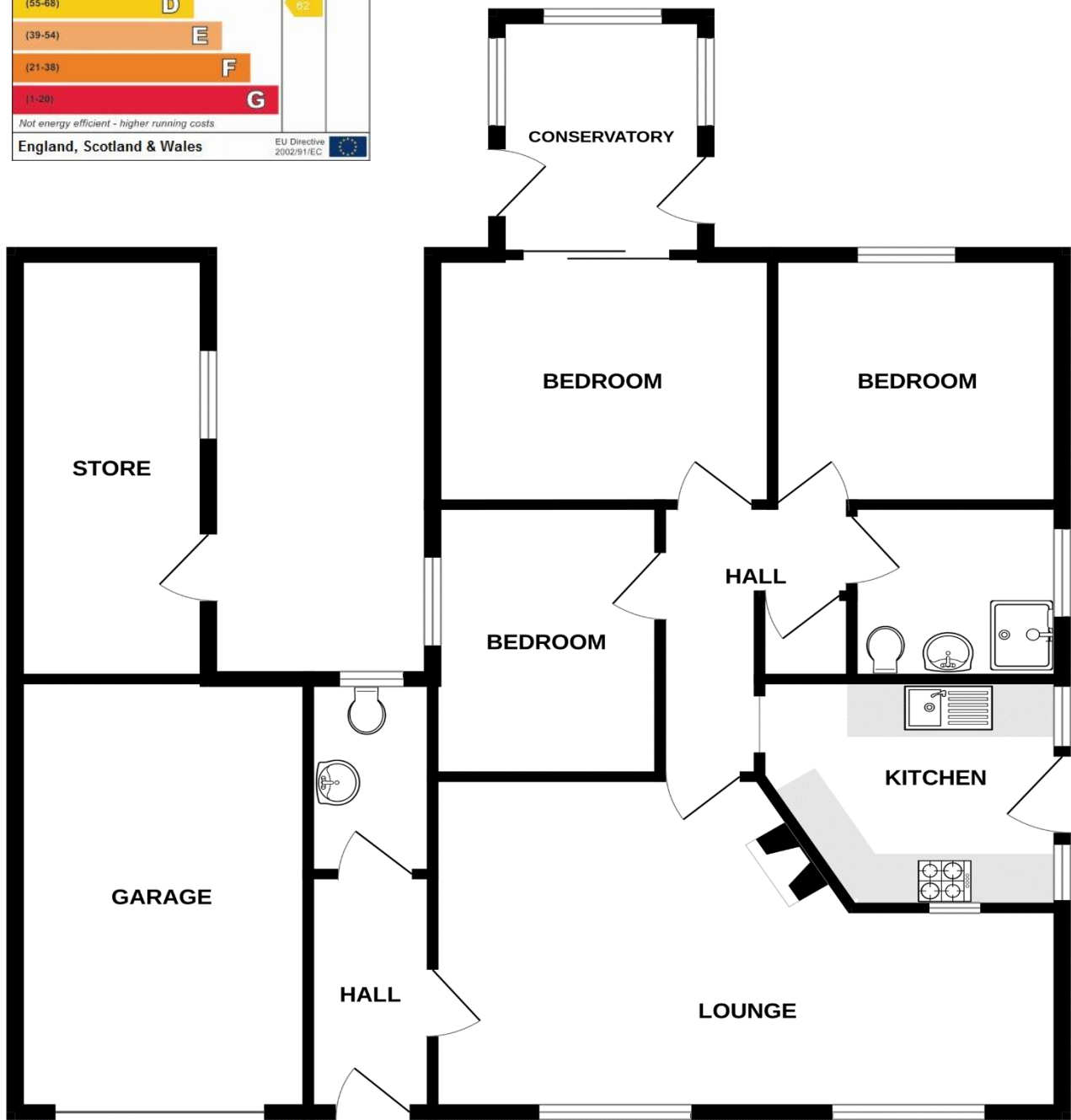

Whilst every attempt has been made to ensure the accuracy of the floorplan contained here, measurements of doors, windows, rooms and any other items are approximate and no responsibility is taken for any error, omission or mis-statement. This plan is for illustrative purposes only and should be used as such by any prospective purchaser. The services, systems and appliances shown have not been tested and no guarantee as to their operability or efficiency can be given.  
Made with Metropix ©2023

#### St Austell

18 Duke St, St Austell  
PL25 5PH  
01726 73483  
staustell@jefferys.uk.com

#### Lostwithiel

5 Fore St, Lostwithiel  
PL22 0BP  
01208 872245  
lostwithiel@jefferys.uk.com

#### Liskeard

17 Dean St, Liskeard  
PL14 4AB  
01579 342400  
liskeard@jefferys.uk.com

ESTABLISHED 1865  
**Jefferys**

CONSUMER PROTECTION FROM UNFAIR TRADING REGULATIONS 2008: The Agent has not tested any apparatus, equipment, fixtures and fittings or services and so cannot verify that they are in working order or fit for the purpose. A Buyer is advised to obtain verification from their Solicitor or Surveyor. References to the Tenure of a Property are based on information supplied by the Seller. The Agent has not had sight of the title documents. A Buyer is advised to obtain verification from their Solicitor. Items shown in photographs are not included unless specifically mentioned within the sales particulars. They may however be available by separate negotiation. Buyers must check the availability of any property and make an appointment to view before embarking on any journey to see a property. DATA PROTECTION ACT 1998: Please note that all personal information provided by customers wishing to receive information and/or services from the estate agent and the "Property Sharing Experts" of which Jefferys is a member for the purpose of providing services associated with the business of an estate agent but specifically excluding mailings or promotions by a third party. If you do not wish your personal information to be used for any of these purposes, please notify your estate agent.