



Burnsdale - REF SR, Allerton, Bradford, West Yorkshire, BD15

- OF INTEREST TO FIRST TIME BUYERS AND INVESTORS
- CURRENTLY TENANTED AT £700 PCM TENANT TO LEAVE END OF OCTOBER 2024
- THREE PIECE MODERN STYLE BATHROOM
- GAS CENTRAL HEATING
- DRIVEWAY TO THE FRONT
- THREE BEDROOM MID THROUGH TERRACE
- KITCHEN DINER
- DOUBLE GLAZING
- GARDEN TO THE REAR
- COUNCIL TAX BAND C - EPC RATING GRADE C

Offers In The Region Of £190,000

Burnsdale - REF SR, Allerton, Bradford, West Yorkshire, BD15 9DA

DESCRIPTION

Presenting a charming terraced house, in a good condition and currently listed for sale. This impressive property boasts a well-structured layout and is a perfect home for first time buyers, investors, families and couples alike.

The house holds a total of three commodious bedrooms, providing ample space for a family. In addition, there is one bathroom which is well-maintained and up to standard. The residence also features a single, comfortable reception room, that is ideal for entertaining or relaxing after a long day.

One of the unique features of this property is the kitchen diner. The kitchen is well-equipped and comes with a dining space, creating a warm and inviting atmosphere for family meals or social gatherings.

The location of the property is particularly advantageous. Situated with easy access to public transport links, it offers convenience for daily commuting. Additionally, it's within close proximity to local schools making it a great choice for families with school-age children. The nearby parks provide perfect spots for outdoor activities and leisure, whilst the local amenities ensure all your daily necessities are within reach.

To the rear is a garden area, accessed via the patio doors in the kitchen diner and parking is via a driveway to the front.

In conclusion, this terraced house is a beautiful blend of comfort, convenience and location. It promises to be a great investment opportunity and a place to create lasting memories.

Whether you are a family seeking a nurturing environment for your children or a couple looking for a cosy space to call home, this property is sure to meet your expectations.





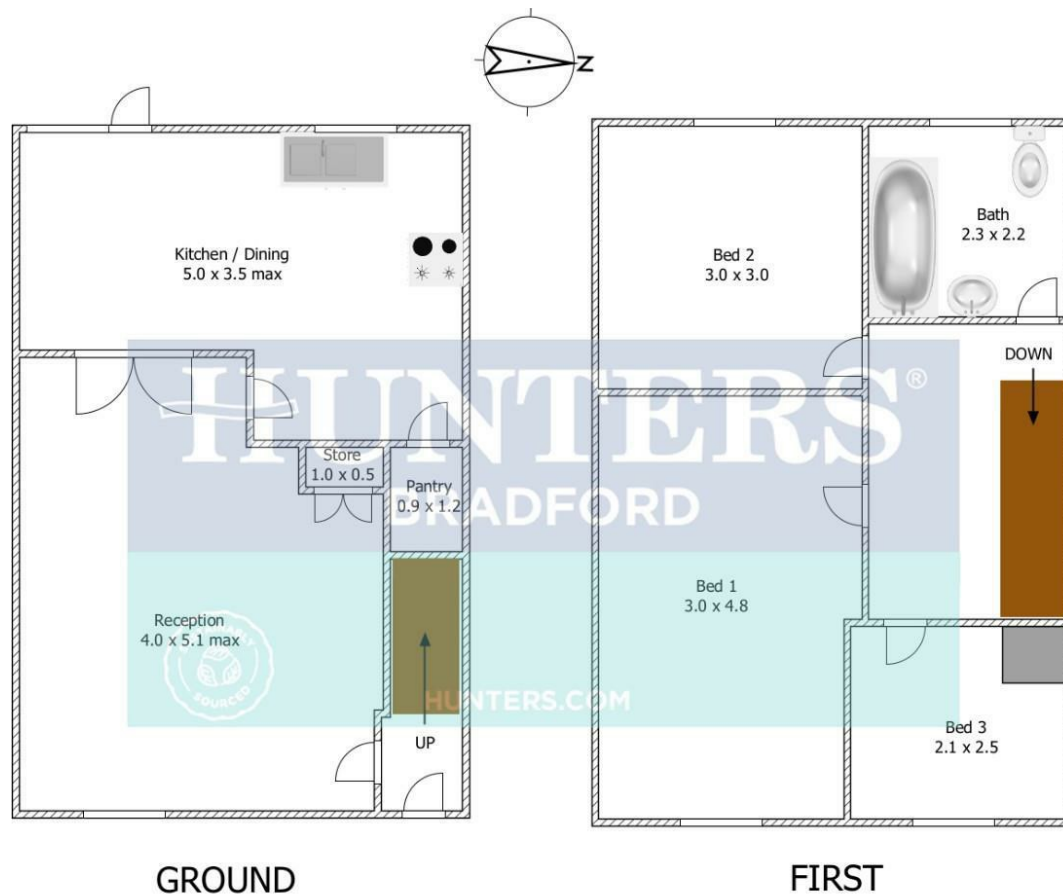

GROUND

FIRST

Whilst every attempt has been made to ensure the accuracy of the floorplan contained here, measurements of rooms and scaling of doors/windows/utilities/appliances/fitings are approximate and no responsibility will be taken for any error, omission, or misrepresentation. This plan is for illustrative purposes only and should be used as such by any prospective buyer.

(Dimensions in metres)

Viewings

Please contact bradford@hunters.com, if you wish to arrange a viewing appointment for this property or require further information.

Valuations

For a valuation of your property, please email the team with your property details, contact information and the times you are available.

ENERGY PERFORMANCE CERTIFICATE

The energy efficiency rating is a measure of the overall efficacy of a home. The higher the rating the more energy efficient the home is and the lower the fuel bills will be.

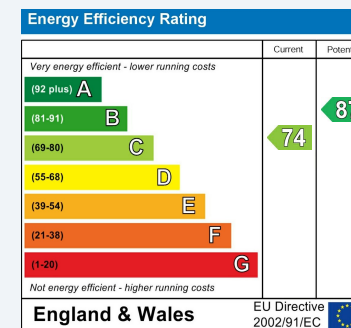

These particulars are intended to give a fair and reliable description of the property but no responsibility for any inaccuracy or error can be accepted and do not constitute an offer or contract. We have not tested any services or appliances (including central heating if fitted) referred to in these particulars and the purchasers are advised to satisfy themselves as to the working order and condition. If a property is unoccupied at any time there may be reconnection charges for any switched off/disconnected or drained services or appliances - All measurements are approximate.

THINKING OF SELLING? If you are thinking of selling your home or just curious to discover the value of your property, Hunters would be pleased to provide free, no obligation sales and marketing advice. Even if your home is outside the area covered by our local offices we can arrange a Market Appraisal through our national network of Hunters estate agents.

