



Hatcham Close, Allerton, Bradford, West Yorkshire, BD15 7UF

- INVESTORS ONLY
- CURRENTLY TENANTED AT £550 PCM
- SPACIOUS DINING KITCHEN
- DOUBLE GLAZING AND GAS CENTRAL HEATING
- COUNCIL TAX BAND C

- THREE BEDROOM SEMI-DETACHED FAMILY HOME
- WELL PRESENTED THROUGHOUT
- LARGE REAR LAWN GARDEN
- DRIVEWAY PARKING
- EPC RATING GRADE C

Offers In The Region Of £150,000

Hatcham Close, Allerton, Bradford, West Yorkshire, BD15 7UF

DESCRIPTION

HUNTERS BRADFORD PRESENTS HATCHEM CLOSE - ALLETON - BD15

Nestled in the charming Hatcham Close, Allerton, Bradford, this three-bedroom semi-detached family home is a gem waiting to be discovered by savvy investors.

Currently tenanted at £550 per calendar month, this property offers a fantastic investment opportunity.

As you step inside, you'll be greeted by a well-presented interior boasting one reception room, a spacious dining kitchen, and a convenient ground floor WC. The modern style three-piece bathroom adds a touch of elegance to this lovely home.

The property features double glazing and gas central heating, ensuring comfort and energy efficiency all year round. Outside, a large rear lawn garden provides the perfect space for outdoor relaxation or entertaining guests.

With driveway parking available, convenience is at the forefront of this property. Situated in Council Tax Band C and boasting an EPC rating of Grade C, this home is not only inviting but also practical for everyday living.

Don't miss out on the opportunity to own this wonderful property in Allerton.

Book a viewing today and envision the endless possibilities this home has to offer!





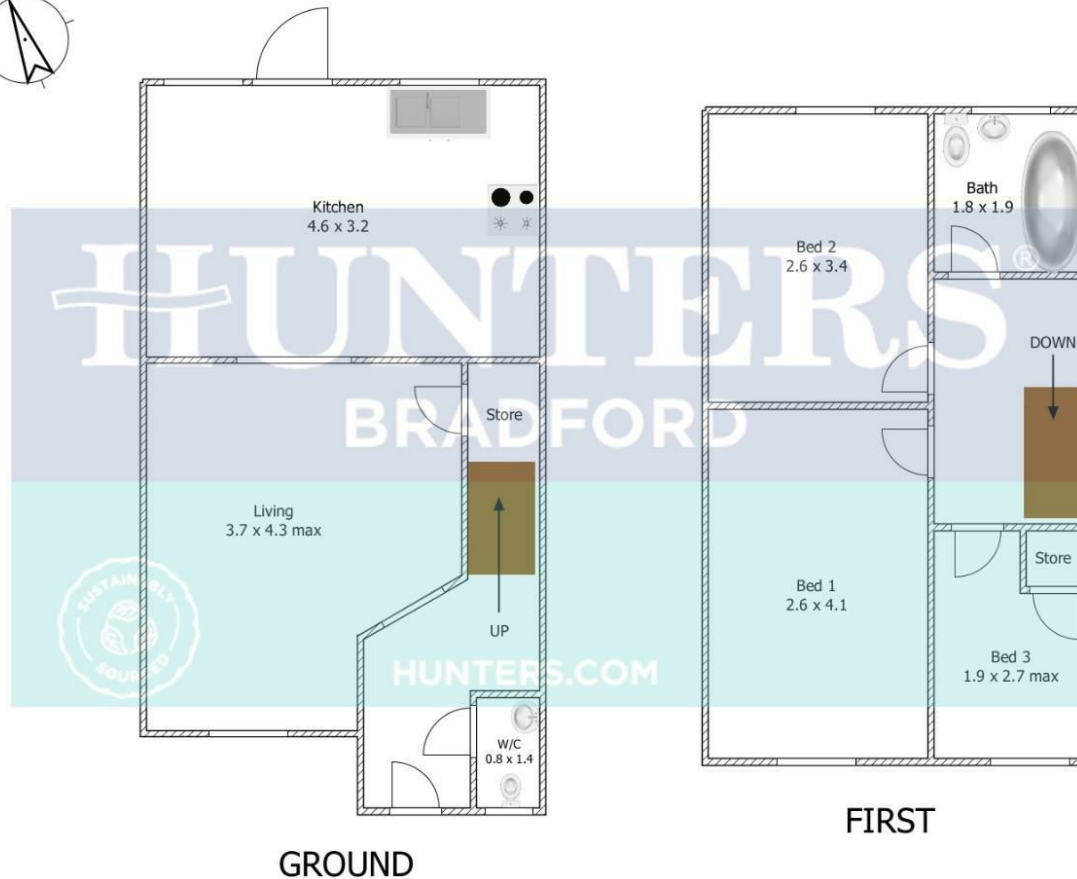

Whilst every attempt has been made to ensure the accuracy of the floorplan contained here, measurements of rooms and scaling of doors/windows/utilities/appliances/fittings are approximate and no responsibility will be taken for any error, omission, or misrepresentation. This plan is for illustrative purposes only and should be used as such by any prospective buyer.

(Dimensions in metres)

Viewings

Please contact bradford@hunters.com, if you wish to arrange a viewing appointment for this property or require further information.

Valuations

For a valuation of your property, please email the team with your property details, contact information and the times you are available.

ENERGY PERFORMANCE CERTIFICATE

The energy efficiency rating is a measure of the overall efficacy of a home. The higher the rating the more energy efficient the home is and the lower the fuel bills will be.

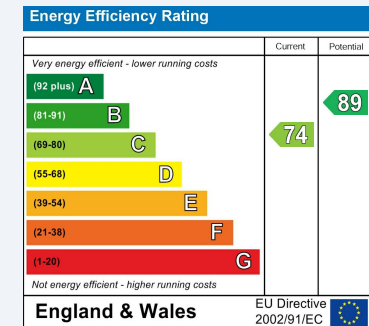

These particulars are intended to give a fair and reliable description of the property but no responsibility for any inaccuracy or error can be accepted and do not constitute an offer or contract. We have not tested any services or appliances (including central heating if fitted) referred to in these particulars and the purchasers are advised to satisfy themselves as to the working order and condition. If a property is unoccupied at any time there may be reconnection charges for any switched off/disconnected or drained services or appliances - All measurements are approximate.

THINKING OF SELLING? If you are thinking of selling your home or just curious to discover the value of your property, Hunters would be pleased to provide free, no obligation sales and marketing advice. Even if your home is outside the area covered by our local offices we can arrange a Market Appraisal through our national network of Hunters estate agents.

