



HARDINGS



Kings Road House
£1,450 PCM





A well-presented, top floor apartment, located inside Windsor's 'Golden Triangle'. Benefits include Windsor Castle views and off-street parking for one car.

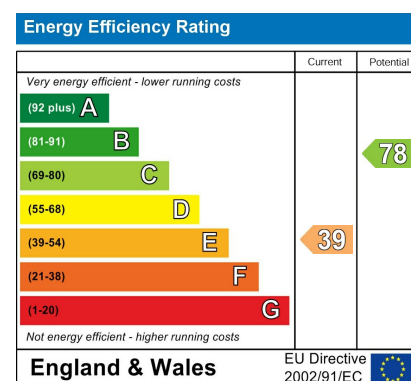

Features

- One bedroom apartment
- Castle views
- Walking distance to all amenities
- Off street parking for one car
- Top floor
- Located inside the 'Golden Triangle'
- Adjacent to The Long Walk
- Tax Band C & EPC E

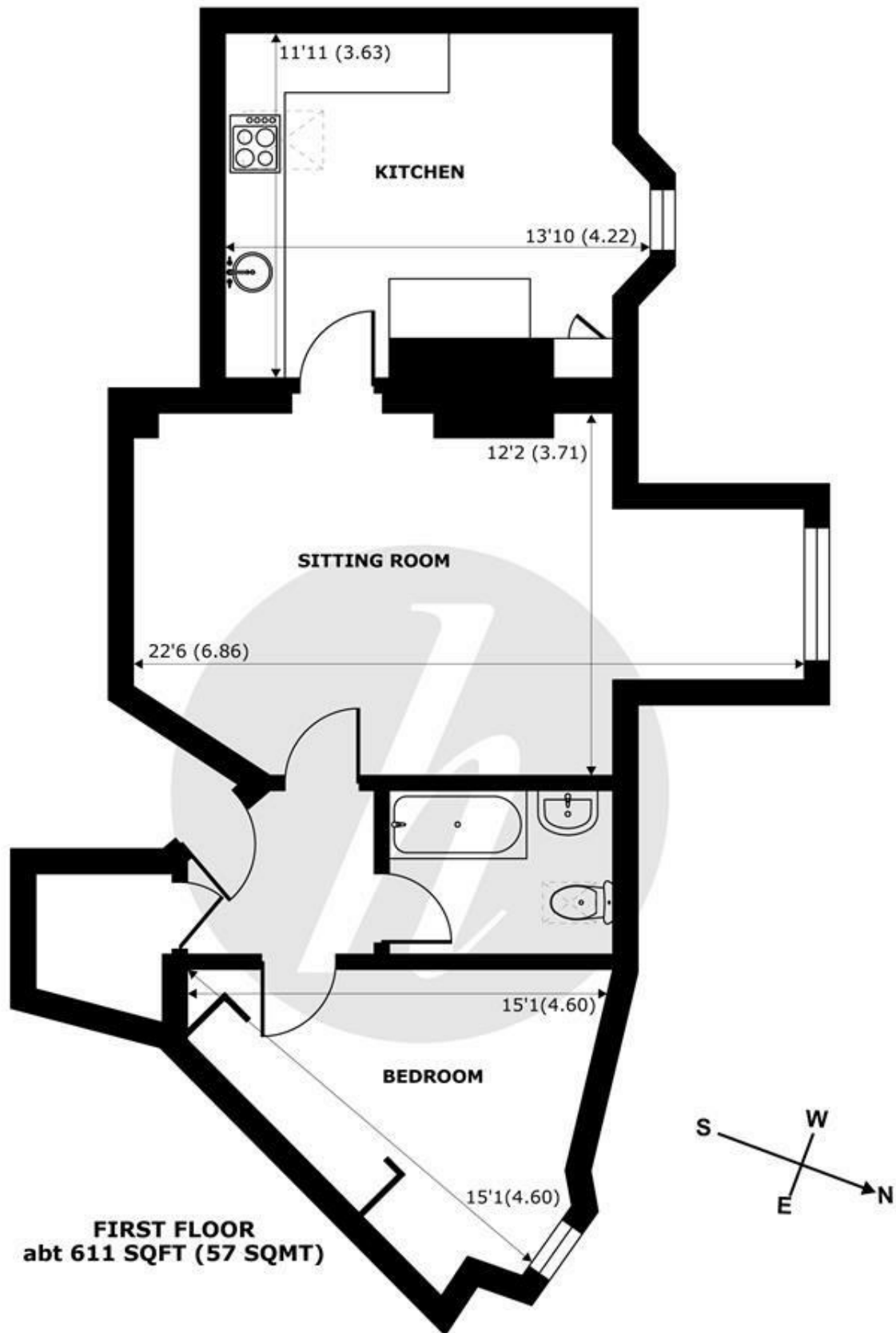

FIRST FLOOR
 abt 611 SQFT (57 SQMT)

Kings Road, Windsor, SL4

Approximate Internal Area = 611 sq ft / 57 sq m

For identification only - Not to scale



Floor plan produced in accordance with RICS Property Measurement Standards incorporating International Property Measurement Standards (IPMS2 Residential). © nichecom 2020. Produced for Hardings. REF: 664346





11 High Street, Windsor, Berkshire, SL4 1LD,
T: 01753 833 118 | E: info@hardings.co.uk
www.hardings.co.uk

