



HARDINGS



Camperdown House
Offers Over £265,000





A one bedroom apartment within a beautiful period house on Alma Road with communal garden and residents parking. With close proximity to stations, serving Waterloo and Paddington, and all town centre attractions. Further benefitting from easy and convenient for M4, M25, M40 and Heathrow Airport. The property is offered to the market chain free, and great opportunity for a first time buyer, investors or someone who wants to downsize and to live in Windsor town centre.

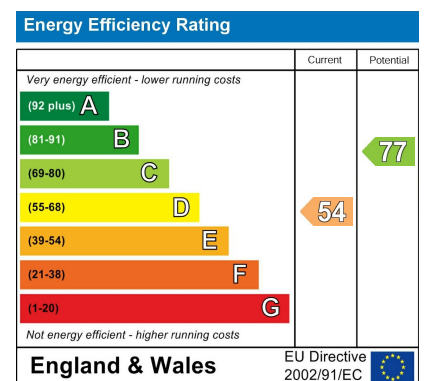

Features

- One bedroom apartment
- Beautiful period building
- Views of Attractive Communal Garden
- Tax Band C & EPC E
- No Onward Chain
- Kitchen with appliances
- Permit Parking
- Great location close to Town Centre and mainline stations
- Garage Available at Separate Negotiation

NOT TO SCALE

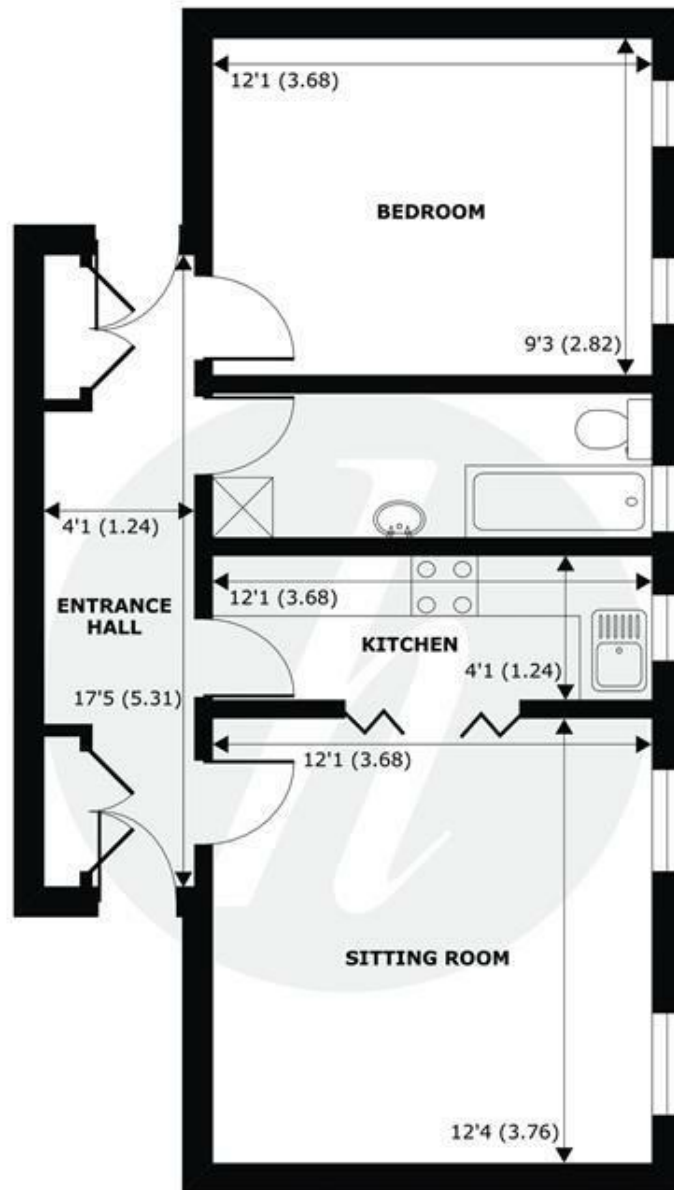

FLOOR
abt 525 SQFT (48.8 SQMT)

APPROX. GROSS INTERNAL FLOOR AREA 442 SQFT 41.1 SQM
APPROX. GROSS EXTERNAL FLOOR AREA 525 SQFT 48.8 SQM

Alma Road, Windsor, SL4



Whilst every attempt has been made to ensure the accuracy of the floor plan contained here, measurements of doors, windows and rooms are approximate and no responsibility is taken for any error, omission or misstatement. These plans are for representation purposes only as defined by RICS Code of Measuring Practice and should be used as such by any prospective purchaser. Specifically no guarantee is given on the total square footage of the property if quoted on this plan. Any figure given is for initial guidance only and should not be relied on as a basis of valuation. This floor plan was constructed using measurements provided to Niche Communications by a third party.

Copyright nichecom.co.uk 2019 Produced for Hardings ref. 562936



11 High Street, Windsor, Berkshire, SL4 1LD,
T: 01753 833 118 | E: info@hardings.co.uk
www.hardings.co.uk

